

STATE OF ALASKA
 DEPARTMENT OF NATURAL RESOURCES
 DIVISION OF PARKS
 AND
 OUTDOOR RECREATION

MOSQUITO LAKE SRS
 SANITARY IMPROVEMENTS

PROJECT NO.
 71007-2

In Cooperation with the Alaska Department of Fish and
 Game, Division of Sport Fish

Vicinity Map

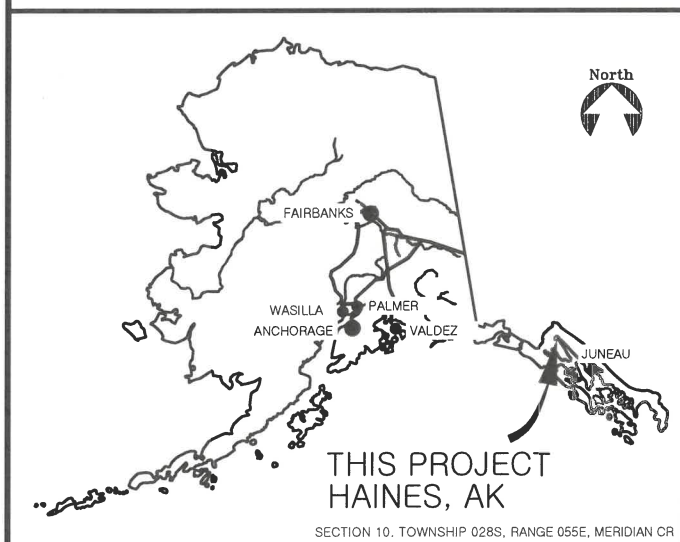

INDEX

1. TITLE SHEET
2. VICINITY MAP, ESTIMATE OF QUANTITIES, LEGEND AND ABBREVIATIONS
3. EXISTING CONDITIONS AND SITE PLAN
4. CONCRETE VAULTED TOILET SITE WORK

Plans developed by:
 STATE OF ALASKA
 Department of Natural Resources
 Division of Parks & Outdoor Recreation
 550 W 7th Ave. Suite 1340, Anchorage, AK 99501

Recommended:

Rys Miranda 5/4/2016
 Rys Miranda, P.E. Date
 Chief, Design and Construction

Approved:

Riky Gease 5/4/2016
 Riky Gease Date
 Director, Alaska State Parks

SKAGWAY,
AK

ESTIMATE OF QUANTITIES - BASIC BID			
ITEM NO.	ITEM DESCRIPTION	UNIT	QUANTITY
618.0004.0000	SEEDING	SY	100
620.0001.0000	TOPSOIL	SY	100
640.0001.0000	MOBILIZATION AND DEMOBILIZATION	L.S.	ALL REQ'D
641.0001.0000	EROSION, SEDIMENT AND POLLUTION CONTROL ADMINISTRATION	L.S.	ALL REQ'D
641.0002.0000	TEMPORARY EROSION, SEDIMENT AND POLLUTION CONTROL	C.S.	ALL REQ'D
641.0006.0000	ESCP PRICE ADJUSTMENT	C.S.	ALL REQ'D
643.0002.0000	TRAFFIC MAINTENANCE	L.S.	ALL REQ'D
647.2006.0000	HYDRAULIC EXCAVATOR, 1 C.Y., 100HP, MIN.	HOUR	5
654.2001.0000	SINGLE VAULTED TOILET	EACH	1

LEGEND		
EXISTING	PROPOSED	
		EDGE OF VEGETATION
		EDGE OF WATER
		MAJOR CONTOUR LINE
		MINOR CONTOUR LINE
		EDGE OF GRAVEL ROAD/PARKING
		LIMIT OF FILL SLOPE
		LIMIT OF CUT SLOPE
		SURVEY CONTROL MONUMENT
		SIGN
		TOPSOIL AND SEED

ABBREVIATIONS AND SYMBOLS

φ	DIAMETER
ε	CENTERLINE
C.S.	CONTINGENT SUM
DNR	DEPARTMENT OF NATURAL RESOURCES
E	EAST
ELEV.	ELEVATION
F.G.	FINISH GRADE
HWY	HIGHWAY
INV	INVERT
L.S.	LUMP SUM
LB/LBS	POUND/POUNDS
M.E.	MATCH EXISTING
MP	MILEPOST
N	NORTH
NE	NORTHEAST
NO.	NUMBER
NW	NORTHWEST
PIP	PROTECT IN PLACE
REQ'D	REQUIRED
SE	SOUTHEAST
S.F.	SQUARE FOOT
SW	SOUTHWEST
S.Y.	SQUARE YARD
TYP	TYPICAL
W	WEST

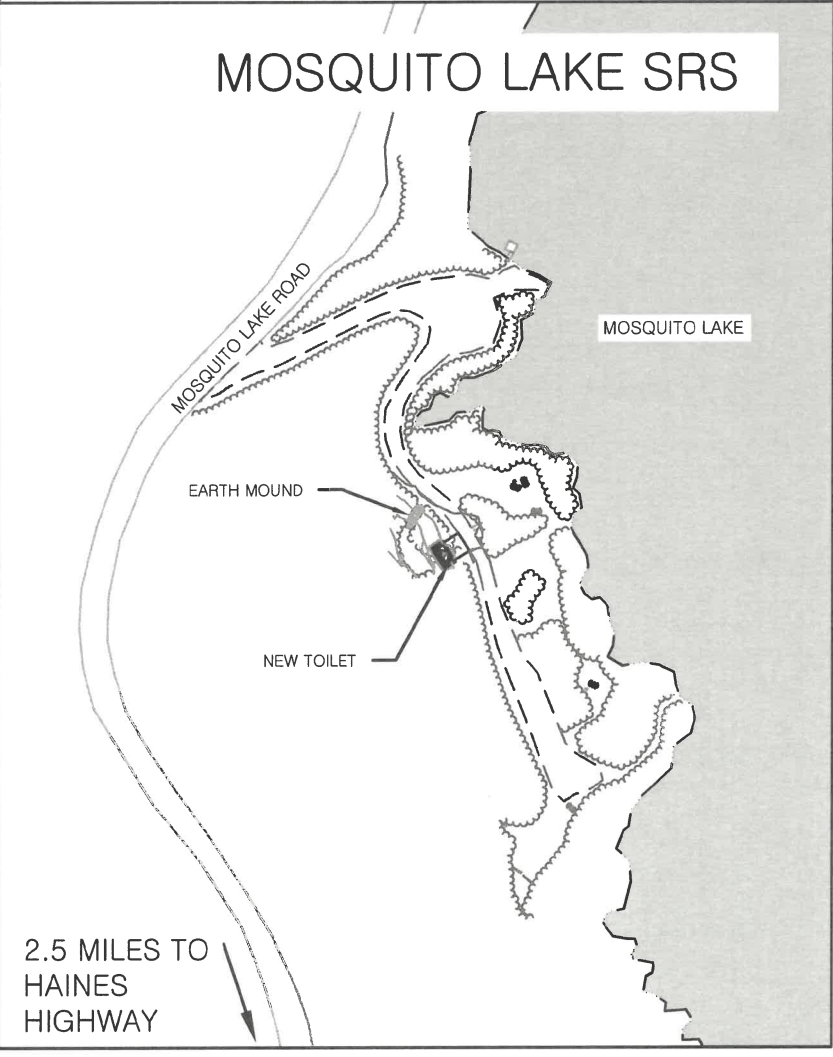
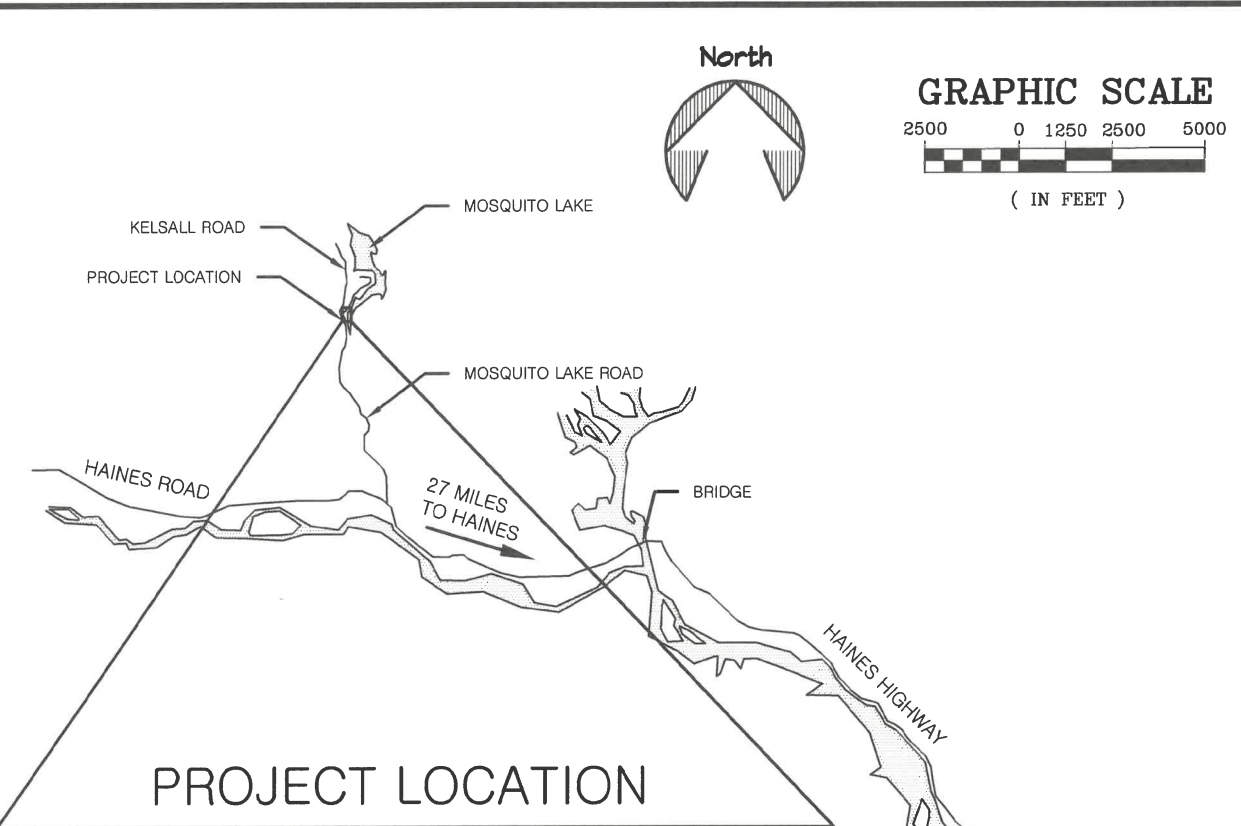

HAINES, AK

STATE OF ALASKA, DEPARTMENT OF NATURAL RESOURCES
 PLANS DEVELOPED BY: DIVISION OF PARKS AND OUTDOOR RECREATION
 550 W 7TH AVE. SUITE 1340, ANCHORAGE, AK 99501 - 907.269.8731

MOSQUITO LAKE SRS
 SANITARY IMPROVEMENTS
 PROJECT NO. 71007-2

VICINITY MAP, ESTIMATE OF QUANTITIES,
 LEGEND, AND ABBREVIATIONS



PREPARED: AWH
 DRAWN: AWH
 REVIEWED: RCS
 DATE: APRIL 2026

SHEET
2
 OF 4 SHEETS

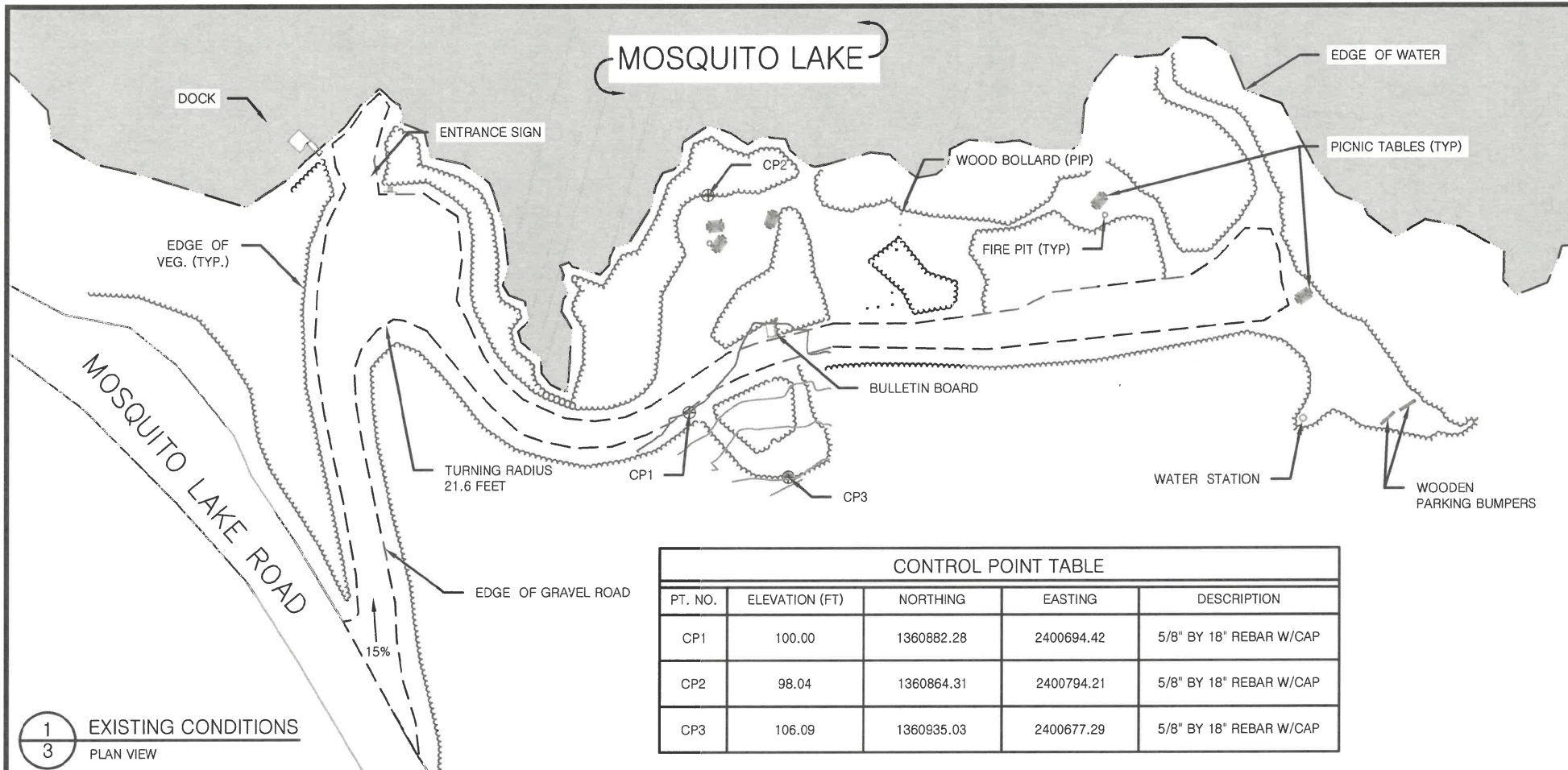

1
3
EXISTING CONDITIONS
PLAN VIEW

CONTROL POINT TABLE				
PT. NO.	ELEVATION (FT)	NORTHING	EASTING	DESCRIPTION
CP1	100.00	1360882.28	2400694.42	5/8" BY 18" REBAR W/CAP
CP2	98.04	1360864.31	2400794.21	5/8" BY 18" REBAR W/CAP
CP3	106.09	1360935.03	2400677.29	5/8" BY 18" REBAR W/CAP

POINT TABLE				
PT. NO.	ELEVATION (FT)	NORTHING	EASTING	DESCRIPTION
PT1	101.80	1360936.42	2400720.86	CORNER OF CONCRETE PAD
PT2	101.80	1360924.13	2400712.93	CORNER OF CONCRETE PAD
PT3	101.80	1360927.65	2400707.47	CORNER OF CONCRETE PAD
PT4	101.80	1360939.94	2400715.39	CORNER OF CONCRETE PAD

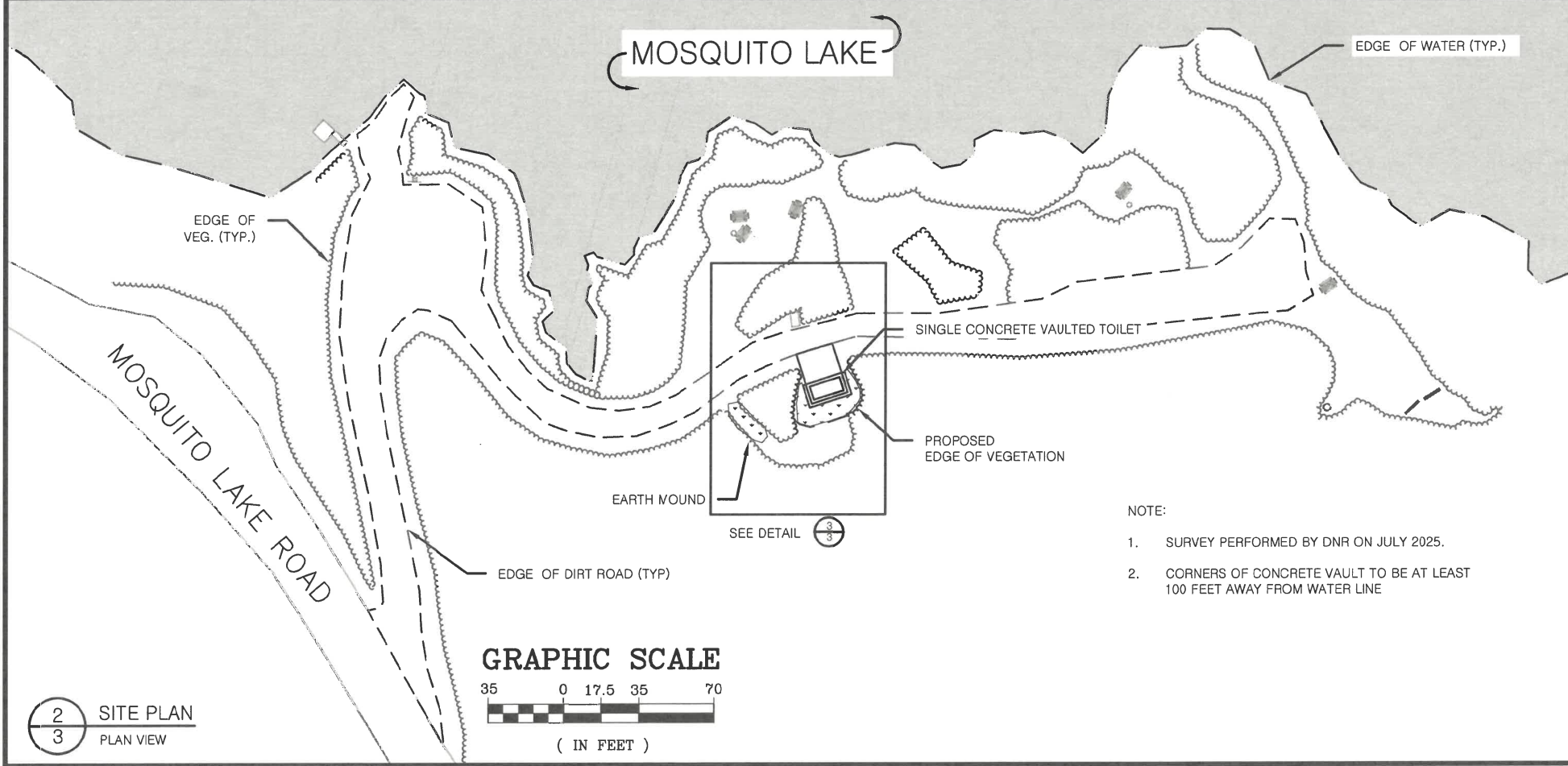

2
3
SITE PLAN
PLAN VIEW

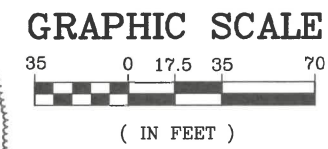

- NOTE:
1. SURVEY PERFORMED BY DNR ON JULY 2025.
 2. CORNERS OF CONCRETE VAULT TO BE AT LEAST 100 FEET AWAY FROM WATER LINE

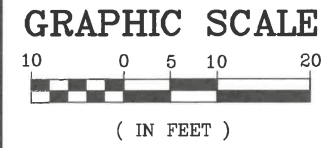
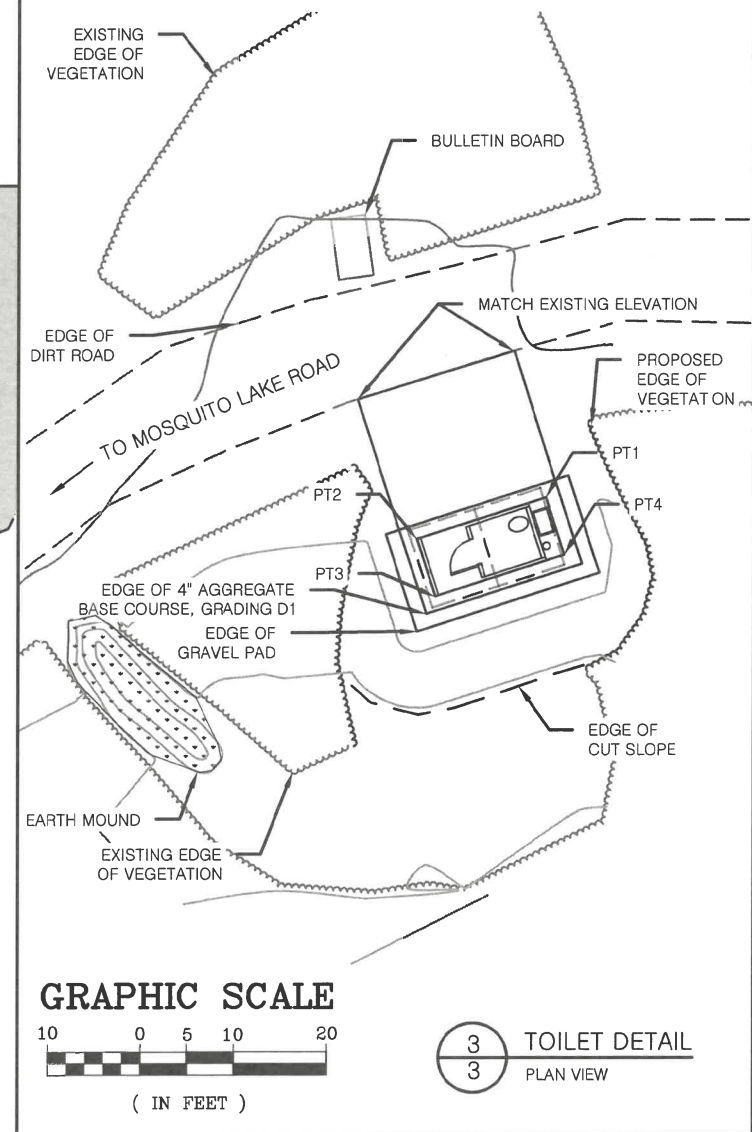

3
3
TOILET DETAIL
PLAN VIEW

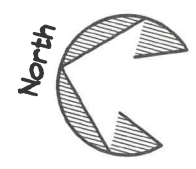

STATE OF ALASKA, DEPARTMENT OF NATURAL RESOURCES
 PLANS DEVELOPED BY: DIVISION OF PARKS AND OUTDOOR RECREATION
 550 W 7TH AVE. SUITE 1340, ANCHORAGE, AK 99501 - 907.269.8731

MOSQUITO LAKE SRS
 SANITARY IMPROVEMENTS
 PROJECT NO. 91007-2

EXISTING CONDITIONS AND SITE PLAN



PREPARED: AWH
 DRAWN: AWH
 REVIEWED: RCS
 DATE: APRIL 2026

SHEET
3
 OF 4 SHEETS

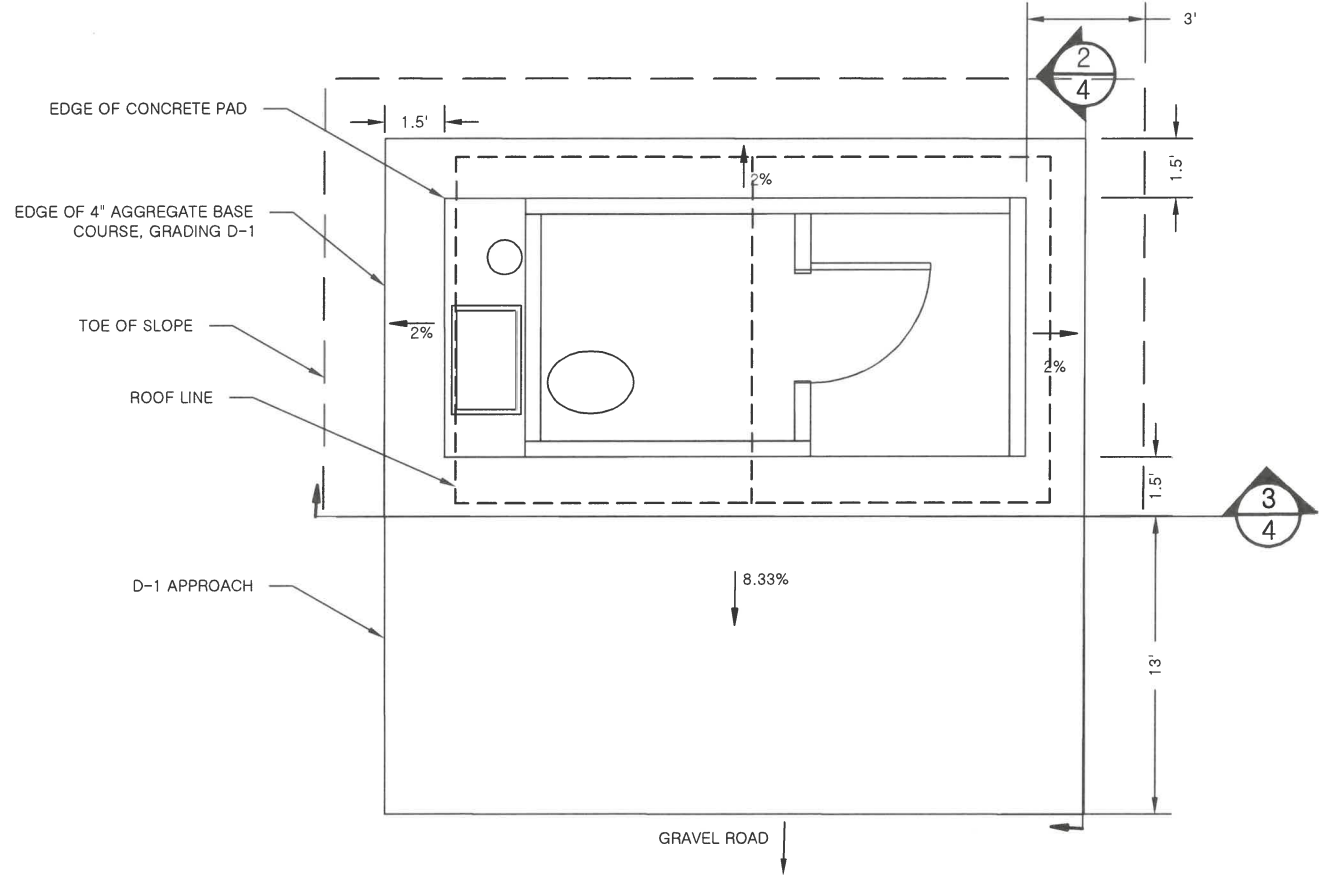

1
4 CONCRETE VAULTED TOILET
TYPICAL PLAN

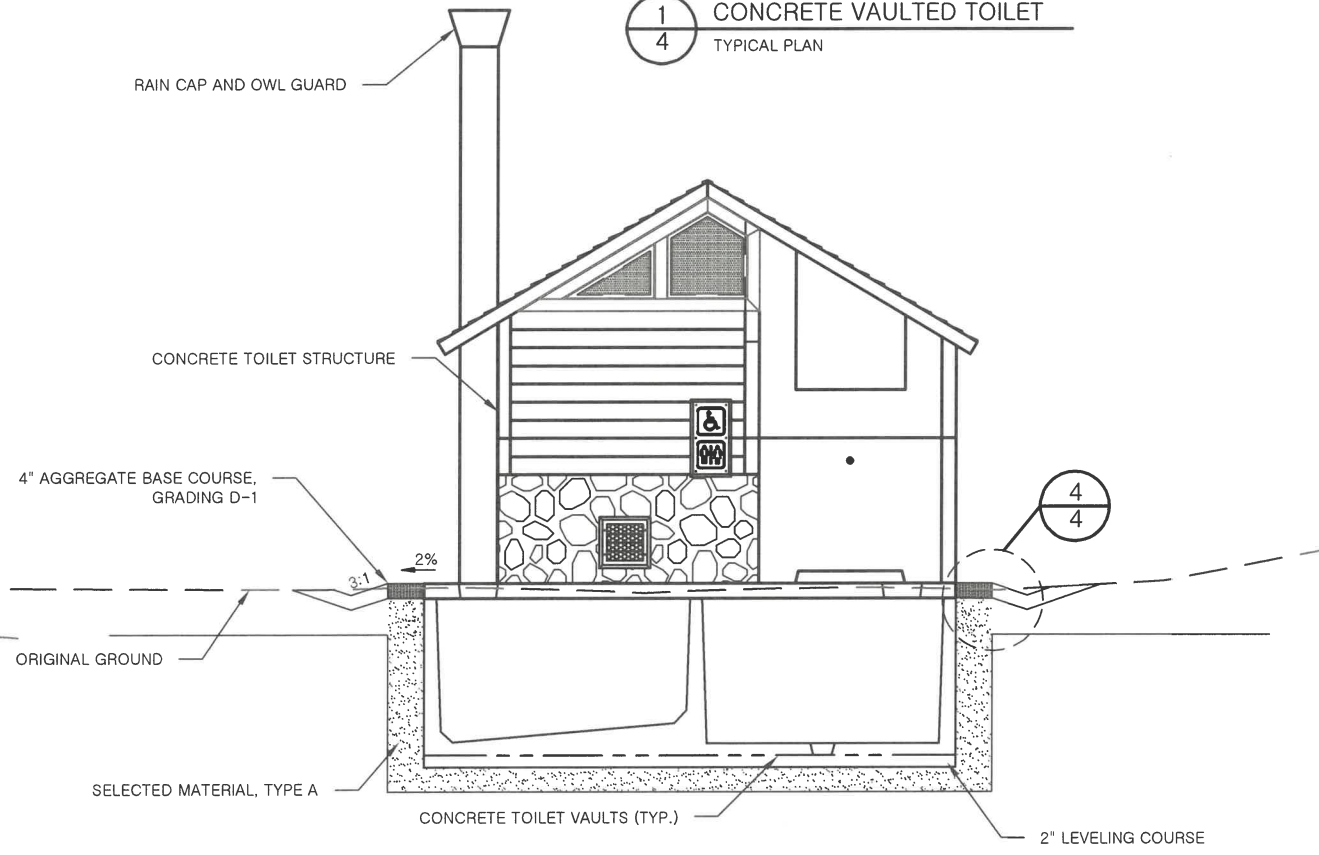

3
4 CONCRETE VAULTED TOILET
FRONT VIEW

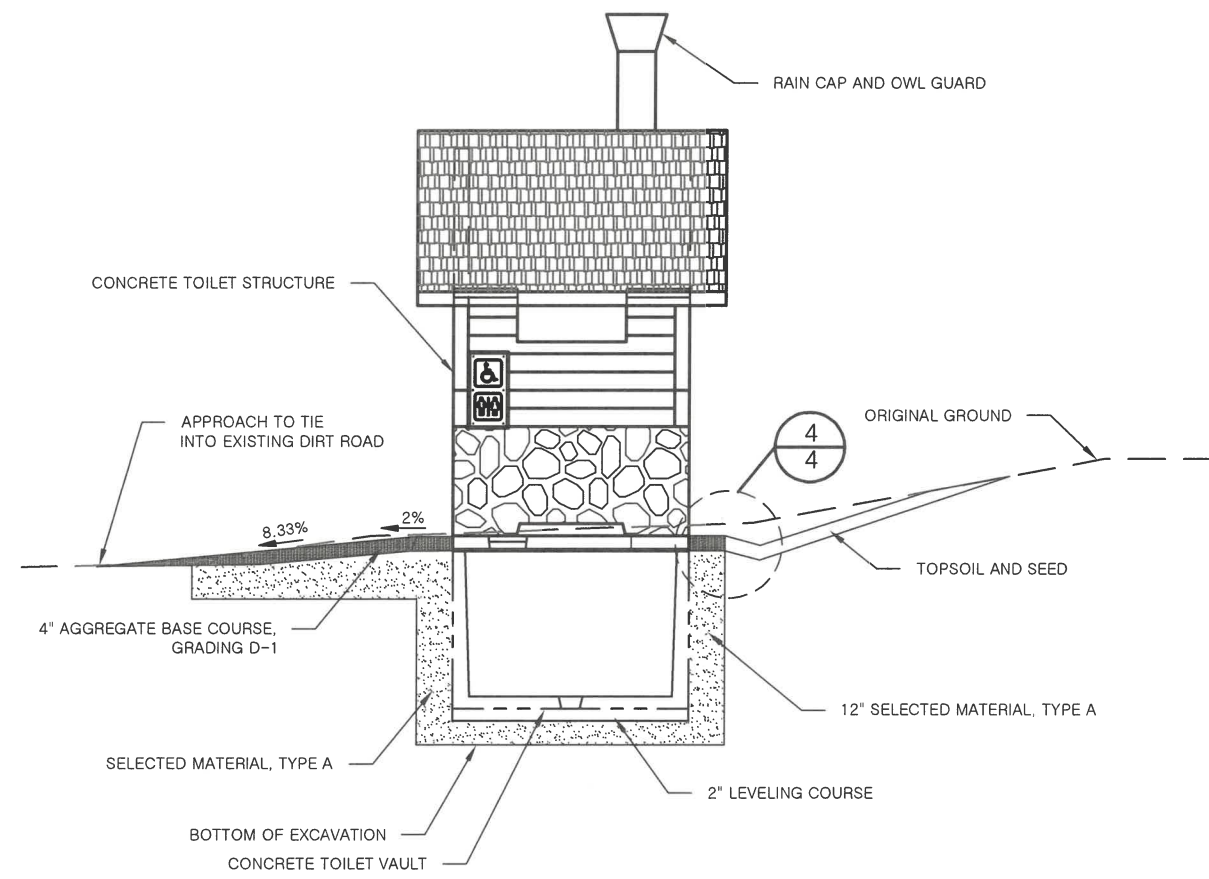

2
4 CONCRETE VAULTED TOILET
PROFILE VIEW

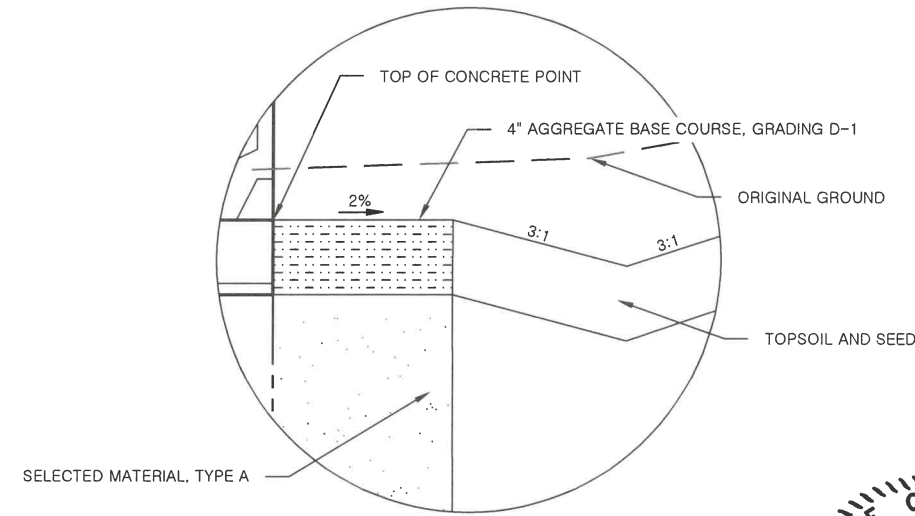

4
4 CONCRETE VAULTED TOILET
CORNER DETAILS



STATE OF ALASKA, DEPARTMENT OF NATURAL RESOURCES
 PLANS DEVELOPED BY: DIVISION OF PARKS AND OUTDOOR RECREATION
 550 W 7TH AVE. SUITE 1340, ANCHORAGE, AK 99501 - 907.269.8731

MOSQUITO LAKE SRS
 SANITARY IMPROVEMENTS
 PROJECT NO. 91007-2

CONCRETE VAULTED TOILET SITE WORK



PREPARED: AWH
 DRAWN: AWH
 REVIEWED: RCS
 DATE: APRIL 2026

SHEET
 4
 OF 4 SHEETS