

## **MANAGEMENT UNIT 4: North of Glenn Highway Near Snowshoe Lake**

### **Background**

This management unit consists of state-owned land north of the Glenn Highway near Snowshoe Lake. The Nelchina Public Use Area and Slide Mountain are west of the unit. A trail along the west shore of Snowshoe Lake provides access to Slide Mountain, an area with paleontological artifacts and fossils and splendid views from the top. Summer access through much of the area is difficult as most of the land is wet and swampy.

### **Management Intent**

The southern part of the area (subunit 4A) will be retained in state ownership for multiple use, with emphasis on wildlife habitat. Old Man Lake will be managed as a wilderness lake and Snowshoe Lake as a recreation lake (see p. 2-41). Management subunit 4B will also be retained in public ownership for multiple use with seasonal restrictions on certain activities to protect trumpeter swans. The entire area is open to mineral entry.

In addition to the management intent for the entire unit, the following applies to specific subunits:

**Subunit 4B.** This subunit is an important swan nesting habitat. The area will be managed to protect nesting habitat and to require land uses be managed to minimize disturbance to swans.

### **Management Guidelines**

**Trumpeter Swans.** The guidelines for Documented High Value Trumpeter Swan Nesting and Concentration Areas (p. 2-10) apply to subunit 4B. The Alaska Legislature should consider designating the trumpeter swan habitat as a Critical Habitat Area to retain the land in public ownership and provide greater long term protection to the trumpeter swans.

The complete set of management guidelines is presented in Chapter 2. Any of the guidelines could apply to uses within this management unit; however, guidelines that are most likely to apply are:

- Fish and wildlife habitat
- Lakeshore management
- Public access

# LAND USE DESIGNATION SUMMARY

## MANAGEMENT UNIT: 4 - North of Glenn Highway/ Snowshoe Lake

SUBUNIT	LAND OWNERSHIP (GENERALIZED)	LAND USE DESIGNATIONS				PROHIBITED SURFACE USE(S)*	COMMENTS
		SURFACE		SUBSURFACE			
		PRIMARY USE(S)	SECONDARY USE(S)	LOCATABLE MINERALS	LEASEABLE MINERALS		
4A	State	Wildlife habitat	Forestry Public recreation	Open to mineral entry	Available for leasing	Land offerings, Remote cabins	
4B	State	Wildlife habitat		Open to mineral entry	Available for leasing	Grazing, Most land leases,* <sup>2</sup> Land offerings, Remote cabins	Swan management guidelines apply

\*<sup>1</sup> Other uses such as material sales, land leases, or permits, that are not specifically prohibited may be allowed. Such uses will be allowed if consistent with the management intent statement, the management guidelines of this unit, and the relevant management guidelines listed in Chapter 2.

\*<sup>2</sup> See management guidelines, page 2-10.

3-28

ACE 6329436

# RESOURCE INFORMATION SUMMARY

## Management Unit 4 - North of Glenn Highway - Snowshoe Lake

RESOURCE	SUBUNIT'	
	4A	4B
Fish	salmon - s	salmon - s
Forestry	moderate conif.	unsuitable
Historic-Cultural	unknown	unknown
Minerals	outside of known mineral terranes	outside of known mineral terranes
Oil and Gas	low	low
Recreation	moderate; some small lakes	low
Sand and Gravel	existing site and potential area	none identified
Settlement Suitability	low; unsuitable	low
Transportation	Glenn Hwy., floatplanes on Snowshoe Lake	none identified
Wildlife	A-2 habitat moose	A-1 habitat - trumpeter swan, moose

### Important Trails:

Subunit 4A: Two trails from Glenn Hwy. near Snowshoe Lake (may cross private land) north towards Nelchina Public Use Area

One trail from Glenn Hwy. east of Snowshoe Lake north towards Nickel Lake

Subunit 4B: Trail running east-west, from southern boundary of the state land disposal project near Loon Lake west towards Mendeltna Springs.

For definitions of ratings, see glossary. For more detailed information on any resources, see resource elements published under separate cover.

# MANAGEMENT UNIT 4

## North of Glenn Highway - Snowshoe Lake

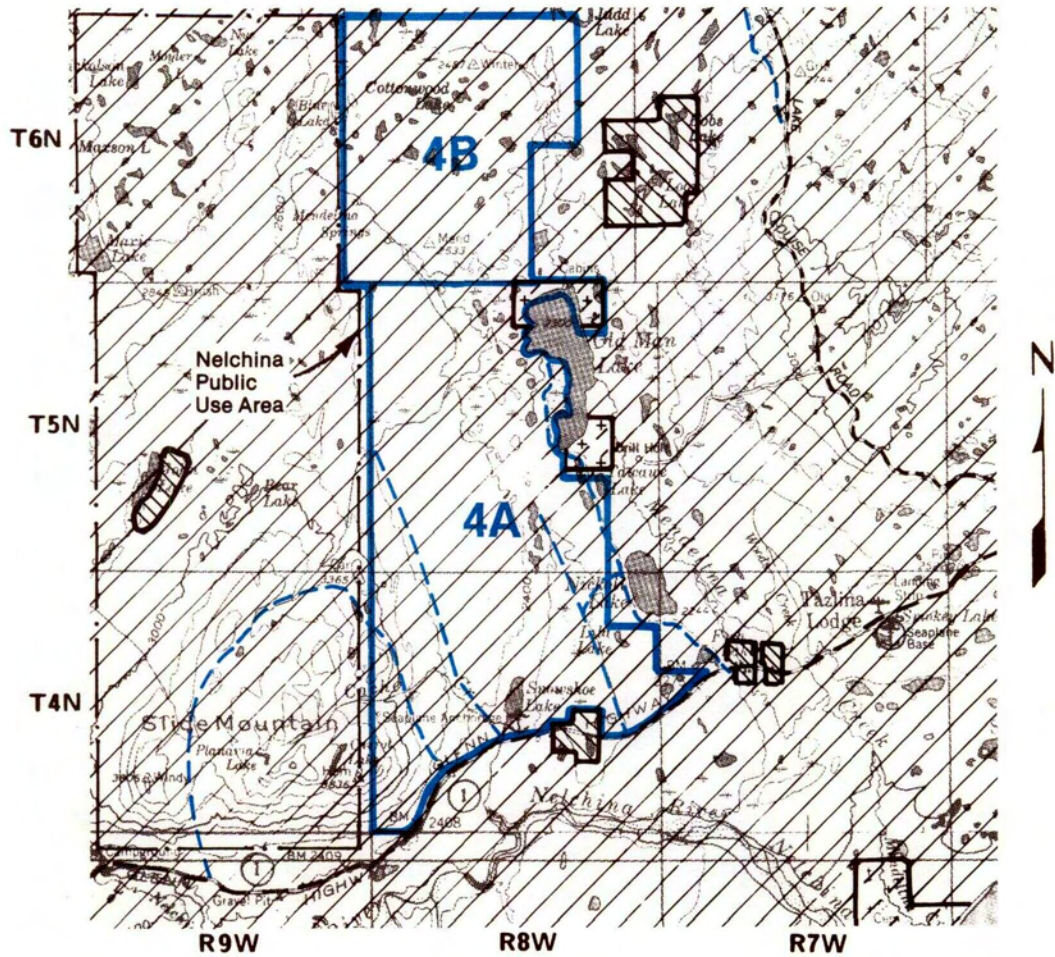

Location Map

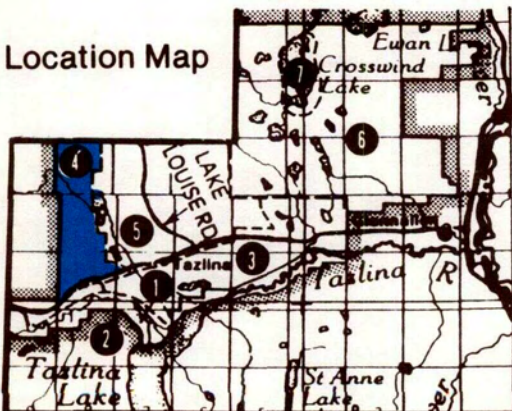

U.S.G.S. Quads:  
Gulkana  
Valdez

Map scale:  
1:250,000

-  State Owned
-  State Selected
-  Native/Private Owned
-  Native Selected
-  Federal
-  Trails on public lands

Map shows approximate location of easements to state land and major trails across state land. Portions of trails may cross private lands. See appendix D.