



William Groom
Department of Natural Resources
3700 Airport Way
Fairbanks, AK 99709
william.groom@alaska.gov

May 14, 2026

RE: Kensington Mine Comet Water Treatment Plant Outfall Upgrade Reclamation Estimate

Dear Mr. Groom,

As mentioned in previous conversations, to facilitate increased treatment rates, Coeur Alaska plans to construct a riprap energy dissipation plunge pool for the Comet Mine Water Treatment Plant discharge into Sherman Creek. In addition to the riprap plunge pool the widening of an existing path and new switchback for the path are required so equipment can be safely located near Sherman Creek to construct the plunge pool. Four 8-inch HDPE discharge pipes will be extended down the bluff to the plunge pool. Please see the attached map with the location of the path and plunge pool. The path will be constructed with waste rock and a gravel cap. The plunge pool will also be constructed using waste rock.

At mine closure the path will be scarified then capped with topsoil and seeded with a native seed mix according to the Kensington Mine Reclamation and Closure Plan. To enhance bank stabilization, the riprap plunge pool will stay in place at closure. The path and plunge pool reclamation will be incorporated into the next reclamation plan update which occurs in April 2028. The estimated reclamation costs with contingencies and inflation are \$40,652, please see attached table for the detailed costs. These costs will be added to the reclamation bond at the next bond update.

Should you have any questions, please do not hesitate to contact me via phone at 907 723.2812, or by email at pstrow@coeur.com.

Sincerely,

A handwritten signature in black ink that reads "Peter Strow".

Peter Strow
Environmental Manager

Electronic Copy Furnished:
Kate Harper, ADNR
Scott Leslie, Forest Service

2026 Addition to Comet Footpath to Sherman Creek and Riprap Pool (POA1 Amendment under Parcel 6 - additional reclamation tasks)							Estimated Unit	Estimated Cost
Parcel	Task	Description	Units	Quantity	Cost US\$	US\$		
6	Comet Growth Media Stockpile							
	6.10	Demolition/Salvage						
	6.12	Remove Comet WTP Outfall 001 Piping	DAY	0.5	\$8,165	\$4,082		
	6.20	Earthworks						
	6.23B	Load, Haul, and Dump Growth Media on Footpath and Riprap Pool	DAY	2.0	\$5,025	\$10,051		
	6.24B	Soil Placement/ Spreading of Footpath and Riprap Pool	DAY	1.25	\$5,786	\$7,233		
	6.30	Seeding and Planting						
	6.31B	Seed, Mulch, and Fertilize	AC	0.072	\$8,728	\$628		
	6.32	Install Compost Logs to Control Erosion	LF	70	\$8.00	\$560		
	6.33	Install and Remove Silt Fence to Control Erosion	LF	70	\$6.78	\$474		
					Subtotal Parcel 6 2026 Amendment		\$23,028	
					Total Direct Cost		\$23,028	
					Indirect Cost	Percent		
					Contractor Profit	10.0%	\$2,303	
					Contractor Overhead	8.0%	\$1,842	
					Performance Bond	1.5%	\$345	
					Payment Bond	1.5%	\$345	
					Liability Insurance (% of labor cost)	1.5%	\$345	
					Contract Administration	7.0%	\$1,612	
					Engineer Redesign	5.0%	\$1,151	
					Scope Contingency	8.0%	\$1,842	
					Bid Contingency	4.0%	\$921	
					Subtotal Indirect Cost		\$10,708	
					Total With Contingency and Indirect Costs		\$33,736	
						Inflation Cost		
					Term (yrs)	Rate (%)		
					Compounded 5 Year Inflation (Previous 5 yr Average % Change ANC CPI)	5	3.8	
							\$6,916	
					Total With Inflation Cost		\$40,652	

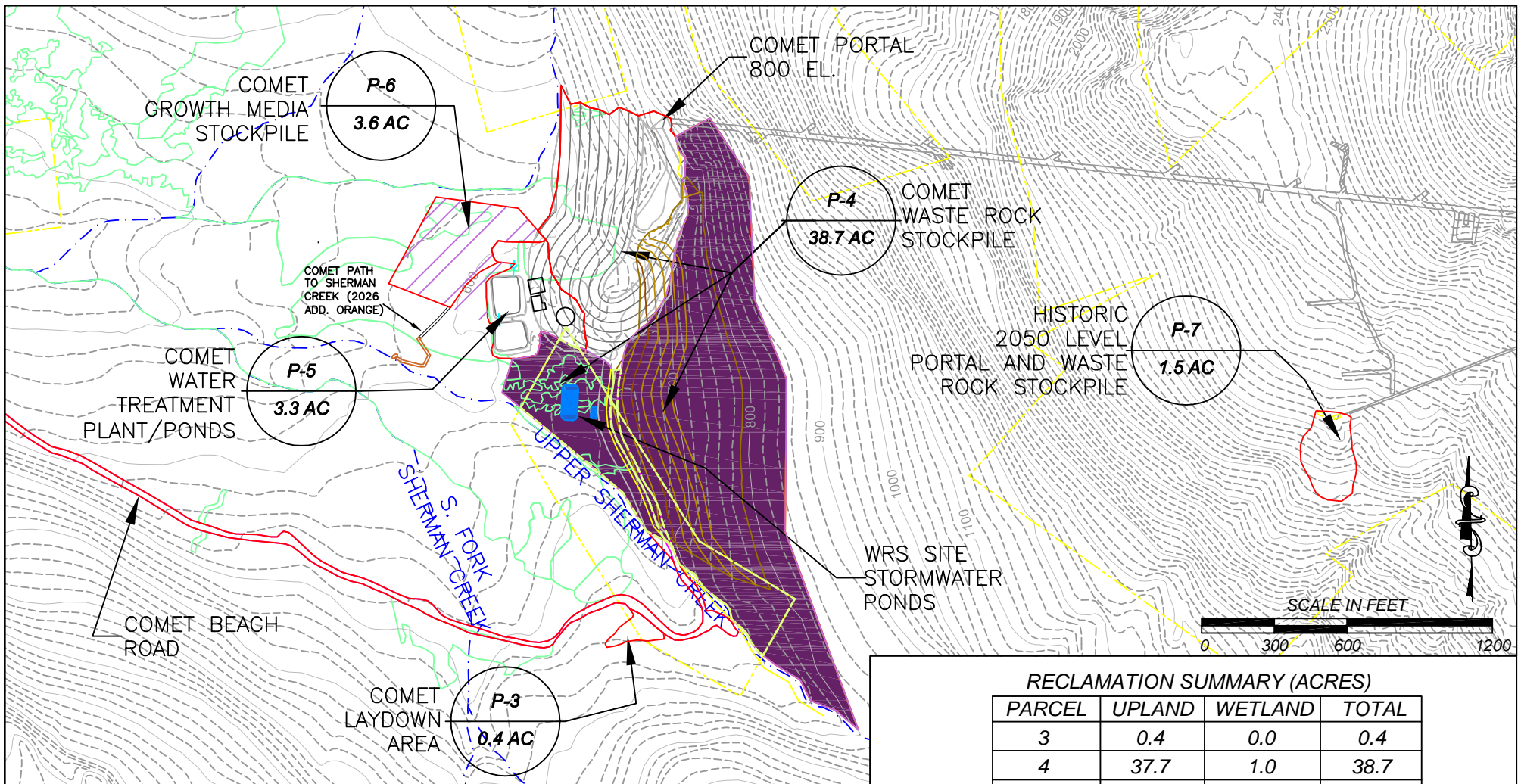

RECLAMATION SUMMARY (ACRES)

PARCEL	UPLAND	WETLAND	TOTAL
3	0.4	0.0	0.4
4	37.7	1.0	38.7
5	1.5	1.8	3.3
6	0.0	3.6	3.6
7	0.0	0.0	0.0

- COMET WRS EXPANSION AREA CONTOURS
- PARCEL BOUNDARY
- 100 FT CONTOUR LINE
- COASTLINE
- UNPATENTED CLAIM BOUNDARY
- PATENTED CLAIM BOUNDARY
- WETLAND
- WETLAND MOSAIC
- UPLAND
- EXPANSION AREA



CLIENT/PROJECT
COUER ALASKA INC. KENSINGTON PROJECT

COMET AREA
PARCELS 3, 4, 5, & 7

