

BASIS OF COORDINATES:
 R10: FOUND 1 1/2" ALUMINUM CAP ON 5/8" REBAR
 NAD 83 (2011):
 LAT. N 65°02'26.12612"
 LON. W 147°40'41.25255"
 SPCS ALASKA ZONE 3 (US SURVEY FOOT):
 N. 4038295.84'
 E. 1381128.66'

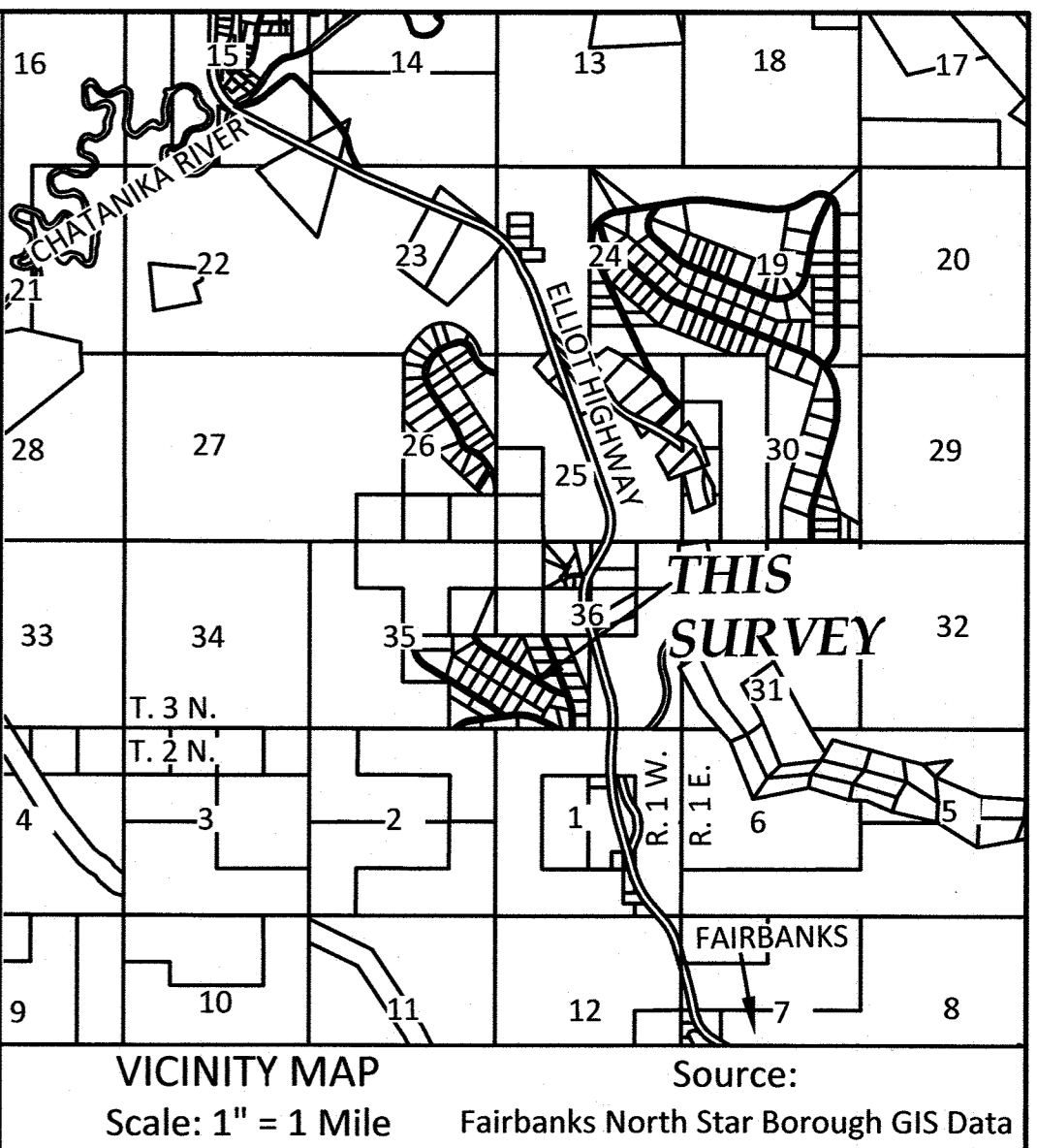

- LEGEND**
- ⊕ FOUND PRIMARY MONUMENT-3/4" DIA. ALUM. CAP ON 2 1/2" DIA. ALUM. POST WITH MAGNET UNLESS OTHERWISE NOTED
 - SECONDARY MONUMENT RECOVERED
 - EASEMENT
 - SURVEYED
 - - - UNSURVEYED
 - - - SECTION LINE
 - - - TANANA VALLEY RAILROAD HISTORIC RAILROAD CENTERLINE
 - (R) (REC) RECORD PER PLAT NO. 81-142 FAIRBANKS RECORDING DISTRICT
 - (R4) RECOVERED MONUMENT IDENTIFIER
 - (C1) CURVE IDENTIFIER
 - L1 LINE IDENTIFIER
 - ////// TANANA VALLEY RAILROAD RIGHT OF WAY

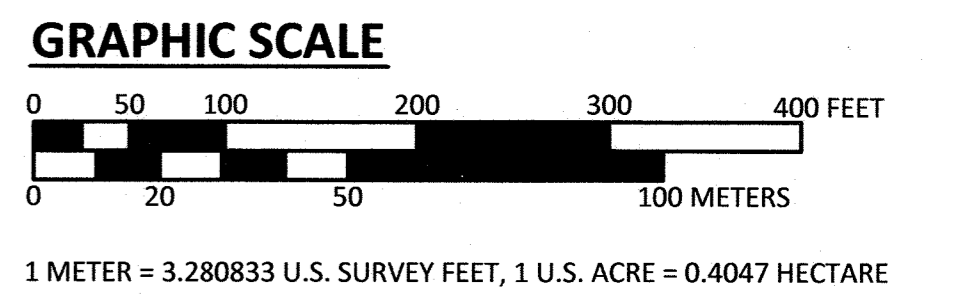

NOTES

1. THE PURPOSE OF THIS SURVEY IS TO SHOW THE TRUE LOCATION OF THE RAIL BED OF THE HISTORICAL TANANA VALLEY RAILROAD AND TO DEPICT HOW ITS ACTUAL POSITION ON THE GROUND RELATES TO THE VAULT SUBDIVISION (ASLS 80-189, PLAT 81-142 FAIRBANKS RECORDING DISTRICT). ON OCTOBER 9TH, 2023, THE RAIL BED WAS SURVEYED UTILIZING GNSS RTK SURVEY METHODS BY ESTABLISHING THE POSITION OF CENTERLINE APPROXIMATELY EVERY 100'. IT IS DEPICTED HERE WITH A 200' EASEMENT.
2. THIS SURVEY DOES NOT CONSTITUTE A SUBDIVISION AS DEFINED BY AS 40.15.900(5)(A).
3. THE ERROR OF CLOSURE OF THIS SURVEY DOES NOT EXCEED 1:5000, AND/OR CORNER POSITIONS HAVE A RELATIVE POSITION ACCURACY AT THE 95 PERCENT CONFIDENCE LEVEL OF 0.13 FEET PLUS 100 PPM.
4. ALL PARCELS OF LAND OWNED BY THE STATE OF ALASKA, LOCATED WITHIN 50.00 FEET OF, OR BISECTED BY A SURVEYED OR PROTRACTED SECTION LINE, ARE SUBJECT TO A 50 FOOT (50') EASEMENT, ON EACH SIDE OF THE SECTION LINE, WHICH IS RESERVED TO THE STATE OF ALASKA FOR PUBLIC HIGHWAYS UNDER A.S.19.10.010.
5. BEARINGS AND DISTANCES ARE BASED ON A HIGH PRECISION GLOBAL NAVIGATION SATELLITE SYSTEM SURVEY IN THE NAD 83(2011) DATUM, USING TRIMBLE R12 & R12I RECEIVERS, DIFFERENTIALLY CORRECTED AND PROCESSED USING TRIMBLE BUSINESS CENTER, VERSION 2023.10 SOFTWARE. ALL BEARINGS SHOWN ARE TRUE BEARINGS AS ORIENTED TO THE BASIS OF BEARING AND DISTANCES SHOWN ARE HORIZONTAL GROUND DISTANCES. ALASKA ZONE 3 STATE PLANE GRID DISTANCES WERE MULTIPLIED BY A COMBINED SCALE FACTOR OF 1.0000784762 TO COMPUTE GROUND DISTANCES.
6. THE BASIS OF COORDINATES AS SHOWN AT MONUMENT R10 IS BASED ON TIES TO OFF-SITE CONTROL THAT WAS CONSTRAINED TO THE NATIONAL SPATIAL REFERENCE SYSTEM USING CORS STATIONS "CLGO", "GCGO", AND "EIL3."
7. THE SHOWN (R) RECORD DISTANCES FROM PLAT 81-142 FAIRBANKS RECORDING DISTRICT ARE GROUND DISTANCES.
8. DNR'S PUBLIC ACCESS ASSERTION AND DEFENSE (PAAD) UNIT HAS DETERMINED THAT THE RS 2477 TRAIL SERIALIZED AS RST 224 IS COINCIDENT WITH THE LOCATION OF VAULT DRIVE AS DEDICATED ON PLAT No. 81-142 AND AS SHOWN ON THIS PLAT. THE PURPOSE OF THIS NOTE IS TO DOCUMENT THE FACT THAT THE VAULT DRIVE RIGHT OF WAY DEDICATED ON THAT PLAT IS A SEPARATE (BUT OVERLAPPING) INTEREST FROM THE RS 2477 INTEREST ASSERTED BY DNR.

SURVEYOR'S CERTIFICATE

I HEREBY CERTIFY THAT I AM PROPERLY REGISTERED AND LICENSED TO PRACTICE LAND SURVEYING IN THE STATE OF ALASKA. THAT THIS PLAT REPRESENTS A SURVEY MADE BY ME OR UNDER MY DIRECT SUPERVISION, THAT THE MONUMENTS SHOWN HEREON ACTUALLY EXIST AS DESCRIBED, AND THAT ALL DIMENSIONS AND OTHER DETAILS ARE CORRECT.

Feb 3 2025
 DATE
 David Ciampa
 PROFESSIONAL LAND SURVEYOR, LS-11649

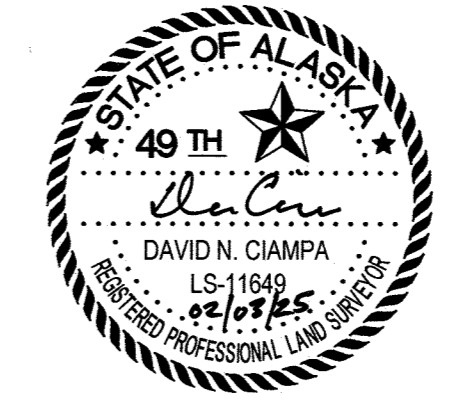

DATE OF SURVEY: BEGINNING: 10/09/2023 ENDING: 10/09/2023		SURVEYOR: DNR, DMLW, SURVEY SECTION 550 W. 7TH AVE, SUITE 650 ANCHORAGE, AK 99501-3576	
STATE OF ALASKA DEPARTMENT OF NATURAL RESOURCES DIVISION OF MINING, LAND, AND WATER ANCHORAGE, ALASKA			
RECORD OF SURVEY HISTORICAL TANANA VALLEY RAILROAD RIGHT-OF-WAY WITHIN VAULT SUBDIVISION (PLAT 81-142 FAIRBANKS RECORDING DISTRICT) LOCATED IN SECTIONS 35 AND 36, T. 3 N., R. 1 W. FAIRBANKS MERIDIAN, ALASKA FAIRBANKS RECORDING DISTRICT			
DRAWN BY: ANH		DNR APPROVAL RECOMMENDED	
DATE: 01/24/2025		STATEWIDE PLATTING SUPERVISOR DATE	
SCALE: 1"=100'	CHECKED BY: DNC	SHEET: 1 OF 2	FILE NO. EPF 20230054

MONUMENTS RECOVERED

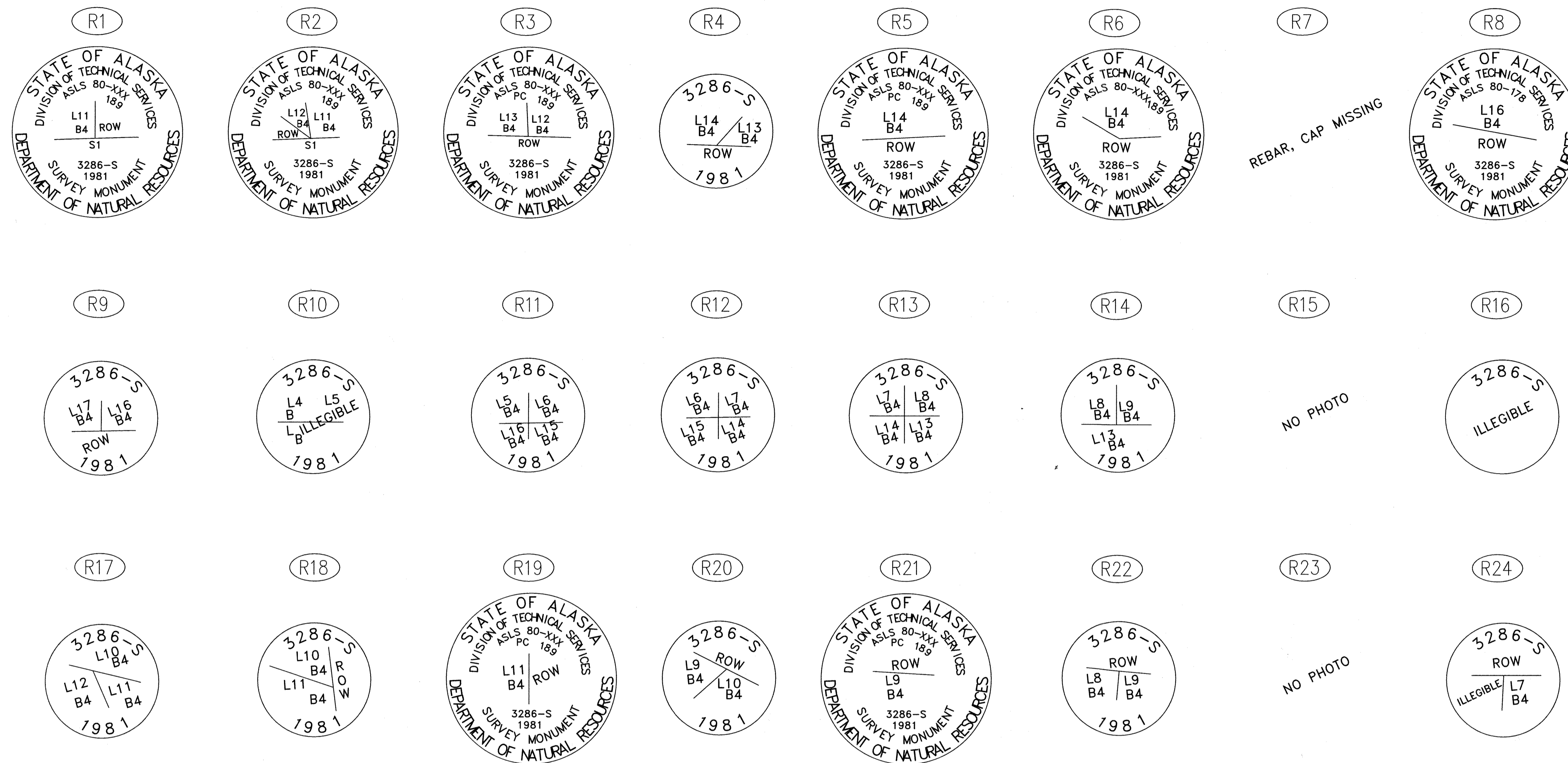

LINE TABLE		
LINE	DISTANCE	BEARING
L1	66.25'	S48°17'01"E
L2	58.97'	S16°05'50"E
L3	66.21'	S72°39'27"E
L4	494.31'	S31°33'31"W
L5	347.95'	S31°36'30"W
L6	55.96'	S31°36'30"W
L7	97.63'	N51°11'45"W
L8	45.96'	N87°51'51"E
L9	208.00'	N86°25'31"E
L10	104.38'	N31°25'27"E
L11	208.00'	S86°25'31"W
L12	48.65'	S87°14'19"W
L13	153.37'	N31°25'02"E
L14	213.07'	S58°24'02"E
L15	136.04'	N20°48'24"E
L16	55.15'	N31°33'20"E
L17	132.96'	N31°28'26"E
L18	212.33'	S15°14'04"E
L19	60.39'	N15°13'47"W
L20	85.32'	N46°53'54"W
L21	46.42'	S89°56'15"E
L22	231.82'	N46°53'54"W
L23	231.04'	S00°29'09"W

CURVE TABLE			
CURVE	DELTA	RADIUS	LENGTH (R)
C1	12°05'09"	863.74'	182.20' (182.86')
C2	9°05'14"	1132.52'	211.34' (211.39')
C3	31°29'07"	1505.41'	827.25' (827.84')
C4	6°30'30"	575.83'	65.41' (65.56')
C5	2°33'17"	3454.27'	154.02' (154.12')
C6	5°59'19"	3488.78'	364.64' (364.57')
C7	2°04'15"	3426.00'	123.82' (123.51')
C8	18°20'16"	1022.59'	327.28'
C9	4°58'52"	1222.59'	106.29'
C10	5°29'21"	1913.23'	183.3'
C11	8°23'46"	1222.59'	179.16'
C12	5°22'24"	1871.32'	175.5'
C13	26°32'27"	1713.23'	793.61'
C14	4°47'12"	1913.23'	159.84'
C15	11°8'4"	1913.23'	371.74'
C16	11°14'19"	1913.23'	375.29'
C17	20°20'41"	1759.42'	624.74'
C18	6°55'6"	1913.23'	231.01'
C19	20°55'02"	1122.59'	409.83'
C20	46°40'36"	1813.23'	1477.16'

REMAINDER AREA (acres)			
LOT	AREA	TVRR ROW	REMAINDER
8	5.00	0.10	4.90
9	5.02	0.83	4.19
11	4.12	1.49	2.63
12	4.58	2.29	2.29
13	5.27	2.63	2.64
14	5.04	2.00	3.04
15	5.03	1.41	3.62

2025-12
 Plat #
 Fairbanks
 Rec Dist
 02/03/2025
 Date
 Time 2:37 PM



DATE OF SURVEY: BEGINNING: 10/09/2023 ENDING: 10/09/2023 SURVEYOR: DNR, DMLW, SURVEY SECTION 550 W. 7TH AVE, SUITE 650 ANCHORAGE, AK 99501-3576

STATE OF ALASKA
 DEPARTMENT OF NATURAL RESOURCES DIVISION
 OF MINING, LAND, AND WATER
 ANCHORAGE, ALASKA

RECORD OF SURVEY
 HISTORICAL TANANA VALLEY RAILROAD
 RIGHT-OF-WAY
 WITHIN
 VAULT SUBDIVISION
 (PLAT 81-142 FAIRBANKS RECORDING DISTRICT)
 LOCATED IN SECTIONS 35 AND 36, T. 3 N., R. 1 W.,
 FAIRBANKS MERIDIAN, ALASKA
 FAIRBANKS RECORDING DISTRICT

DRAWN BY: ANH DATE: 01/24/2025 CHECKED BY: DNC SHEET: 2 OF 2 FILE NO. EPF 20230054

DNR APPROVAL RECOMMENDED
 STATEWIDE PLATTING SUPERVISOR DATE