

MANKOMEN LAKE REMOTE RECREATIONAL CABIN SITES

ASLS 2022-09

INDEX SHEET

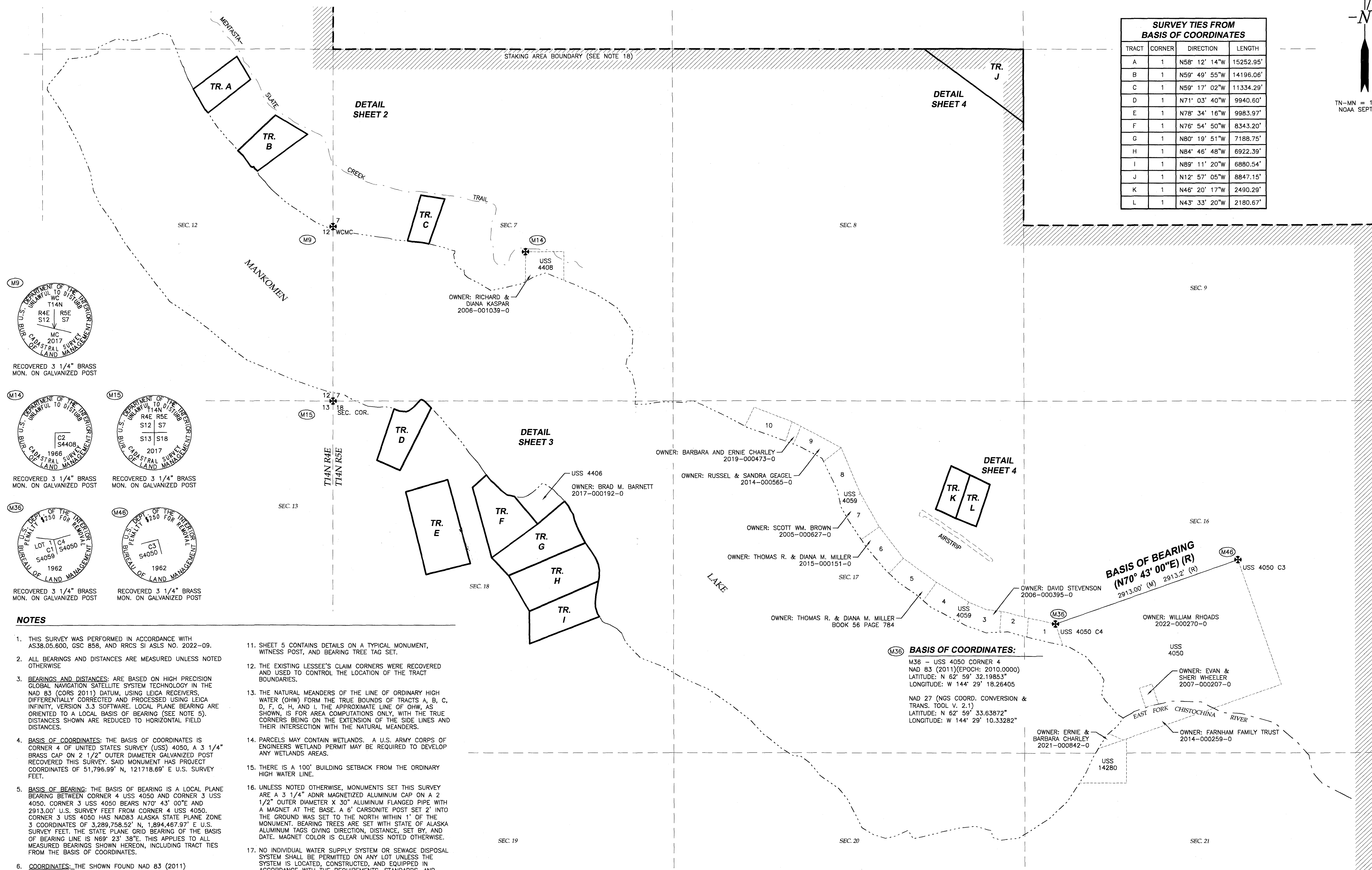

SURVEY TIES FROM BASIS OF COORDINATES			
TRACT	CORNER	DIRECTION	LENGTH
A	1	N58° 12' 14"W	15252.95'
B	1	N59° 49' 55"W	14196.06'
C	1	N59° 17' 02"W	11334.29'
D	1	N71° 03' 40"W	9940.60'
E	1	N78° 34' 16"W	9983.97'
F	1	N76° 54' 50"W	8343.20'
G	1	N80° 19' 51"W	7188.75'
H	1	N84° 46' 48"W	6922.39'
I	1	N89° 11' 20"W	6880.54'
J	1	N12° 57' 05"W	8847.15'
K	1	N46° 20' 17"W	2490.29'
L	1	N43° 33' 20"W	2180.67'

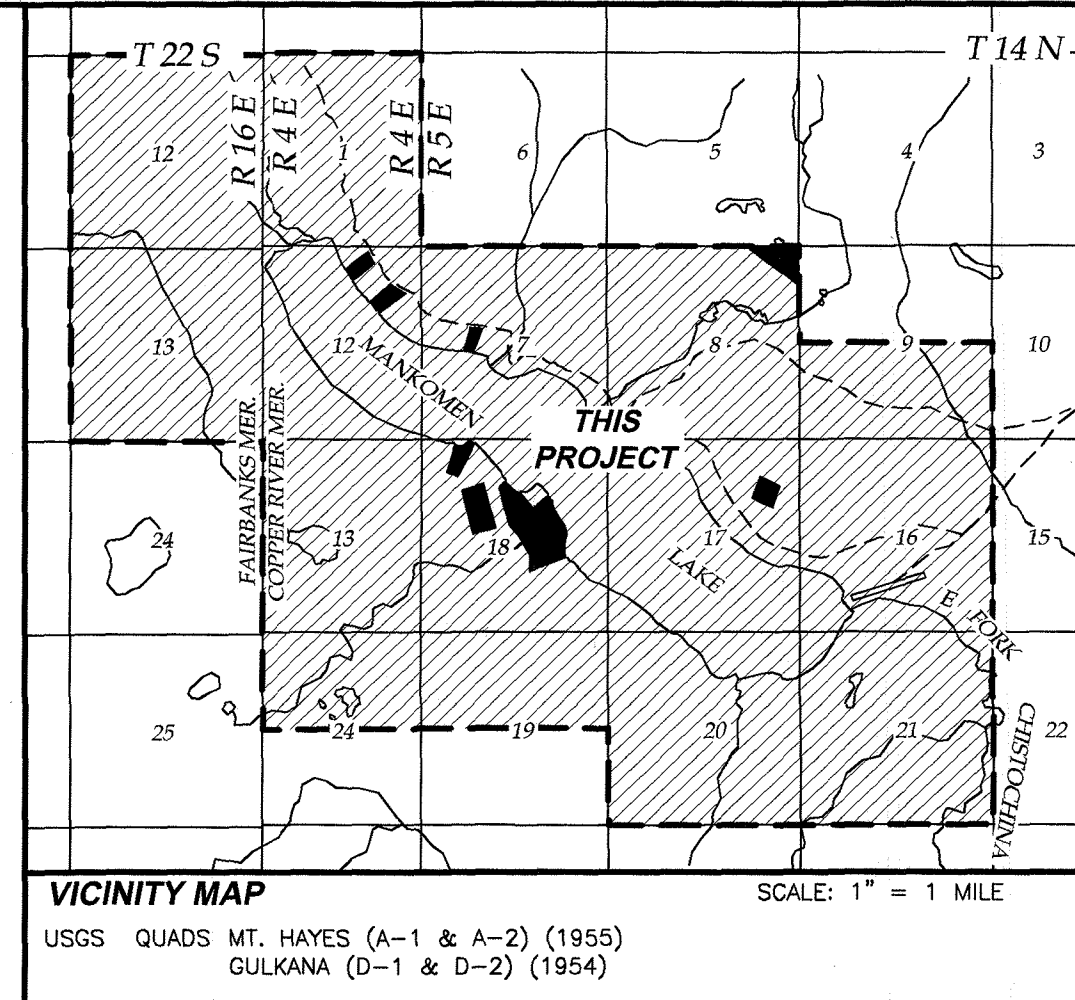
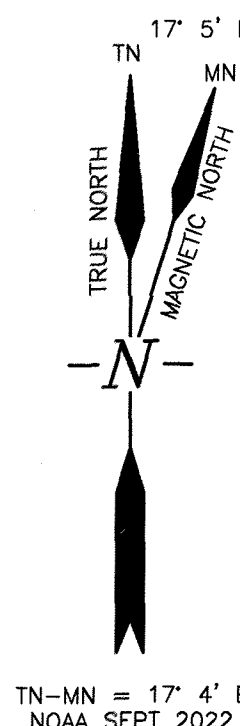

TAX CERTIFICATE

THIS SUBDIVISION LIES OUTSIDE OF ANY TAXING AUTHORITY, AT THE TIME OF FILING.

CERTIFICATE OF OWNERSHIP AND DEDICATION

I, THE UNDERSIGNED, HEREBY CERTIFY THAT I AM THE DIRECTOR, DIVISION OF MINING, LAND AND WATER AND THAT THE STATE OF ALASKA IS THE OWNER OF ASLS 2022-09, AS SHOWN HEREON. I HEREBY APPROVE THIS SURVEY AND PLAT FOR THE STATE OF ALASKA, AND DEDICATE FOR PUBLIC OR PRIVATE USE AS NOTED, ALL EASEMENTS, PUBLIC UTILITY AREAS, AND RIGHTS-OF-WAY AS SHOWN AND DESCRIBED HEREON.

12/18/2024
DATE
DIRECTOR, DIVISION OF MINING, LAND & WATER

NOTARY'S ACKNOWLEDGEMENT

SUBSCRIBED AND SWORN TO BEFORE ME THIS 18TH DAY OF December, 2024.

FOR: Guendolyn M. Gavelis
NOTARY PUBLIC FOR ALASKA
MY COMMISSION EXPIRES With Office

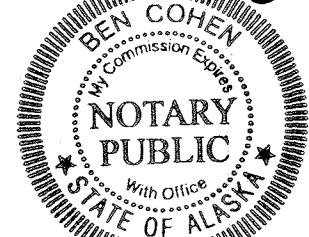

PLAT APPROVAL CERTIFICATE

THIS PLAT IS APPROVED BY THE COMMISSIONER OF THE DEPARTMENT OF NATURAL RESOURCES, OR THE COMMISSIONER'S DESIGNEE, IN ACCORDANCE WITH AS 40.15.

12/18/2024
DATE
COMMISSIONER

BY APPROVAL OF THIS PLAT, THE COMMISSIONER OF THE DEPARTMENT OF NATURAL RESOURCES HEREBY ACCEPTS FOR PUBLIC USE AND PUBLIC PURPOSES THE REAL PROPERTY DEDICATED TO THE PUBLIC HEREON, INCLUDING EASEMENTS, RIGHTS-OF-WAY, ALLEYS AND ROADWAYS. THE ACCEPTANCE OF SUCH DEDICATED AREAS FOR PUBLIC USE AND PUBLIC PURPOSES DOES NOT OBLIGATE THE DEPARTMENT, ANY GOVERNING BODY, OF THE PUBLIC TO CONSTRUCT, OPERATE, MAINTAIN OR MANAGE IMPROVEMENTS.

GRAPHIC SCALE

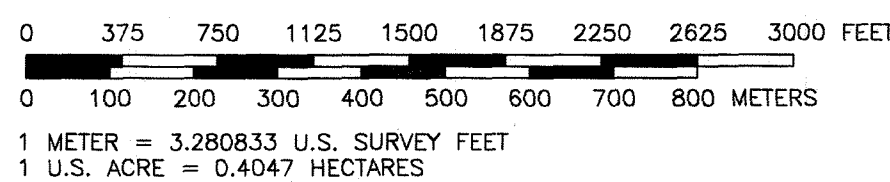

NOTES

- THIS SURVEY WAS PERFORMED IN ACCORDANCE WITH AS38.05.600, GSC 858, AND RACS SI ASLS NO. 2022-09.
- ALL BEARINGS AND DISTANCES ARE MEASURED UNLESS NOTED OTHERWISE.
- BEARINGS AND DISTANCES: ARE BASED ON HIGH PRECISION GLOBAL NAVIGATION SATELLITE SYSTEM TECHNOLOGY IN THE NAD 83 (CORS 2011) DATUM, USING LEICA RECEIVERS, DIFFERENTIALLY CORRECTED AND PROCESSED USING LEICA INFINITY, VERSION 3.3 SOFTWARE. LOCAL PLANE BEARING ARE ORIENTED TO A LOCAL BASIS OF BEARING (SEE NOTE 5). DISTANCES SHOWN ARE REDUCED TO HORIZONTAL FIELD DISTANCES.
- BASIS OF COORDINATES: THE BASIS OF COORDINATES IS CORNER 4 OF UNITED STATES SURVEY (USS) 4050, A 3 1/4" BRASS CAP ON 2 1/2" OUTER DIAMETER GALVANIZED POST RECOVERED THIS SURVEY. SAID MONUMENT HAS PROJECTIONS COORDINATES OF 51,796.99' N, 121718.69' E U.S. SURVEY FEET.
- BASIS OF BEARING: THE BASIS OF BEARING IS A LOCAL PLANE BEARING BETWEEN CORNER 4 USS 4050 AND CORNER 3 USS 4050. CORNER 3 USS 4050 BEARS N70° 43' 00"E AND 2913.00' U.S. SURVEY FEET FROM CORNER 4 USS 4050. CORNER 3 USS 4050 HAS NAD83 ALASKA STATE PLANE ZONE 3 COORDINATES OF 3,289,758.52' N, 1,894,467.97' E U.S. SURVEY FEET. THE STATE PLANE GRID BEARING OF THE BASIS OF BEARING LINE IS N69° 23' 38"E. THIS APPLIES TO ALL MEASURED BEARINGS SHOWN HEREON, INCLUDING TRACT TIES FROM THE BASIS OF COORDINATES.
- COORDINATES: THE SHOWN FOUND NAD 83 (2011) COORDINATES ARE BASED ON AN NGS OPUS SOLUTION (EPOCH 2010.0000) FOR M36. THE COORDINATES WERE CONstrained TO THE TO THE NATIONAL SPATIAL REFERENCE SYSTEM USING THE CORS REFERENCE STATIONS: AC63 (PID# DP3838), AC72 (PID# DP3844), AND AC78 (PID# DP1821).
- THE ERROR OF CLOSURE OF THIS SURVEY DOES NOT EXCEED 1:5000, AND/OR CORNER POSITIONS HAVE A RELATIVE POSITIONAL ACCURACY AT THE 95 PERCENT CONFIDENCE LEVEL OF 0.13 FEET PLUS 100 PPM.
- DISTANCE UNITS ARE U.S. SURVEY FEET (39.37/12 FEET PER METER EXACTLY).
- FOR BOUNDARY LINES INTERSECTING THE ORDINARY HIGH WATER LINE (SEE NOTE 13), DISTANCES SHOWN ARE TOTAL DISTANCE TO ORDINARY HIGH WATER AS SURVEYED. MONUMENT TO MONUMENT DISTANCES ARE CALCULATED BY SUBTRACTING THE WITNESS DISTANCE (WD) FROM THE OVERALL DISTANCE.
- ALL PARCELS OF LAND OWNED BY THE STATE OF ALASKA, LOCATED WITHIN 50.00 FEET OF, OR BISECTED BY A SURVEYED OR PROTRACTED SECTION LINE, ARE SUBJECT TO A 50 FOOT (50') EASEMENT, ON EACH SIDE OF THE SECTION LINE, WHICH IS RESERVED TO THE STATE OF ALASKA FOR PUBLIC HIGHWAYS UNDER A.S. 19.10.010.
- SHEET 5 CONTAINS DETAILS ON A TYPICAL MONUMENT, WITNESS POST, AND BEARING TREE TAG SET.
- THE EXISTING LESSEE'S CLAIM CORNERS WERE RECOVERED AND USED TO CONTROL THE LOCATION OF THE TRACT BOUNDARIES.
- THE NATURAL MEANDERS OF THE LINE OF ORDINARY HIGH WATER (OHW) FORM THE TRUE BOUNDS OF TRACTS A, B, C, D, F, G, H, AND I. THE APPROXIMATE LINE OF OHW, AS SHOWN, IS FOR AREA COMPUTATIONS ONLY, WITH THE TRUE CORNERS BEING ON THE EXTENSION OF THE SIDE LINES AND THEIR INTERSECTION WITH THE NATURAL MEANDERS.
- PARCELS MAY CONTAIN WETLANDS. A U.S. ARMY CORPS OF ENGINEERS WETLAND PERMIT MAY BE REQUIRED TO DEVELOP ANY WETLANDS AREAS.
- THERE IS A 100' BUILDING SETBACK FROM THE ORDINARY HIGH WATER LINE.
- UNLESS NOTED OTHERWISE, MONUMENTS SET THIS SURVEY ARE A 3 1/4" ADNR MAGNETIZED ALUMINUM CAP ON A 2 1/2" OUTER DIAMETER X 30" ALUMINUM FLANGED PIPE WITH A MAGNET AT THE BASE. A 6" CARBONITE POST, SET 2' INTO THE GROUND WAS SET TO THE NORTH WITHIN 1' OF THE MONUMENT. BEARING TREES ARE SET WITH STATE OF ALASKA ALUMINUM TAGS GIVING DIRECTION, DISTANCE, SET BY, AND DATE. MAGNET COLOR IS CLEAR UNLESS NOTED OTHERWISE.
- NO INDIVIDUAL WATER SUPPLY SYSTEM OR SEWAGE DISPOSAL SYSTEM SHALL BE PERMITTED ON ANY LOT UNLESS THE SYSTEM IS LOCATED, CONSTRUCTED, AND EQUIPPED IN ACCORDANCE WITH THE REQUIREMENTS, STANDARDS, AND RECOMMENDATIONS OF THE STATE OF ALASKA, DEPARTMENT OF ENVIRONMENTAL CONSERVATION, WHICH GOVERNS THOSE SYSTEMS.
- STAKING AREA EXCLUDES US SURVEYS 4050, 4406, 4408, AND LOTS 3, 5, 6, 7, AND 9 OF US SURVEY 4058.
- SECTIONS SHOWN ARE PROTRACTED AND ARE SUBJECT TO SURVEY. THE PROTRACTED SECTION LINES SHOWN ARE COMPUTED FROM THE POSITIONS OF THE SECTION CORNERS OF THE APPROVED BLM PROTRACTION DIAGRAMS FOR THE TOWNSHIPS REPRESENTED.
- UNLESS NOTED OTHERWISE, ADJACENT PARCELS ARE OWNED BY THE GOVERNMENT OF THE UNITED STATES OF AMERICA, WITH TENTATIVE APPROVAL GIVEN TO THE STATE OF ALASKA (TA 2012-0017, AND TA 2012-0027). US SURVEY 4059 LOTS 1, 2, 4, 8, AND 10 HAVE BEEN GRANTED TO THE STATE OF ALASKA VIA PATENT 50-2012-0221.
- WETLANDS SHOWN HEREON ARE AS APPARENT TO THE FIELD CONDITIONS AT THE TIME OF SURVEY AND ARE NOT DELINEATED IN ACCORDANCE WITH THE 1987 ARMY CORPS OF ENGINEERS WETLANDS DELINEATION MANUAL.

LEGEND

	BLM MONUMENT RECOVERED		MONUMENT IDENTIFIER
	PRIMARY MONUMENT SET THIS SURVEY	(R)	RECORD PER BLM PLAT
	STAKING BOUNDARY	(P)	BEARING AND DISTANCE PER BLM PROTRACTION DIAGRAM (NAD27 BEARINGS)
	TRACT BOUNDARY	PA/UE	PUBLIC ACCESS AND UTILITY EASEMENT
	SURVEY TIE	PAE	PUBLIC ACCESS EASEMENT RESERVED TO THE STATE PER AS 38.05.127
	EASEMENT	SLE	SECTION LINE EASEMENT PER AS 19.10.010
	PROTRACTED SECTION LINES	TE	TRAIL EASEMENT
	ADJACENT PARCELS	BSB	BUILDING SETBACK FROM ORDINARY HIGH WATER
	ORDINARY HIGH WATER	BT	BEARING TREE
	CREEK AND/OR WETLANDS BOUNDARY		
	TRAIL CENTERLINE		



SURVEYORS CERTIFICATE

I HEREBY CERTIFY THAT I AM PROPERLY REGISTERED AND LICENSED TO PRACTICE LAND SURVEYING IN THE STATE OF ALASKA, THAT THIS PLAT REPRESENTS A SURVEY MADE BY ME OR UNDER MY DIRECT SUPERVISION, THAT THE MONUMENTS SHOWN HEREON ACTUALLY EXIST AS DESCRIBED, AND THAT ALL DIMENSIONS AND OTHER DETAILS ARE CORRECT.

12/15/23
DATE
MICHAEL R. EWING
REGISTERED LAND SURVEYOR

DATE OF SURVEY:
BEGINNING: SEPT. 3, 2022
ENDING: SEPT. 7, 2023

SURVEYOR:
MICHAEL R. EWING
RECON, LLC 565 W. RECON CIR.
PALMER, AK 99645
907-746-3630 AECL #922

STATE OF ALASKA
DEPARTMENT OF NATURAL RESOURCES
DIVISION OF MINING, LAND, AND WATER
ANCHORAGE, ALASKA

ALASKA STATE LAND SURVEY NO. 2022-09

MANKOMEN LAKE REMOTE RECREATIONAL CABIN SITES

CREATING TRACTS A THROUGH L
WITHIN UNSURVEYED SECTION 12, T. 14 N., R. 4 E. AND
UNSURVEYED SECTIONS 7, 8, 17, & 18 T. 14 N., R. 5 E.,
COPPER RIVER MERIDIAN, ALASKA

CHITINA RECORDING DISTRICT

DRAWN BY: DVD
DATE: 12/15/2023
SCALE: 1" = 750'
CHECKED: MRE
SHEET: 1 OF 5
APPROVAL
Elabeth Anderson 12/18/24
DATE
STANDARD PLATTING SUPERVISOR
DNR FILE NO.
ASLS 20220009

DNR FILE NO.	ASLS 20220009
--------------	---------------

LESSEE CERTIFICATE

I, THE UNDERSIGNED, HEREBY CERTIFY THAT I AM THE LESSEE AS SHOWN HEREON. I HEREBY APPROVE THIS SURVEY AND PLAT.

TRACT D, ADL 233533

Craig Sandline
CRAIG R. SANDLINE
111 CHIEF CHARLIE DR.
FAIRBANKS, AK 99709

29 March 2024
DATE

NOTARY'S ACKNOWLEDGEMENT

SUBSCRIBED AND SWORN TO BEFORE ME THIS 29 DAY OF March

2024 FOR: *Craig Sandline*

Harriet Bell
NOTARY PUBLIC FOR ALASKA
MY COMMISSION EXPIRES With Office

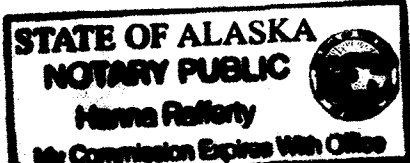

LESSEE CERTIFICATE

I, THE UNDERSIGNED, HEREBY CERTIFY THAT I AM THE LESSEE AS SHOWN HEREON. I HEREBY APPROVE THIS SURVEY AND PLAT.

TRACT E, ADL 233529

Alicia Combs
ALICIA R. COMBS
P.O. BOX 48
TOK, AK 99780

5/23/24
DATE

NOTARY'S ACKNOWLEDGEMENT

SUBSCRIBED AND SWORN TO BEFORE ME THIS 23 DAY OF May

2024 FOR: *Alicia Combs*

Christina
NOTARY PUBLIC FOR ALASKA
MY COMMISSION EXPIRES With Office

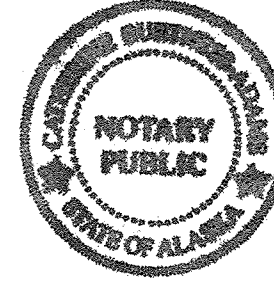

LESSEE CERTIFICATE

I, THE UNDERSIGNED, HEREBY CERTIFY THAT I AM THE LESSEE AS SHOWN HEREON. I HEREBY APPROVE THIS SURVEY AND PLAT.

TRACT G, ADL 233535

Brad M. Barnett
BRAD M. BARNETT
P.O. BOX 182
VALDEZ, AK 99686

06/13/24
DATE

NOTARY'S ACKNOWLEDGEMENT

SUBSCRIBED AND SWORN TO BEFORE ME THIS 13th DAY OF June

2024 FOR: *Brad M. Barnett*

Katherine Carr
KATHERINE CARR
Notary Public
State of Alaska
My Commission Expires Mar. 19, 2027

Kevin Bow
NOTARY PUBLIC FOR ALASKA
MY COMMISSION EXPIRES March 19, 2027

LESSEE CERTIFICATE

I, THE UNDERSIGNED, HEREBY CERTIFY THAT I AM THE LESSEE AS SHOWN HEREON. I HEREBY APPROVE THIS SURVEY AND PLAT.

TRACT H, ADL 233532

Jeffrey R. Hocking
JEFFREY R. HOCKING
P.O. BOX 1533
PALMER, AK 99645

8-1-24
DATE

NOTARY'S ACKNOWLEDGEMENT

SUBSCRIBED AND SWORN TO BEFORE ME THIS 1st DAY OF August

2024 FOR: *Jeffrey R. Hocking*

Kevin Bow
NOTARY PUBLIC FOR ALASKA
MY COMMISSION EXPIRES With Office

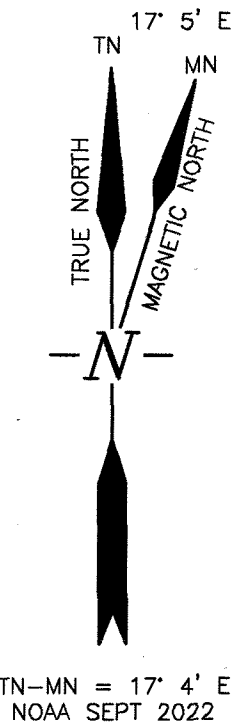

LINE #	DIRECTION	LENGTH
L33	S40° 13' 54"E	95.47'
L34	S26° 13' 48"E	79.86'
L35	S31° 18' 55"E	62.76'
L36	S13° 54' 44"E	89.37'
L37	S22° 02' 35"E	152.23'
L38	S28° 38' 35"E	226.36'
L39	S34° 43' 14"E	179.75'
L40	S32° 37' 19"E	86.57'
L41	S23° 19' 48"E	114.32'
L42	S10° 47' 53"E	86.24'
L43	S1° 42' 05"W	108.08'
L44	S10° 53' 50"W	58.83'
L45	S10° 53' 50"W	210.62'
L46	S4° 52' 03"W	97.10'
L47	S2° 09' 49"E	93.25'
L48	S17° 50' 39"E	97.69'
L49	S35° 52' 33"E	52.45'

LINE #	DIRECTION	LENGTH
L17	S67° 24' 26"E	12.52'
L18	S67° 19' 45"E	74.08'
L19	S85° 36' 50"E	105.69'
L20	N70° 06' 58"E	43.58'
L21	N52° 16' 40"E	93.60'
L22	N42° 55' 16"E	133.08'
L23	N52° 47' 15"E	15.38'
L24	N84° 39' 25"E	14.85'
L25	S70° 03' 35"E	33.08'
L26	S46° 49' 20"E	39.92'
L27	S44° 31' 53"E	121.28'

LINE #	DIRECTION	LENGTH
L17	S67° 24' 26"E	12.52'
L18	S67° 19' 45"E	74.08'
L19	S85° 36' 50"E	105.69'
L20	N70° 06' 58"E	43.58'
L21	N52° 16' 40"E	93.60'
L22	N42° 55' 16"E	133.08'
L23	N52° 47' 15"E	15.38'
L24	N84° 39' 25"E	14.85'
L25	S70° 03' 35"E	33.08'
L26	S46° 49' 20"E	39.92'
L27	S44° 31' 53"E	121.28'

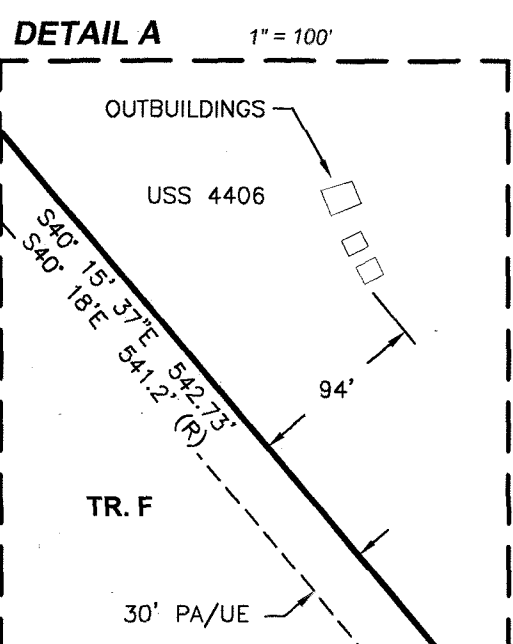

MON. ID	LATITUDE	LONGITUDE
M16	63° 00' 04.0" N	144° 32' 41.8" W
M17	62° 59' 54.8" N	144° 32' 51.9" W
M18	62° 59' 56.3" N	144° 32' 59.4" W
M19	63° 00' 03.9" N	144° 32' 53.9" W
M20	62° 59' 51.7" N	144° 32' 50.1" W
M21	62° 59' 53.5" N	144° 32' 36.3" W
M22	62° 59' 41.1" N	144° 32' 59.4" W
M23	62° 59' 39.5" N	144° 32' 43.3" W
M24	62° 59' 54.0" N	144° 32' 24.0" W
M25	62° 59' 50.8" N	144° 32' 14.2" W
M26	62° 59' 46.9" N	144° 32' 07.0" W
M27	62° 59' 50.1" N	144° 31' 58.8" W
M28	62° 59' 44.1" N	144° 31' 51.7" W
M29	62° 59' 38.4" N	144° 31' 47.5" W
M30	62° 59' 33.2" N	144° 31' 47.2" W
M31	62° 59' 29.2" N	144° 32' 09.6" W
M32	62° 59' 34.0" N	144° 00' 00.0" W
M33	62° 59' 39.3" N	144° 32' 16.4" W
M34	62° 59' 41.9" N	144° 32' 21.9" W
M35	62° 59' 52.3" N	144° 32' 28.2" W

NAD 83 GEODETIC COORDINATES, AS SHOWN IN THESE TABLES, ARE ROUNDED TO THE NEAREST TENTH OF A SECOND AND ARE LISTED TO AID LESSEES AND PROPERTY OWNERS IN FINDING THEIR BOUNDARY CORNER MONUMENTS. THESE COORDINATES ARE NOT INTENDED TO BE USED TO ESTABLISH OR RE-ESTABLISH BOUNDARIES. SEE SHEET 5 FOR TYPICAL WITNESS POST AND TYPICAL BEARING TREE TAG DETAILS.

LESSEE CERTIFICATE

I, THE UNDERSIGNED, HEREBY CERTIFY THAT I AM THE LESSEE AS SHOWN HEREON. I HEREBY APPROVE THIS SURVEY AND PLAT.

TRACT F, ADL 233540

Tyler J. Andersen
TYLER J. ANDERSEN
P.O. BOX 1673
VALDEZ, AK 99686

6/13/2024
DATE

NOTARY'S ACKNOWLEDGEMENT

SUBSCRIBED AND SWORN TO BEFORE ME THIS 13th DAY OF June

2024 FOR: *Tyler J. Andersen*

Katherine Carr
KATHERINE CARR
Notary Public
State of Alaska
My Commission Expires Mar. 19, 2027

RA
NOTARY PUBLIC FOR ALASKA
MY COMMISSION EXPIRES March 19, 2027

LEGEND

	BLM MONUMENT RECOVERED		MONUMENT IDENTIFIER
	PRIMARY MONUMENT SET THIS SURVEY		RECORD PER BLM PLAT
	TRACT BOUNDARY		BEARING AND DISTANCE PER BLM PROTRACTION DIAGRAM (NAD27 BEARINGS)
	SURVEY TIE		PUBLIC ACCESS AND UTILITY EASEMENT
	EASEMENT		PUBLIC ACCESS EASEMENT RESERVED TO THE STATE PER AS 38.05.127
	PROTRACTED SECTION LINES		SECTION LINE EASEMENT PER AS 19.10.010
	ORDINARY HIGH WATER		BUILDING SETBACK FROM ORDINARY HIGH WATER
	CREEK AND/OR WETLANDS BOUNDARY		

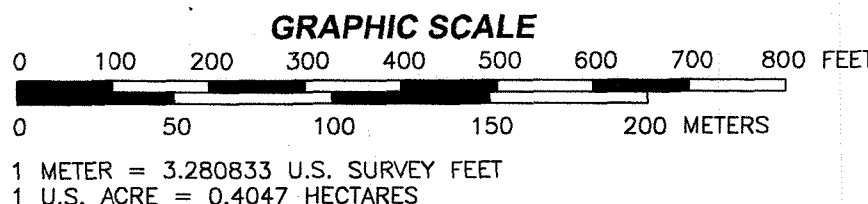

DATE OF SURVEY:	SURVEYOR:
BEGINNING: SEPT. 3, 2022	MICHAEL R. EWING
ENDING: SEPT. 7, 2023	RECON, LLC 565 W. RECON CIR. PALMER, AK 99645
	907-746-3630 AECL #922

STATE OF ALASKA
DEPARTMENT OF NATURAL RESOURCES
DIVISION OF MINING, LAND, AND WATER
ANCHORAGE, ALASKA

ALASKA STATE LAND SURVEY NO. 2022-09

MANKOMEN LAKE REMOTE RECREATIONAL CABIN SITES

CREATING TRACTS A THROUGH L WITHIN UNSURVEYED SECTION 12, T. 14 N., R. 4 E. AND UNSURVEYED SECTIONS 7, 8, 17, & 18 T. 14 N., R. 5 E., COPPER RIVER MERIDIAN, ALASKA

CHITINA RECORDING DISTRICT

DRAWN BY: DVD	APPROVAL
DATE: 12/15/2023	<i>Elizabeth Anderson</i> 12/19/24
SCALE: 1" = 200'	CHECKED: MRE
	SHEET: 3 OF 5
	DNR FILE NO. ASLS 20220009

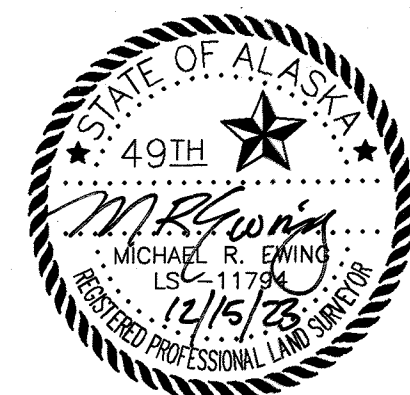

Chitina Recording District PL 2024-14

MONUMENT ACCESSORY TABLE				
MON. ID	BEARING OBJECT	BEARING	DISTANCE	NOTES
M1	5" SPRUCE	N 23° E	45.8'	NEW
	6" SPRUCE	S 39° E	72.8'	NEW
	6" SPRUCE	N 15° W	66.3'	NEW
M2	4" SPRUCE	N 31° E	34.0'	NEW
	9" SPRUCE	S 40° W	22.0'	NEW
	10" SPRUCE	N 32° W	41.1'	NEW
M3	6" SPRUCE	N 24° E	36.5'	NEW
	10" SPRUCE	S 28° W	19.1'	NEW
	4" SPRUCE	N 57° W	39.8'	NEW
M4	4" SPRUCE	N 38° E	8.7'	NEW
	10" SPRUCE	S 27° E	38.6'	NEW
	6" SPRUCE	N 46° W	29.7'	NEW
M5	3" SPRUCE	N 67° E	19.5'	NEW
	8" SPRUCE	S 45° E	38.9'	NEW
	6" SPRUCE	N 58° W	56.3'	NEW
M6	4" SPRUCE	N 73° E	21.9'	NEW
	8" SPRUCE	S 11° E	19.1'	NEW
	11" SPRUCE	N 25° W	8.0'	NEW
M7	5" SPRUCE	N 68° E	40.8'	NEW
	7" SPRUCE	S 18° W	22.8'	NEW
	4" SPRUCE	N 55° W	11.5'	NEW
M8	8" SPRUCE	N 77° E	52.3'	NEW
	6" SPRUCE	S 30° E	9.8'	NEW
	10" SPRUCE	N 22° W	35.4'	NEW
M9	7" SPRUCE	N 45° E	16.7'	MEASURED
	6" SPRUCE	N 28° W	26.0'	MEASURED
	4" SPRUCE	N 52° E	24.1'	NEW
M10	7" SPRUCE	S 62° E	34.9'	NEW
	6" SPRUCE	S 41° W	15.9'	NEW
	9" SPRUCE	S 16° E	21.6'	NEW
M11	7" SPRUCE	S 61° W	50.3'	NEW
	10" SPRUCE	N 24° W	54.3'	NEW
	4" SPRUCE	S 34° E	11.9'	NEW
M12	4" SPRUCE	S 55° W	35.0'	NEW
	4" SPRUCE	N 03° W	30.5'	NEW
	8" SPRUCE	N 58° E	35.2'	NEW
M13	6" SPRUCE	S 84° E	29.7'	NEW
	3" SPRUCE	N 38° W	41.3'	NEW
M14	8" SPRUCE	S 46° E	14.5'	MEASURED
	(S 47° E)	(14.5')	RECORD BLM	
	6" SPRUCE	S 48° W	20.0'	MEASURED
	(S 47 1/2° W)	(19.5')	RECORD BLM	

MONUMENT ACCESSORY TABLE				
MON. ID	BEARING OBJECT	BEARING	DISTANCE	NOTES
M15	6" SPRUCE	N 56° E	13.5'	MEASURED
	7" SPRUCE	S 25° E	24.3'	MEASURED
	7" SPRUCE	S 89° W	26.8'	MEASURED
	7" SPRUCE	N 35° W	29.8'	MEASURED
M16	10" SPRUCE	S 20° E	33.1'	NEW
	4" SPRUCE	S 43° W	48.9'	NEW
	8" SPRUCE	S 87° W	35.8'	NEW
M17	4" SPRUCE	N 83° E	24.0'	NEW
	3" SPRUCE	S 22° E	27.8'	NEW
	5" SPRUCE	N 58° W	36.2'	NEW
M18	9" SPRUCE	N 05° E	48.5'	NEW
	6" SPRUCE	S 89° E	36.7'	NEW
	3" SPRUCE	S 89° W	11.0'	NEW
M19	5" SPRUCE	S 42° E	5.6'	NEW
	4" SPRUCE	S 43° W	46.7'	NEW
	7" SPRUCE	N 82° W	53.6'	NEW
M20	3" SPRUCE	N 49° E	6.7'	NEW
	3" SPRUCE	S 29° W	9.0'	NEW
	3" SPRUCE	N 48° W	9.5'	NEW
M21	8" SPRUCE	N 11° E	56.9'	NEW
	6" SPRUCE	S 22° E	39.4'	NEW
	9" SPRUCE	S 70° W	29.8'	NEW
M22	3" SPRUCE	N 32° E	8.8'	NEW
	2" SPRUCE	S 14° E	11.9'	NEW
	3" SPRUCE	N 87° W	15.0'	NEW
M23	4" SPRUCE	N 90° E	22.9'	NEW
	3" SPRUCE	S 10° W	42.5'	NEW
	7" SPRUCE	N 43° W	57.4'	NEW
M24	12" SPRUCE	S 04° W	15.2'	NEW
	7" SPRUCE	S 89° W	21.4'	NEW
	13" SPRUCE	N 36° W	32.5'	NEW
M25	7" SPRUCE	S 06° E	7.0'	MEASURED
	(S 13° E)	(6.8')	RECORD BLM	
	8" SPRUCE	S 76° W	49.3'	MEASURED
M26	(S 68° W)	(48.8')	RECORD BLM	
	7" SPRUCE	N 03° E	61.0'	MEASURED
	(N 4 1/2° E)	(61.1')	RECORD BLM	
	10" SPRUCE	S 40° W	37.5'	MEASURED
	(S 32° W)	(37.6')	RECORD BLM	

MONUMENT ACCESSORY TABLE				
MON. ID	BEARING OBJECT	BEARING	DISTANCE	NOTES
M27	8.5" SPRUCE	S 03° E	36.3'	MEASURED
	(S 2 1/2° E)	(36.3')	RECORD BLM	
	3.5" SPRUCE	N 70° W	18.4	MEASURED
M28	14" SPRUCE	(N 74 1/2° W)	(18.2')	RECORD BLM
	(EXISTING, NOT IN BLM FIELD NOTES)	N 61° W	63.4'	MEASURED
	7" SPRUCE	S 10° W	26.7'	NEW
M29	13" SPRUCE	S 78° W	56.1'	NEW
	5" SPRUCE	N 50° W	63.6'	NEW
	10" SPRUCE	N 18° E	20.0'	NEW
M30	8" SPRUCE	S 01° E	29.8'	NEW
	7" SPRUCE	S 88° W	19.6'	NEW
	14" SPRUCE	S 52° W	63.3'	NEW
M31	6" SPRUCE	N 83° W	46.2'	NEW
	6" SPRUCE	N 20° W	31.1'	NEW
	7" SPRUCE	N 54° E	26.2'	NEW
M32	7" SPRUCE	S 24° E	67.8'	NEW
	5" SPRUCE	N 72° W	11.5'	NEW
	10" SPRUCE	N 51° E	50.2'	NEW
M33	3" SPRUCE	S 67° E	41.9'	NEW
	8" SPRUCE	N 79° W	22.0'	NEW
	5" SPRUCE	N 58° E	67.9'	NEW
M34	4" SPRUCE	S 61° E	43.9'	NEW
	3" SPRUCE	N 71° W	21.6'	NEW
	5" SPRUCE	N 30° E	35.1'	NEW
M35	4" SPRUCE	N 82° E	24.8'	NEW
	4" SPRUCE	N 44° W	8.3'	NEW
	6" SPRUCE	N 28° E	45.1'	NEW
M36	3" SPRUCE	S 32° E	25.3'	NEW
	8" SPRUCE	N 32° W	43.0'	NEW
	13" SPRUCE	S 67° E	145.8'	MEASURED
	(S 67 1/2° E)	(145.2')	RECORD BLM	
	10" SPRUCE	N 87° W	112.5'	MEASURED
	(N 88 1/2° W)	(112.2')	RECORD BLM	

MONUMENT ACCESSORY TABLE				
MON. ID	BEARING OBJECT	BEARING	DISTANCE	NOTES
M37	5" SPRUCE	S 20° E	54.7'	NEW
	8" SPRUCE	S 46° W	68.3'	NEW
	8" SPRUCE	N 87° W	57.2'	NEW
M38	6" SPRUCE	N 32° E	39.6'	NEW
	5" SPRUCE	S 39° W	74.3'	NEW
	4" SPRUCE	N 78° W	58.3'	NEW
M39	6" SPRUCE	N 12° W	33.1'	NEW
	9" SPRUCE	N 77° E	24.1'	NEW
	7" SPRUCE	S 57° W	12.8'	NEW
M40	5" SPRUCE	N 03° W	4.9'	NEW
	7" SPRUCE	N 56° E	39.1'	NEW
	5" SPRUCE	S 76° E	45.5'	NEW
M41	8" SPRUCE	S 73° W	53.5'	NEW
	3" SPRUCE	S 25° E	47.5'	NEW
	5" SPRUCE	S 50° W	49.8'	NEW
M42	4" SPRUCE	N 05° W	62.2'	NEW
	4" SPRUCE	S 42° E	33.5'	NEW
	3" SPRUCE	S 12° W	25.0'	NEW
M43	3" SPRUCE	N 25° W	55.1'	NEW
	3" SPRUCE	N 58° E	14.8'	NEW
	3" SPRUCE	S 07° E	21.1'	NEW
M44	5" SPRUCE	N 63° W	54.9'	NEW
	4" SPRUCE	N 33° E	23.8'	NEW
	4" SPRUCE	S 04° W	21.9'	NEW
M45	4" SPRUCE	S 77° W	35.7'	NEW
	3" SPRUCE	N 53° E	33.8'	NEW
	4" SPRUCE	S 04° E	50.7'	NEW
M46	5" SPRUCE	N 34° W	60.5'	NEW
	8" SPRUCE	N 77° E	36.4'	NEW
	5" SPRUCE	S 53° E	12.3'	NEW
NO RECORD BLS	4" SPRUCE	S 69° W	17.8'	NEW

LEGEND

BT BEARING TREE

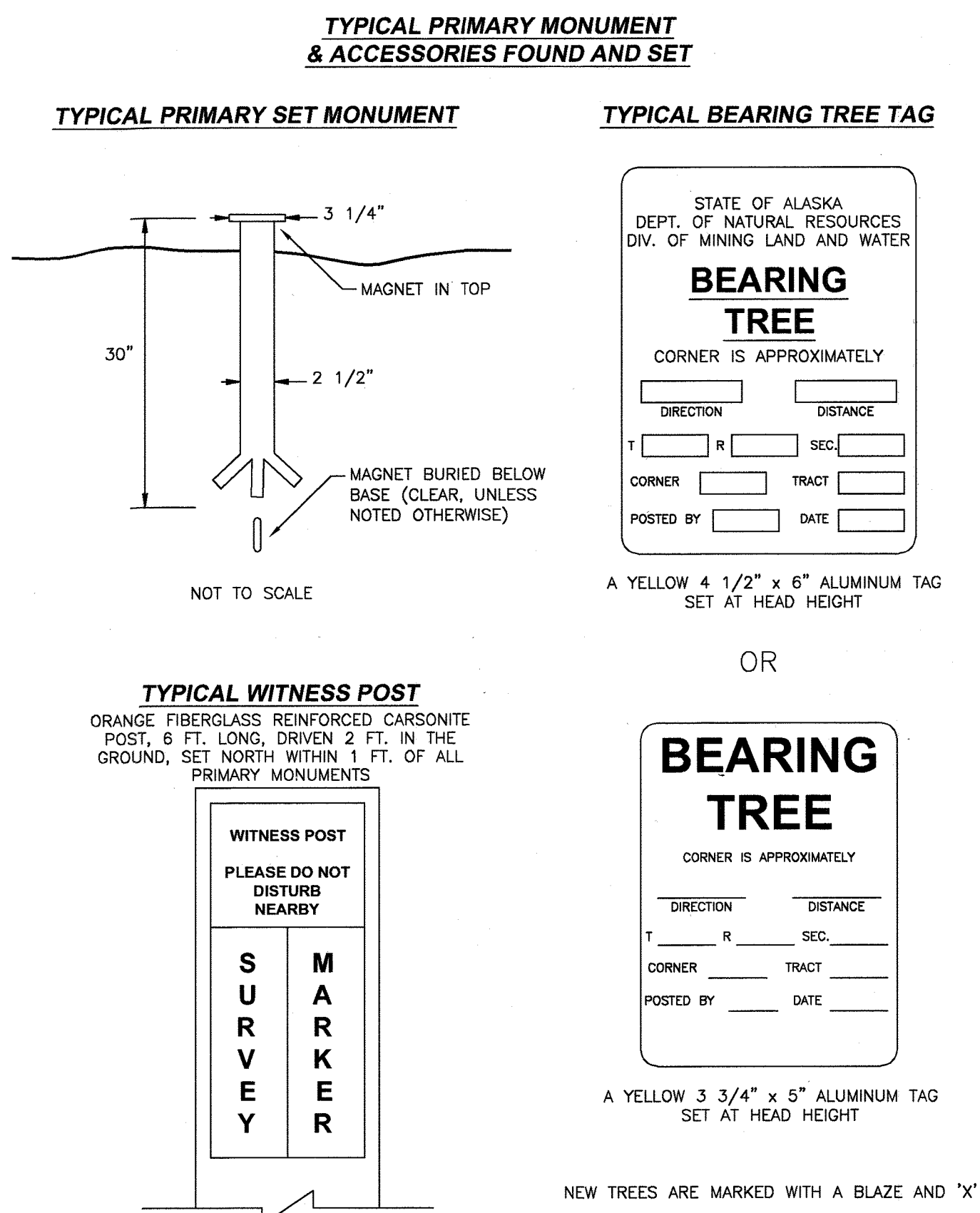

DATE OF SURVEY: BEGINNING: SEPT. 3, 2022 ENDING: SEPT. 7, 2023	SURVEYOR: MICHAEL R. EWING RECON, LLC 565 W. RECON CIR. PALMER, AK 99645 907-746-3630 AECL #922
STATE OF ALASKA DEPARTMENT OF NATURAL RESOURCES DIVISION OF MINING, LAND, AND WATER ANCHORAGE, ALASKA	
ALASKA STATE LAND SURVEY NO. 2022-09	
MANKOMEN LAKE REMOTE RECREATIONAL CABIN SITES	
CREATING TRACTS A THROUGH L WITHIN UNSURVEYED SECTION 12, T. 14 N., R. 4 E. AND UNSURVEYED SECTIONS 7, 8, 17, & 18 T. 14 N., R. 5 E., COPPER RIVER MERIDIAN, ALASKA	
CHITINA RECORDING DISTRICT	
DRAWN BY: DVD DATE: 12/15/2023	APPROVAL Elizabeth Anderson 12/18/24 STATEWIDE PLATTING SUPERVISOR DATE
SCALE: N/A	CHECKED: MRE
SHEET: 5 OF 5	DNR FILE NO. ASLS 20220009

Attachment "A"

ALASKA STATE LAND SURVEY 2022-09

LESSEE CERTIFICATE

I, the undersigned, hereby certify that I am the lessee as shown hereon. I hereby approve this survey and plat.

TRACT No. "K" ADL No. 233537

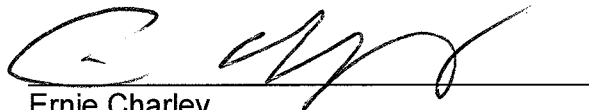

Ernie Charley
HC 01 Box 225
Gakona, Alaska 99586

5-21-24
Date

NOTARY'S ACKNOWLEDGEMENT

Subscribed and sworn to before me this 21st day of May, 2024

For Ernie Charley



Notary Public for The State of Alaska

My Commission Expires 12/12/24

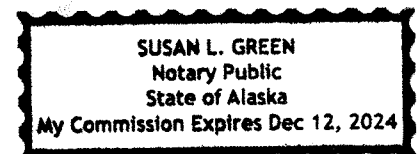

Attachment "B"

ALASKA STATE LAND SURVEY 2022-09

LESSEE CERTIFICATE

I, the undersigned, hereby certify that I am the lessee as shown hereon. I hereby approve this survey and plat.

TRACT No. "J" ADL No. 233536

Patricia Ekberg
PATRICIA G. EKBERG
P.O. BOX 383426
WAIKOLOA, HI 96738

06/18/2024

Date

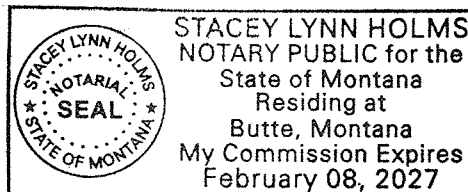

NOTARY'S ACKNOWLEDGEMENT

Subscribed and sworn to before me this 18th day of June, 2024

For Patricia Ekberg

Stacey Lynn Holms

Notary Public for The State of Montana

My Commission Expires 02.08.2027