

# TALACHULITNA WEST REMOTE RECREATIONAL CABIN SITES

## CERTIFICATE OF PAYMENT OF TAXES

I hereby certify that all current taxes and special assessments, through December 31, 2008 against the property, included in the subdivision, hereon have been paid.

Chapman Glend 12/16/08  
BOROUGH TAX COLLECTION OFFICIAL DATE

## PLANNING AND LAND USE DIRECTOR'S CERTIFICATE

I certify that this subdivision plat has been found to comply with the Land Subdivision Regulations of the Matanuska-Susitna Borough and that the plat has been approved by the Platting Authority by Plat Resolution 2008-131-SUB Dated AUGUST 7, 2008 and that this plat has been approved for recording in the Anchorage Recording District, Third Judicial District, State of Alaska.

Mark Mayo 12/16/08  
Planning Director Date

Attest Marilyn McLeish  
Platting Clerk



## CERTIFICATE OF OWNERSHIP AND DEDICATION

I, the undersigned, hereby certify that I am the Director, Division of Mining, Land and Water and that the State of Alaska is the owner of ASLS 2006-24 as shown hereon. I hereby approve this survey and plat for the State of Alaska and dedicate for public or private use as noted, all easements, public utility areas, and rights-of-way as shown and described hereon.

Dated: Dec 17, 2008 Donald Jennings  
Director, Division of Mining, Land and Water

## NOTARY'S ACKNOWLEDGEMENT

SUBSCRIBED AND SWORN TO BEFORE ME  
THIS 12 DAY OF DECEMBER, 2008

BY Donald Jennings

James P. [Signature]  
NOTARY FOR THE STATE OF ALASKA  
MY COMMISSION EXPIRES 12/01/2010

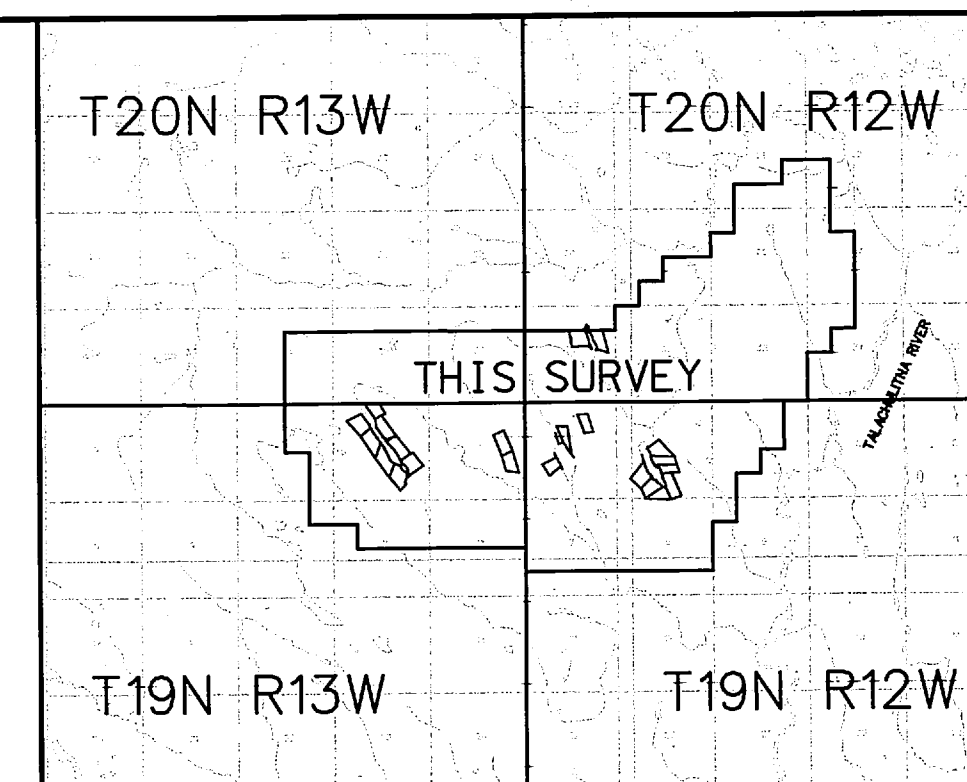
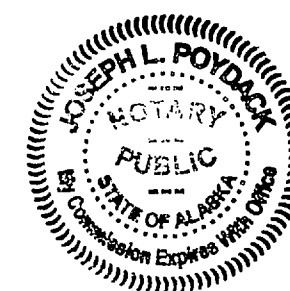

VICINITY MAP  
Source: USGS DLG Tyonek C4,C5, D4 and D5  
Scale 1" = 2 miles

## NOTES

A. This survey was accomplished in accordance with AS 38.05.600, GSC 727 RRCS-SI: 2006-24.

B. All bearings shown are true bearings as oriented to the Basis of Bearing and distances shown are reduced to horizontal field distances.

C. The accuracy of the survey is greater than 1:5000.

D. All parcels of land owned by the State of Alaska, located within 50.00 feet of, or bisected by a surveyed or protracted section line, are subject to a 50 foot(50') easement, each side of the section line, which is reserved to the State of Alaska for public highways under A.S. 19.10.010.

E. The existing lessee's claim corners were recovered and used to control the location of the tract boundary.

F. BASIS OF BEARING The Basis of Bearing for this plat was determined by high precision GPS survey using Topcon GGD receivers, differentially corrected and processed using Trimble Total Control, Version 2.73 processing software.

G. BASIS OF COORDINATES NAD27 The coordinates depicted on the plats are based on a tie to a monument of record using high precision GPS survey techniques. The bearing and distance obtained were applied to the record NAD27 position to compute the NAD27 positions of a corner of each tract.

NAD83 coordinates were derived by high precision GPS survey using Topcon GGD receivers, differentially corrected and processed using Trimble Total Control, Version 2.73 processing software. The adjustment was constrained to NGS CORS station ZANI (CORS96) (EPOCH 2003.0)

H. The 2007 mean magnetic declination was determined by calculation using the Magnetic Declination Calculator (MIRP) maintained by Natural Resources Canada at [http://www.geolab.nrcan.gc.ca/geomag/mirp\\_e.shtml](http://www.geolab.nrcan.gc.ca/geomag/mirp_e.shtml)

I. The Matanuska-Susitna Borough is not responsible for road construction or road maintenance.

J. The Matanuska-Susitna Borough is not responsible to construct or maintain access easements within the staking area.

K. There is an 100 foot building setback from all water bodies.

L. Land Use Note: There may be Federal, State and local requirements governing land use. It is the responsibility of the individual parcel owner to obtain a determination whether such requirements apply to the development of parcels shown hereon.

M. Wastewater Note: No individual water supply system or sewage disposal system shall be permitted on any lot unless such system is located, constructed and equipped in accordance with the requirements, standards and recommendations of the State of Alaska, Department of Conservation, which govern those systems.

1 Meter = 3.280833 U.S. Survey Feet 1 U.S. acre = 0.4047 hectare

DATE OF SURVEY: BEGINNING: 10/04/2007 ENDING: 10/11/2007	NAME OF SURVEYOR: The Crazy Mountains JV 2000 E. Dowling Road, #6 Anchorage, AK 99507
--	--

STATE OF ALASKA  
DEPARTMENT OF NATURAL RESOURCES  
DIVISION OF MINING LAND AND WATER  
Anchorage, Alaska

ALASKA STATE LAND SURVEY NO. 2006-24

TALACHULITNA WEST REMOTE RECREATIONAL CABIN SITES  
CREATING TRACTS A THROUGH V  
WITHIN PROTRACTED SECTION 31, T. 20 N., R. 12 W., SECTIONS 1 & 2,  
T. 19 N., R. 13 W., SECTIONS 5, 6 & 9, T. 19 N., R. 12 W., SEWARD MERIDIAN, ALASKA  
ANCHORAGE RECORDING DISTRICT  
Containing 361.30 Acres

DRAWN BY: JEM DATE: 4/7/2008	APPROVAL RECOMMENDED <u>William S. Brown</u> FOR 12/12/08 STATEWIDE PLATTING SUPERVISOR DATE
SCALE: 1" = 2000'	CHECKED BY: KJL FILE NO.: ASLS 20060024

## INDEX SHEET

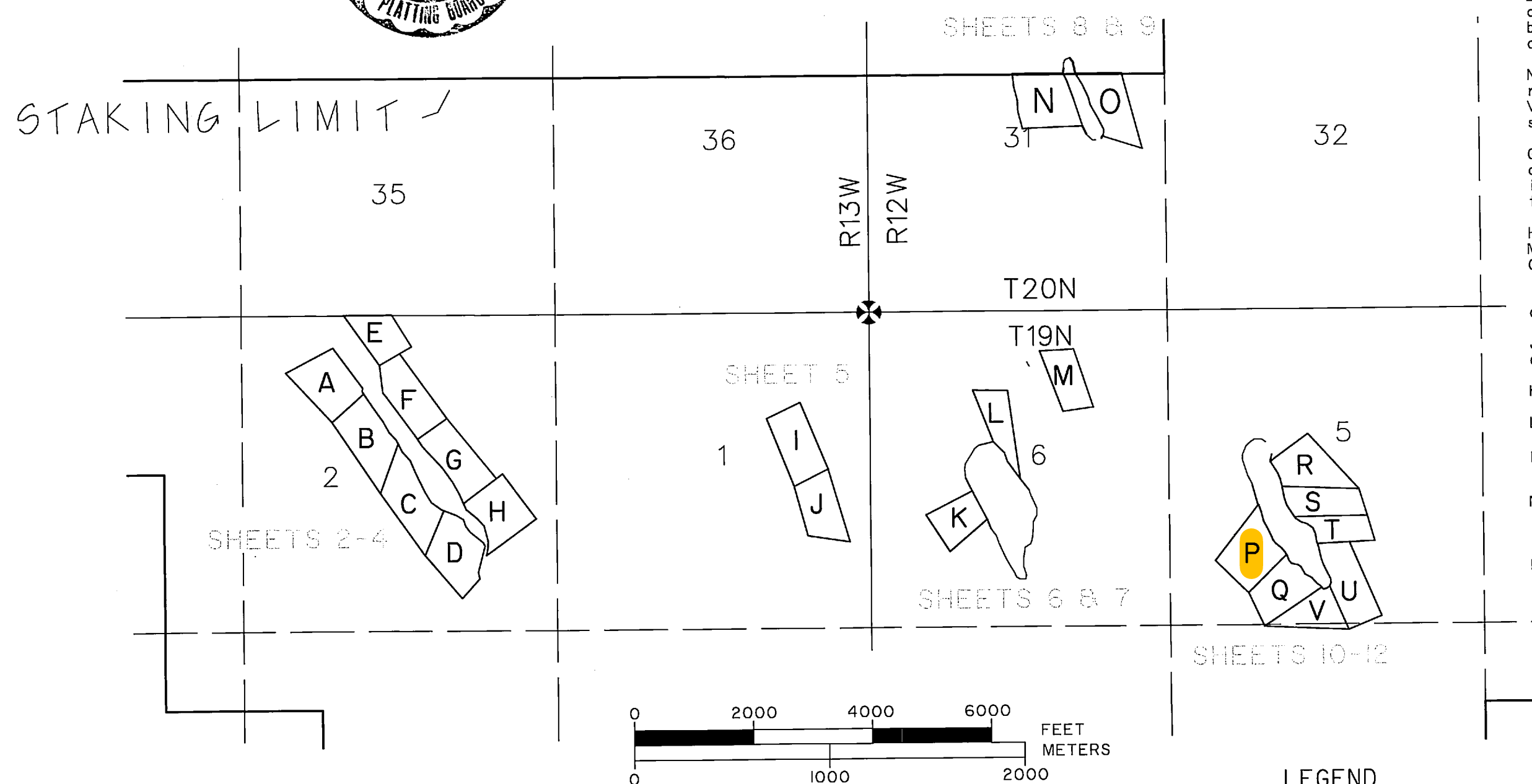

## SURVEYOR'S CERTIFICATE

I hereby certify that I am properly registered and licensed to practice land surveying in the State of Alaska, that this plat represents a survey made by me or under my direct supervision, that the monuments shown hereon exist as described, and that all dimensions and other details are correct.

Date: 20 October 2008 Registration No. LS-7045

James E. Mitchell  
James E. Mitchell, Registered Land Surveyor

## TYPICAL PRIMARY MONUMENT

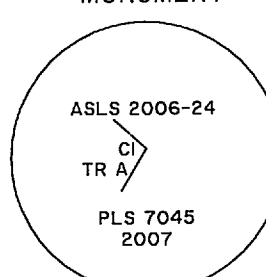

## LEGEND

- BLM/GLO Monument Recovered
- Primary monument set this survey
- Corner Designation
- Surveyed Line
- Unsurveyed Line

SHEET 1 of 13

ANCHORAGE RECORDING DISTRICT PL 2008-124

2007 Mean  
Magnetic  
Declination  
19 1/4° E.  
See Note H

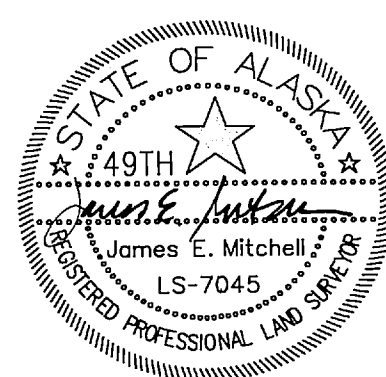

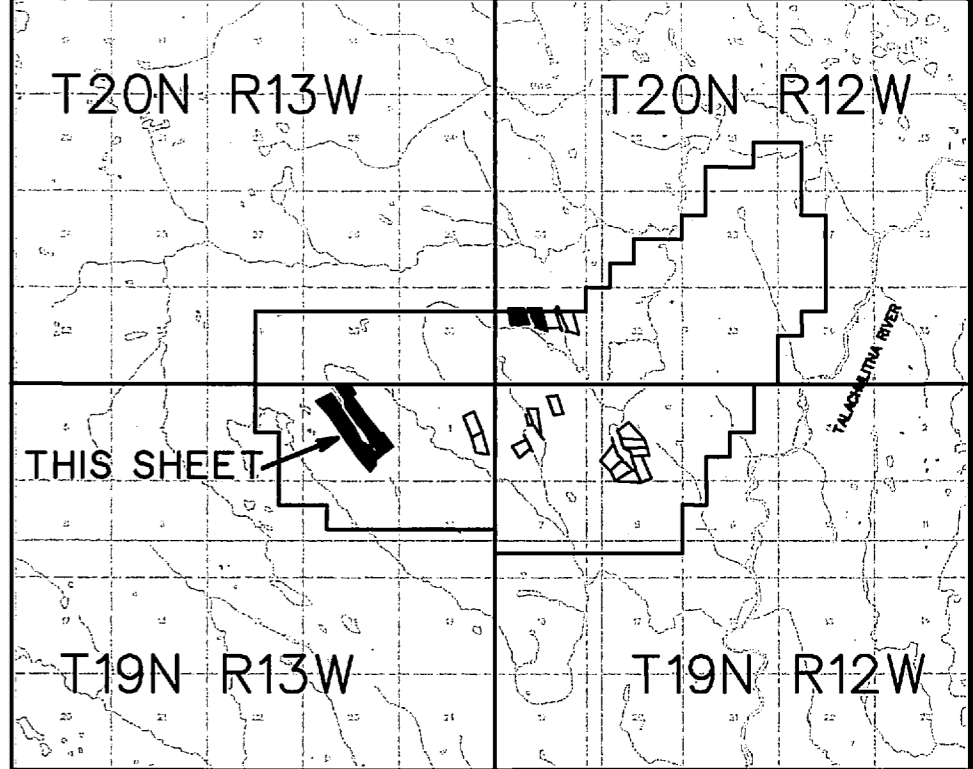
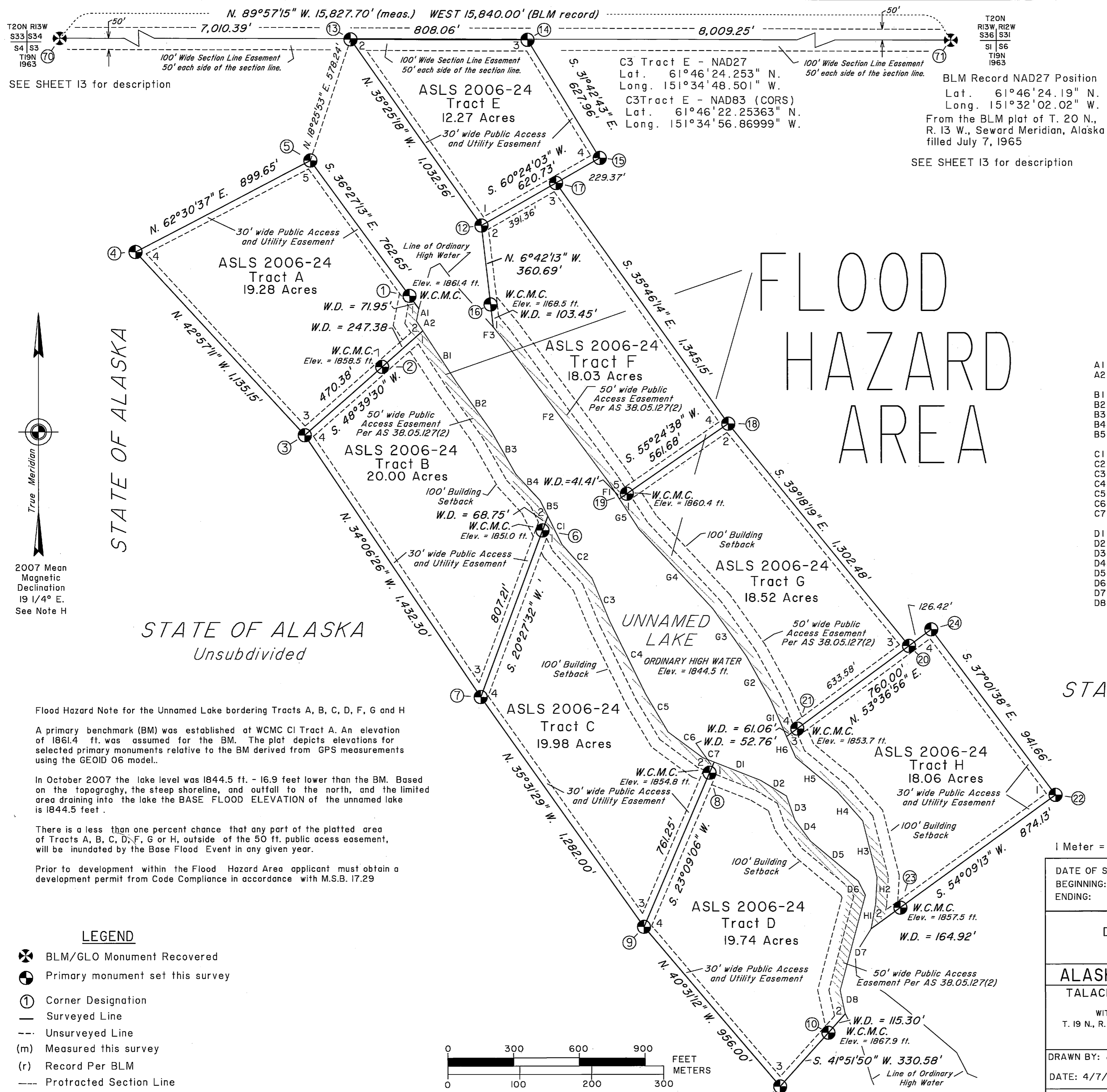

VICINITY MAP  
Source: USGS DLG TYONEK C4, C5, D4 and D5  
Scale 1" = 2 mile

A1 S. 10°58'11" W. 57.48'	F1 N. 33°02'17" W. 91.98'
A2 S. 33°28'15" E. 53.06'	F2 N. 36°36'27" W. 818.73'
B1 S. 33°28'08" E. 280.10'	F3 N. 39°46'54" W. 58.77'
B2 S. 35°45'50" E. 269.44'	G1 N. 23°39'29" W. 176.23'
B3 S. 29°47'19" E. 225.65'	G2 N. 28°54'57" W. 231.74'
B4 S. 42°48'59" E. 162.03'	G3 N. 35°23'47" W. 265.88'
B5 S. 26°34'47" E. 80.92'	G4 N. 43°04'11" W. 494.33'
C1 S. 26°34'47" E. 142.09'	G5 N. 33°02'17" W. 161.52'
C2 S. 41°57'41" E. 206.81'	H1 N. 10°27'14" E. 115.94'
C3 S. 22°35'50" E. 213.99'	H2 N. 3°10'01" E. 119.68'
C4 S. 26°14'20" E. 368.41'	H3 N. 14°19'28" W. 265.75'
C5 S. 30°51'34" E. 197.79'	H4 N. 41°30'08" W. 175.22'
C6 S. 53°40'05" E. 197.60'	H5 N. 50°34'09" W. 246.31'
C7 S. 68°43'07" E. 54.83'	H6 N. 23°39'29" W. 103.22'
D1 S. 68°41'35" E. 228.51'	
D2 S. 59°12'02" E. 136.48'	
D3 S. 19°14'55" E. 116.73'	
D4 S. 36°33'06" E. 117.55'	
D5 S. 50°15'56" E. 284.35'	
D6 S. 27°10'31" E. 72.64'	
D7 S. 14°54'45" W. 447.18'	
D8 S. 12°13'30" E. 109.56'	

Flood Hazard Note for the Unnamed Lake bordering Tracts A, B, C, D, F, G and H

A primary benchmark (BM) was established at WCMC CI Tract A. An elevation of 1861.4 ft. was assumed for the BM. The plat depicts elevations for selected primary monuments relative to the BM derived from GPS measurements using the GEOID 06 model.

In October 2007 the lake level was 1844.5 ft. - 16.9 feet lower than the BM. Based on the topography, the steep shoreline, and outfall to the north, and the limited area draining into the lake the BASE FLOOD ELEVATION of the unnamed lake is 1844.5 feet.

There is a less than one percent chance that any part of the platted area of Tracts A, B, C, D, F, G or H, outside of the 50 ft. public access easement, will be inundated by the Base Flood Event in any given year.

Prior to development within the Flood Hazard Area applicant must obtain a development permit from Code Compliance in accordance with M.S.B. 17.29

- LEGEND
- BLM/GLO Monument Recovered
  - Primary monument set this survey
  - Corner Designation
  - Surveyed Line
  - Unsurveyed Line
  - (m) Measured this survey
  - (r) Record Per BLM
  - Protracted Section Line
  - Flood Hazard Area

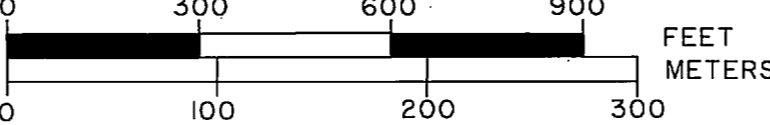

STATE OF ALASKA  
Unsubdivided

1 Meter = 3.280833 U.S. Survey Feet 1 U.S. acre = 0.4047 hectare

DATE OF SURVEY: BEGINNING: 10/04/2007 ENDING: 10/11/2007	NAME OF SURVEYOR: The Crazy Mountains JV 2000 E. Dowling Road, #6 Anchorage, AK 99507
STATE OF ALASKA DEPARTMENT OF NATURAL RESOURCES DIVISION OF MINING LAND AND WATER Anchorage, Alaska	
ALASKA STATE LAND SURVEY NO. 2006-24 TALACHULITNA WEST REMOTE RECREATIONAL CABIN SITES CREATING TRACTS A THROUGH V WITHIN PROTRACTED SECTION 31, T. 20 N., R. 12 W., SECTIONS 1 & 2, T. 19 N., R. 13 W., SECTIONS 5, 6 & 8, T. 19 N., R. 12 W., SEWARD MERIDIAN, ALASKA ANCHORAGE RECORDING DISTRICT Containing 361.30 Acres	
DRAWN BY: JEM DATE: 4/7/2008	APPROVAL RECOMMENDED W. Olson S. Plm 12/12/08 STATEWIDE PLATTING SUPERVISOR DATE
SCALE: 1" = 300'	CHECKED BY: KJL File No. ASLS 20060024



# APPLICANT CERTIFICATE

I, THE UNDERSIGNED, HEREBY CERTIFY THAT I AM THE APPLICANT OF TRACT A ASLS 2006-24, ADL 229555 AS SHOWN HEREON. I HEREBY APPROVE THIS SURVEY AND PLAT.

DATE: 10-30-08

Ruth E. Merriner

RUTH MERRINER  
10336 RIDGE PARK DRIVE  
ANCHORAGE, ALASKA 99507

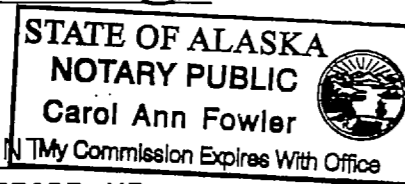

NOTARY'S ACKNOWLEDGEMENT  
SUBSCRIBED AND SWORN TO BEFORE ME  
THIS 30th DAY OF October, 2008

BY Ruth E. Merriner

Carol Ann Fowler  
NOTARY FOR THE STATE OF ALASKA  
MY COMMISSION EXPIRES with office

# APPLICANT CERTIFICATE

I, THE UNDERSIGNED, HEREBY CERTIFY THAT I AM THE APPLICANT OF TRACT B ASLS 2006-24, ADL 229556 AS SHOWN HEREON. I HEREBY APPROVE THIS SURVEY AND PLAT.

DATE: 30 OCT 2008

Scott L. Merriner

SCOTT MERRINER  
10336 RIDGE PARK DRIVE  
ANCHORAGE, ALASKA 99507

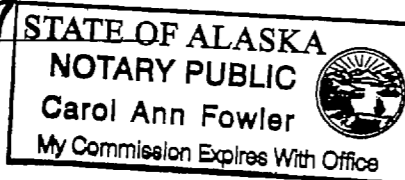

NOTARY'S ACKNOWLEDGEMENT  
SUBSCRIBED AND SWORN TO BEFORE ME  
THIS 30th DAY OF October, 2008

BY Scott L. Merriner

Carol Ann Fowler  
NOTARY FOR THE STATE OF ALASKA  
MY COMMISSION EXPIRES with office

# APPLICANT CERTIFICATE

I, THE UNDERSIGNED, HEREBY CERTIFY THAT I AM THE APPLICANT OF TRACT C ASLS 2006-24, ADL 229557 AS SHOWN HEREON. I HEREBY APPROVE THIS SURVEY AND PLAT.

DATE: 21 Nov 08

Charles Merriner

CHARLES MERRINER  
3934 APOLLO DRIVE  
ANCHORAGE, ALASKA 99504

NOTARY'S ACKNOWLEDGEMENT  
SUBSCRIBED AND SWORN TO BEFORE ME  
THIS 21 DAY OF November, 2008

BY Charles Merriner

Ronda Wilson  
NOTARY FOR THE STATE OF ALASKA  
MY COMMISSION EXPIRES with office

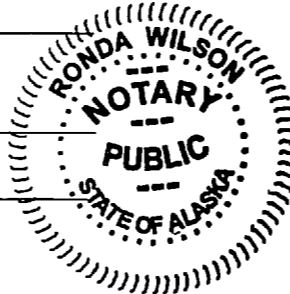

# APPLICANT CERTIFICATE

I, THE UNDERSIGNED, HEREBY CERTIFY THAT I AM THE APPLICANT OF TRACT D ASLS 2006-24, ADL 229560 AS SHOWN HEREON. I HEREBY APPROVE THIS SURVEY AND PLAT.

DATE: 11/21/2008

Carla Merriner

CARLA MERRINER  
3934 APOLLO DRIVE  
ANCHORAGE, ALASKA 99504

NOTARY'S ACKNOWLEDGEMENT  
SUBSCRIBED AND SWORN TO BEFORE ME  
THIS 21 DAY OF November, 2008

BY Carla Merriner

Ronda Wilson  
NOTARY FOR THE STATE OF ALASKA  
MY COMMISSION EXPIRES with office

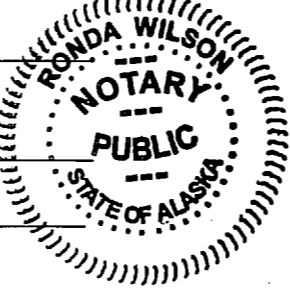

# APPLICANT CERTIFICATE

I, THE UNDERSIGNED, HEREBY CERTIFY THAT I AM THE APPLICANT OF TRACT E ASLS 2006-24, ADL 229681 AS SHOWN HEREON. I HEREBY APPROVE THIS SURVEY AND PLAT.

DATE: 11-20-08

Luke Merriner

LUKE MERRINER  
8600 SHEBANOF AVE.  
ANCHORAGE, ALASKA 99507

NOTARY'S ACKNOWLEDGEMENT  
SUBSCRIBED AND SWORN TO BEFORE ME  
THIS 20th DAY OF November, 2008

BY Luke Merriner

Joe P. / K  
NOTARY FOR THE STATE OF ALASKA  
MY COMMISSION EXPIRES with office

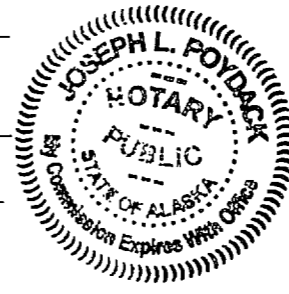

# APPLICANT CERTIFICATE

I, THE UNDERSIGNED, HEREBY CERTIFY THAT I AM THE APPLICANT OF TRACT F ASLS 2006-24, ADL 229558 AS SHOWN HEREON. I HEREBY APPROVE THIS SURVEY AND PLAT.

DATE: 10-30-08

Karl Clauson

KARL CLAUSON  
600 BARROW ST. #603  
ANCHORAGE, ALASKA 99501

NOTARY'S ACKNOWLEDGEMENT  
SUBSCRIBED AND SWORN TO BEFORE ME  
THIS 30 DAY OF OCTOBER, 2008

BY KARL CLAUSON

Joe P. / K  
NOTARY FOR THE STATE OF ALASKA  
MY COMMISSION EXPIRES with office

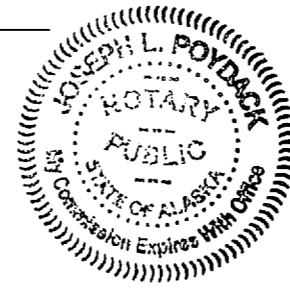

# APPLICANT CERTIFICATE

I, THE UNDERSIGNED, HEREBY CERTIFY THAT I AM THE APPLICANT OF TRACT G ASLS 2006-24, ADL 229554 AS SHOWN HEREON. I HEREBY APPROVE THIS SURVEY AND PLAT.

DATE: 12/10/08

Kathy Hurlburt

KATHY HURLBURT  
11601 BARR ROAD  
ANCHORAGE, ALASKA 99516

NOTARY'S ACKNOWLEDGEMENT  
SUBSCRIBED AND SWORN TO BEFORE ME  
THIS 10 DAY OF December, 2008

BY Kathy Hurlburt

Ronda Wilson  
NOTARY FOR THE STATE OF ALASKA  
MY COMMISSION EXPIRES with office

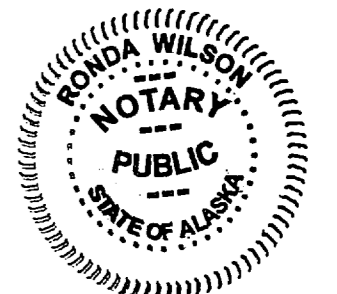

# APPLICANT CERTIFICATE

I, THE UNDERSIGNED, HEREBY CERTIFY THAT I AM THE APPLICANT OF TRACT H ASLS 2006-24, ADL 229574 AS SHOWN HEREON. I HEREBY APPROVE THIS SURVEY AND PLAT.

DATE: 11/07/2008

Jonathan Kincaid

JONATHAN KINCAID  
P.O. BOX 1090  
WILLOW, ALASKA 99688

NOTARY'S ACKNOWLEDGEMENT  
SUBSCRIBED AND SWORN TO BEFORE ME  
THIS 7 DAY OF November, 2008

BY JONATHAN KINCAID

Joe P. / K  
NOTARY FOR THE STATE OF ALASKA  
MY COMMISSION EXPIRES with office

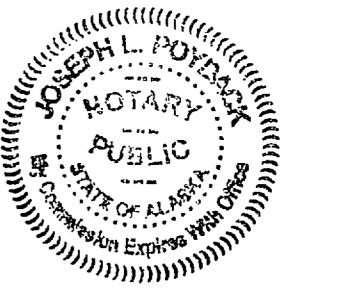

SHEET 4 of 13

1 Meter = 3.280833 U.S. Survey Feet 1 U.S. acre = 0.4047 hectare

DATE OF SURVEY: BEGINNING: 10/04/2007 ENDING: 10/11/2007		NAME OF SURVEYOR: The Crazy Mountains JV 2000 E. Dowling Road, #6 Anchorage, AK 99507	
STATE OF ALASKA DEPARTMENT OF NATURAL RESOURCES DIVISION OF MINING LAND AND WATER Anchorage, Alaska			
ALASKA STATE LAND SURVEY NO. 2006-24			
TALACHULITNA WEST REMOTE RECREATIONAL CABIN SITES CREATING TRACTS A THROUGH V WITHIN PROTRACTED SECTION 31, T. 20 N., R. 12 W., SECTIONS 1 & 2, T. 19 N., R. 13 W., SECTIONS 5, 6 & 8, T. 19 N., R. 12 W., SEWARD MERIDIAN., ALASKA ANCHORAGE RECORDING DISTRICT Containing 361.30 Acres			
DRAWN BY: JEM DATE: 4/7/2008		APPROVAL RECOMMENDED <u>William S. Brown</u> 12/12/08 STATEWIDE PLATTING SUPERVISOR DATE	
SCALE: 1" = 300'		CHECKED BY: KJL	File No. ASLS 20060024

ANCHORAGE RECORDING DISTRICT PL 2008-124

CITract I - NAD27  
Lat. 61°46'09.319" N.  
Long. 152°32'26.058" W.  
C2 Tract J - NAD83 (CORS)  
Lat. 61°46'07.31874" N.  
Long. 151°32'34.42319" W.

T20N  
R13W R12W  
S36 S31  
SI S6  
T19N  
1963

SEE SHEET 13  
for description  
BLM Record NAD27 Position  
Lat. 61°46'24.19" N.  
Long. 151°32'02.02" W.  
From the BLM plat of T. 20 N.,  
R. 13 W., Seward Meridian, Alaska  
filled July 7, 1965

#### APPLICANT CERTIFICATE

I, THE UNDERSIGNED, HEREBY CERTIFY THAT I AM THE  
APPLICANT OF TRACT I ASLS 2006-24, ADL 229532  
AS SHOWN HEREON. I HEREBY APPROVE THIS SURVEY  
AND PLAT.

DATE: 11-10-08

STEVEN FRY  
19121 LAKINA CIRCLE  
EAGLE RIVER, ALASKA 99577

#### NOTARY'S ACKNOWLEDGEMENT

SUBSCRIBED AND SWORN TO BEFORE ME  
THIS 10 DAY OF November, 2008

BY: STEVEN FRY

JOSEPH L. POYLAND  
NOTARY PUBLIC  
STATE OF ALASKA  
MY COMMISSION EXPIRES 11/01/2010

#### APPLICANT CERTIFICATE

I, THE UNDERSIGNED, HEREBY CERTIFY THAT I AM THE  
APPLICANT OF TRACT J ASLS 2006-24, ADL 229534  
AS SHOWN HEREON. I HEREBY APPROVE THIS SURVEY  
AND PLAT.

DATE: 11-14-08

WILLIAM STARR  
22707 COLUMBIA GLACIER  
EAGLE RIVER, ALASKA 99577

#### NOTARY'S ACKNOWLEDGEMENT

SUBSCRIBED AND SWORN TO BEFORE ME  
THIS 14 DAY OF November, 2008

BY: William Starr

NOTARY FOR THE STATE OF ALASKA  
MY COMMISSION EXPIRES with office

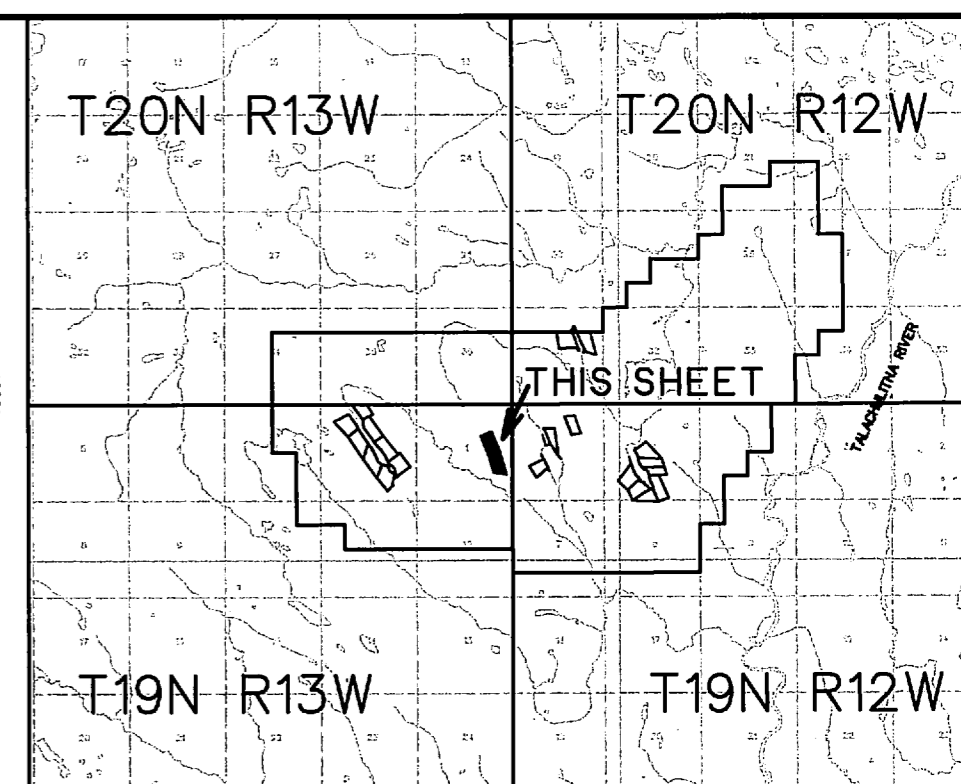

#### VICINITY MAP

Source: USGS DLG TYONEK C4, C5, D4 and D5  
Scale 1" = 2 mile

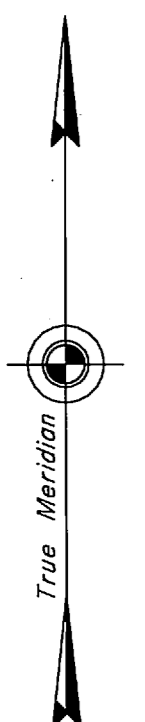

2007 Mean  
Magnetic  
Declination  
19 1/4° E.  
See Note H

ASLS 2006-24

Tract I  
17.66 Acres

STATE OF ALASKA  
Unsubdivided

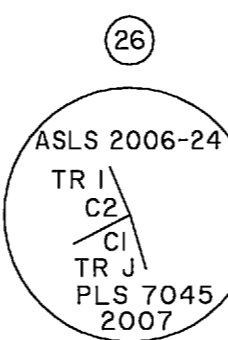
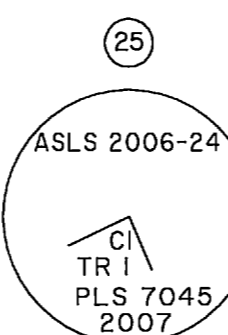

Set an alum. post, 30 ins. long, 2 1/2 ins. diam., 29 ins. in the ground, with alum. cap mkd. as shown. From which

A spruce, 9 ins. diam., bears S. 42 1/4° E., 33.4 ft. dist., mkd. X BT.

A steel rebar, 5/8 in. diam., 36 ins. long, driven 34 ins. in the ground with an alum. cap, 2 ins. diam., marked RM 1 25.0 ft., bears S. 45° W., 25.0 ft. dist.

Place a grey DEEP-I magnet at the base of the alum. post and an orange Carsonite witness post 1 ft. North of the corner.

Set an alum. post, 30 ins. long, 2 1/2 ins. diam., 29 ins. in the ground, with alum. cap mkd. as shown. From which

A steel rebar, 5/8 in. diam., 36 ins. long, driven 32 ins. in the ground with an alum. cap, 2 ins. diam., marked RM 2 25.0 ft., bears S. 45° W., 25.0 ft. dist.

A steel rebar, 5/8 in. diam., 36 ins. long, driven 32 ins. in the ground with an alum. cap, 2 ins. diam., marked RM 1 18.4 ft., bears N. 68 3/4° W., 18.4 ft. dist.

Place a grey DEEP-I magnet at the base of the alum. post and an orange Carsonite witness post 1 ft. North of the corner.

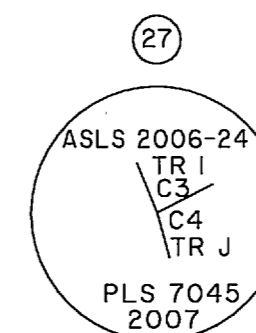

Set an alum. post, 30 ins. long, 2 1/2 ins. diam., 29 ins. in the ground, with alum. cap mkd. as shown. From which

A steel rebar, 5/8 in. diam., 36 ins. long, driven 34 ins. in the ground with an alum. cap, 2 ins. diam., marked RM 1 25.0 ft., bears N. 45° E., 25.0 ft. dist.

A steel rebar, 5/8 in. diam., 36 ins. long, driven 34 ins. in the ground with an alum. cap, 2 ins. diam., marked RM 2 25.0 ft., bears S. 45° E., 25.0 ft. dist.

Place a grey DEEP-I magnet at the base of the alum. post and an orange Carsonite witness post 1 ft. North of the corner.

Set an alum. post, 30 ins. long, 2 1/2 ins. diam., 29 ins. in the ground, with alum. cap mkd. as shown. From which

A steel rebar, 5/8 in. diam., 36 ins. long, driven 34 ins. in the ground with an alum. cap, 2 ins. diam., marked RM 1 25.0 ft., bears N. 45° E., 25.0 ft. dist.

A steel rebar, 5/8 in. diam., 36 ins. long, driven 34 ins. in the ground with an alum. cap, 2 ins. diam., marked RM 2 25.0 ft., bears S. 45° E., 25.0 ft. dist.

Place a grey DEEP-I magnet at the base of the alum. post and an orange Carsonite witness post 1 ft. North of the corner.

Set an alum. post, 30 ins. long, 2 1/2 ins. diam., 29 ins. in the ground, with alum. cap mkd. as shown. From which

A steel rebar, 5/8 in. diam., 36 ins. long, driven 34 ins. in the ground with an alum. cap, 2 ins. diam., marked RM 1 25.0 ft., bears N. 45 1/2° E., 25.0 ft. dist.

A steel rebar, 5/8 in. diam., 36 ins. long, driven 34 ins. in the ground with an alum. cap, 2 ins. diam., marked RM 2 25.0 ft., bears N. 48 1/2° W., 25.0 ft. dist.

Place a grey DEEP-I magnet at the base of the alum. post and an orange Carsonite witness post 1 ft. North of the corner.

Set an alum. post, 30 ins. long, 2 1/2 ins. diam., 29 ins. in the ground, with alum. cap mkd. as shown. From which

A steel rebar, 5/8 in. diam., 36 ins. long, driven 35 ins. in the ground with an alum. cap, 2 ins. diam., marked RM 1 25.0 ft., bears N. 45° E., 25.0 ft. dist.

A spruce, 15 ins. diam., bears S. 39 1/4° E., 145.2 ft. dist., mkd. X BT.

A spruce, 24 ins. diam., bears S. 87 1/2° W., 40.6 ft. dist., mkd. X BT.

Place a grey DEEP-I magnet at the base of the alum. post and an orange Carsonite witness post 1 ft. North of the corner.

1 Meter = 3.280833 U.S. Survey Feet 1 U.S. acre = 0.4047 hectare

DATE OF SURVEY:  
BEGINNING: 10/04/2007  
ENDING: 10/11/2007

NAME OF SURVEYOR:  
The Crazy Mountains JV  
2000 E. Dowling Road, #6  
Anchorage, AK 99507

STATE OF ALASKA  
DEPARTMENT OF NATURAL RESOURCES  
DIVISION OF MINING LAND AND WATER  
Anchorage, Alaska

ALASKA STATE LAND SURVEY NO. 2006-24

TALACHULITNA WEST REMOTE RECREATIONAL CABIN SITES  
CREATING TRACTS A THROUGH V  
WITHIN PROTRACTED SECTION 31, T. 20 N., R. 12 W., SECTIONS 1 & 2,  
T. 19 N., R. 13 W., SECTIONS 5, 6 & 8, T. 19 N., R. 12 W., SEWARD MERIDIAN, ALASKA  
ANCHORAGE RECORDING DISTRICT  
Containing 361.309 Acres

DRAWN BY: JEM

DATE: 4/7/2008

SCALE:  
1" = 200'

APPROVAL RECOMMENDED

FOR: STATEWIDE PLATTING SUPERVISOR DATE

CHECKED BY:  
KJL

File No.  
ASLS 20060024

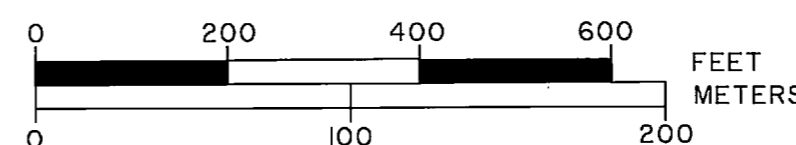

SHEET 5 of 13

ANCHORAGE RECORDING DISTRICT PL2008-124

#### LEGEND

- BLM/GLO Monument Recovered
- Primary monument set this survey
- Corner Designation
- Surveyed Line
- Unsurveyed Line
- (m) Measured this survey
- (r) Record Per BLM
- Protracted Section Line
- Flood Hazard Area

T20N  
R13W, R12W  
S36, S31  
SI S6  
T19N  
1963

SEE SHEET 13 for description

BLM Record NAD27 Position  
Lat. 61°46'24.19" N.  
Long. 151°32'02.02" W.  
From the BLM plat of T. 20 N.,  
R. 13 W., Seward Meridian, Alaska  
filled July 7, 1965

C2 Tract L - NAD27  
Lat. 61°46'11.097" N.  
Long. 151°31'25.590" W.  
C4 Tract C - NAD83 (CORS)  
Lat. 61°46'09.09661" N.  
Long. 151°31'33.95377" W.

STATE OF ALASKA  
Unsubdivided

ASLS 2006-24  
Tract L  
11.79 Acres

ASLS 2006-24  
Tract M  
12.73 Acres

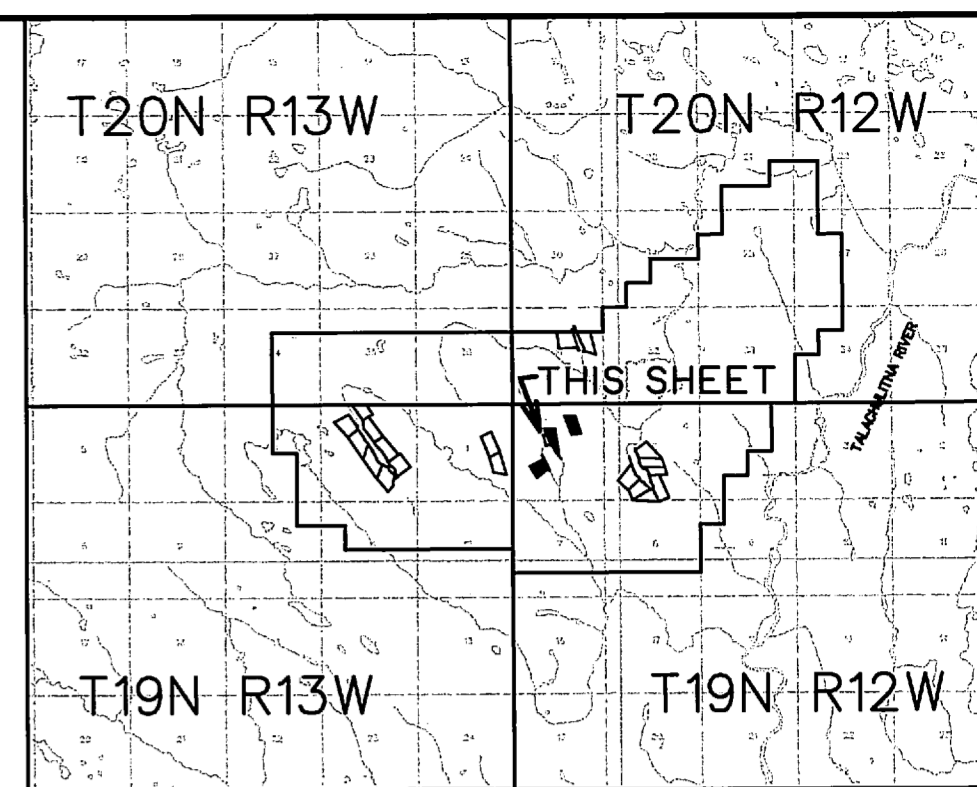

VICINITY MAP  
Source: USGS DLG TYONEK C4, C5, D4 and D5  
Scale 1" = 2 mile

LEGEND

- BLM/GLO Monument Recovered
- Primary monument set this survey
- Corner Designation
- Surveyed Line
- Unsurveyed Line
- (m) Measured this survey
- (r) Record Per BLM
- Protracted Section Line
- Flood Hazard Area

True Meridian

2007 Mean  
Magnetic  
Declination  
19 1/4° E.  
See Note H

STATE OF ALASKA  
Unsubdivided

ASLS 2006-24  
Tract K  
12.25 Acres

UNNAMED LAKE  
ORDINARY HIGH WATER  
Elev. = 1175 ft.

FLOOD  
HAZARD  
AREA

SHEET 6 of 13

STATE OF ALASKA  
Unsubdivided

Flood Hazard Note for the Unnamed Lake bordering Tracts K and L.

A primary benchmark (BM) was established at WCMC C2 Tract K. An elevation of 1181.4 ft. was assumed for the BM. The plat depicts elevations for selected primary monuments relative to the BM derived from GPS measurements using the GEOID 06 model.

In October 2007 the lake level was 1175 ft. - 6.4 feet lower than the BM. Based on the topography and outfall to the southeast, and the limited area draining into the lake the BASE FLOOD ELEVATION of the unnamed lake is 1176 feet.

Tracts K and L. There is a less than one percent chance that any part of the platted area of Tracts K or L, outside of the 100 ft. building setback, will be inundated by the Base Flood Event in any given year.

Prior to development within the Flood Hazard Area applicant must obtain a development permit from Code Compliance in accordance with M.S.B. 17.29



1 Meter = 3.280833 U.S. Survey Feet 1 U.S. acre = 0.4047 hectare

DATE OF SURVEY: BEGINNING: 10/04/2007 ENDING: 10/11/2007	NAME OF SURVEYOR: The Crazy Mountains JV 2000 E. Dowling Road, #6 Anchorage, AK 99507
STATE OF ALASKA DEPARTMENT OF NATURAL RESOURCES DIVISION OF MINING LAND AND WATER Anchorage, Alaska	
ALASKA STATE LAND SURVEY NO. 2006-24 TALACHULITNA WEST REMOTE RECREATIONAL CABIN SITES CREATING TRACTS A THROUGH V WITHIN PROTRACTED SECTION 31, T. 20 N., R. 12 W., SECTIONS 1 & 2, T. 19 N., R. 13 W., SECTIONS 5, 6 & 8, T. 19 N., R. 12 W., SEWARD MERIDIAN, ALASKA ANCHORAGE RECORDING DISTRICT Containing 361.30 Acres	
DRAWN BY: JEM DATE: 4/7/2008	APPROVAL RECOMMENDED William S. Brown 12/12/08 STATEWIDE PLATTING SUPERVISOR DATE
SCALE: 1" = 200'	CHECKED BY: KJL FILE NO.: ASLS 20060024

ANCHORAGE RECORDING DISTRICT PL 2008-124

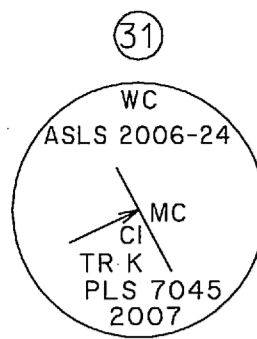

31 Set an alum. post, 30 ins. long, 2 1/2 ins. diam., 29 ins. in the ground, with alum. cap mkd. as shown.

From which

A spruce, 5 ins. diam., bears S. 49 1/2° E., 34.7 ft. dist., mkd. X BT.

A spruce, 19 ins. diam., bears S. 51° W., 42.3 ft. dist., mkd. X BT.

A spruce, 16 ins. diam., bears N. 55° W., 41.4 ft. dist., mkd. X BT.

Place a grey DEEP-I magnet at the base of the alum. post and an orange Carsonite witness post 1 ft. North of the corner.

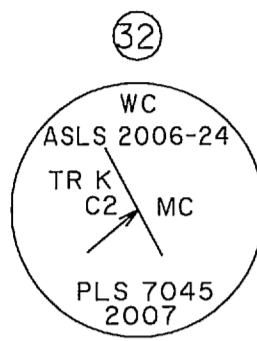

32 Set an alum. post, 30 ins. long, 2 1/2 ins. diam., 29 ins. in the ground, with alum. cap mkd. as shown.

From which

A steel rebar, 5/8 in. diam., 36 ins. long, driven 34 ins. in the ground with an alum. cap, 2 ins. diam., marked RM 1 25.0 ft., bears S. 38 1/4° W., 25.0 ft. dist.

A steel rebar, 5/8 in. diam., 36 ins. long, driven 34 ins. in the ground with an alum. cap, 2 ins. diam., marked RM 2 25.0 ft., bears N. 50° W., 25.0 ft. dist.

Place a grey DEEP-I magnet at the base of the alum. post and an orange Carsonite witness post 1 ft. North of the corner.



33 Set an alum. post, 30 ins. long, 2 1/2 ins. diam., 29 ins. in the ground, with alum. cap mkd. as shown.

From which

A spruce, 15 ins. diam., bears N. 72 1/2° E., 20.5 ft. dist., mkd. X BT.

A spruce, 12 ins. diam., bears S. 75° E., 39.8 ft. dist., mkd. X BT.

A spruce, 14 ins. diam., bears N. 61 1/2° W., 20.7 ft. dist., mkd. X BT.

Place a grey DEEP-I magnet at the base of the alum. post and an orange Carsonite witness post 1 ft. North of the corner.

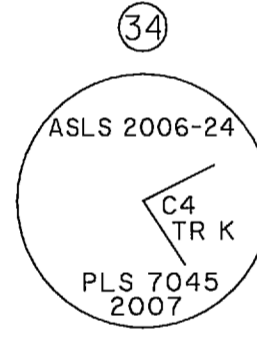

34 Set an alum. post, 30 ins. long, 2 1/2 ins. diam., 29 ins. in the ground, with alum. cap mkd. as shown.

From which

A steel rebar, 5/8 in. diam., 36 ins. long, driven 34 ins. in the ground with an alum. cap, 2 ins. diam., marked RM 1 25.0 ft., bears N. 69° E., 25.0 ft. dist.

A steel rebar, 5/8 in. diam., 36 ins. long, driven 30 ins. in the ground with an alum. cap, 2 ins. diam., marked RM 2 25.0 ft., bears S. 4 1/4° E., 25.0 ft. dist.

Place a grey DEEP-I magnet at the base of the alum. post and an orange Carsonite witness post 1 ft. North of the corner.

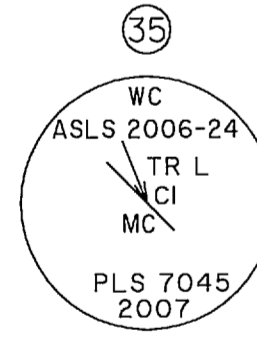

35 Set an alum. post, 30 ins. long, 2 1/2 ins. diam., 29 ins. in the ground, with alum. cap mkd. as shown.

From which

A spruce, 9 ins. diam., bears N. 3/4° E., 92.0 ft. dist., mkd. X BT.

A spruce, 12 ins. diam., bears S. 61° E., 15.9 ft. dist., mkd. X BT.

A spruce, 5 ins. diam., bears N. 25 1/2° W., 69.4 ft. dist., mkd. X BT.

Place a grey DEEP-I magnet at the base of the alum. post and an orange Carsonite witness post 1 ft. North of the corner.

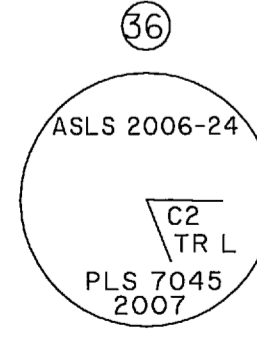

36 Set an alum. post, 30 ins. long, 2 1/2 ins. diam., 29 ins. in the ground, with alum. cap mkd. as shown.

From which

A spruce, 8 ins. diam., bears N. 63 1/4° E., 70.8 ft. dist., mkd. X BT.

A spruce, 12 ins. diam., bears S. 14° W., 81.3 ft. dist., mkd. X BT.

A spruce, 10 ins. diam., bears N. 74 1/4° W., 70.8 ft. dist., mkd. X BT.

Place a grey DEEP-I magnet at the base of the alum. post and an orange Carsonite witness post 1 ft. North of the corner.

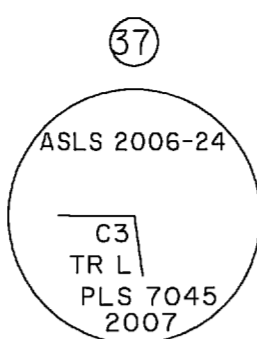

37 Set an alum. post, 30 ins. long, 2 1/2 ins. diam., 26 ins. in the ground, with alum. cap mkd. as shown.

From which

A spruce, 8 ins. diam., bears N. 61° E., 23.7 ft. dist., mkd. X BT.

A spruce, 15 ins. diam., bears S. 13° E., 88.6 ft. dist., mkd. X BT.

A spruce, 20 ins. diam., bears N. 87 1/2° W., 145.2 ft. dist., mkd. X BT.

Place a grey DEEP-I magnet at the base of the alum. post and an orange Carsonite witness post 1 ft. North of the corner.

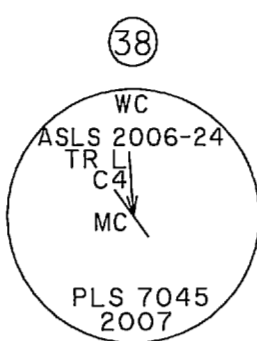

38 Set an alum. post, 30 ins. long, 2 1/2 ins. diam., 28 ins. in the ground, with alum. cap mkd. as shown.

From which

A spruce, 14 ins. diam., bears N. 31 1/2° E., 24.2 ft. dist., mkd. X BT.

A spruce, 6 ins. diam., bears S. 34° E., 36.4 ft. dist., mkd. X BT.

A spruce, 12 ins. diam., bears N. 29 1/2° W., 16.6 ft. dist., mkd. X BT.

Place a grey DEEP-I magnet at the base of the alum. post and an orange Carsonite witness post 1 ft. North of the corner.

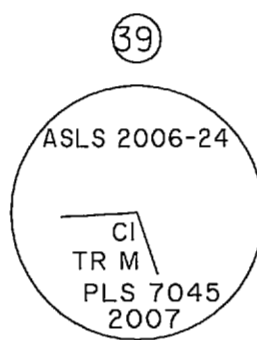

39 Set an alum. post, 30 ins. long, 2 1/2 ins. diam., 28 ins. in the ground, with alum. cap mkd. as shown.

From which

A steel rebar, 5/8 in. diam., 36 ins. long, driven 33 ins. in the ground with an alum. cap, 2 ins. diam., marked RM 1 25.0 ft., bears S. 79 1/2° E., 25.0 ft. dist.

A spruce, 7 ins. diam., bears S. 29° E., 32.1 ft. dist., mkd. X BT.

Place a grey DEEP-I magnet at the base of the alum. post and an orange Carsonite witness post 1 ft. North of the corner.

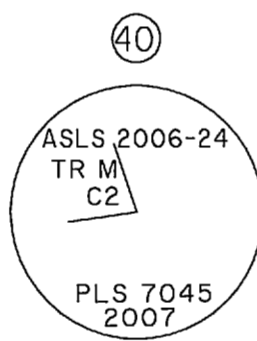

40 Set an alum. post, 30 ins. long, 2 1/2 ins. diam., 29 ins. in the ground, with alum. cap mkd. as shown.

From which

A steel rebar, 5/8 in. diam., 36 ins. long, driven 33 ins. in the ground with an alum. cap, 2 ins. diam., marked RM 2 25.0 ft., bears S. 47 1/4° E., 25.0 ft. dist.

A steel rebar, 5/8 in. diam., 36 ins. long, driven 33 ins. in the ground with an alum. cap, 2 ins. diam., marked RM 1 25.0 ft., bears S. 48 1/2° W., 25.0 ft. dist.

A spruce, 9 ins. diam., bears N. 46° W., 55.9 ft. dist., mkd. X BT.

Place a grey DEEP-I magnet at the base of the alum. post and an orange Carsonite witness post 1 ft. North of the corner.

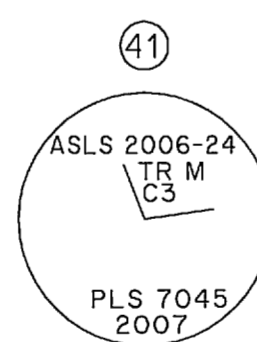

41 Set an alum. post, 30 ins. long, 2 1/2 ins. diam., 29 ins. in the ground, with alum. cap mkd. as shown.

From which

A steel rebar, 5/8 in. diam., 36 ins. long, driven 33 ins. in the ground with an alum. cap, 2 ins. diam., marked RM 1 25.0 ft., bears N. 10 1/2° E., 25.0 ft. dist.

A spruce, 14 ins. diam., bears N. 87° E., 62.1 ft. dist., mkd. X BT.

A spruce, 9 ins. diam., bears N. 57 1/2° W., 59.2 ft. dist., mkd. X BT.

Place a grey DEEP-I magnet at the base of the alum. post and an orange Carsonite witness post 1 ft. North of the corner.

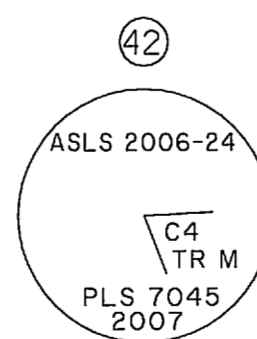

42 Set an alum. post, 30 ins. long, 2 1/2 ins. diam., 28 ins. in the ground, with alum. cap mkd. as shown.

From which

A steel rebar, 5/8 in. diam., 36 ins. long, driven 33 ins. in the ground with an alum. cap, 2 ins. diam., marked RM 1 25.0 ft., bears N. 51 1/2° E., 25.0 ft. dist.

A spruce, 6 ins. diam., bears S. 37 1/2° W., 20.7 ft. dist., mkd. X BT.

A spruce, 9 ins. diam., bears N. 56 1/2° W., 69.6 ft. dist., mkd. X BT.

Place a grey DEEP-I magnet at the base of the alum. post and an orange Carsonite witness post 1 ft. North of the corner.

# APPLICANT CERTIFICATE

I, THE UNDERSIGNED, HEREBY CERTIFY THAT I AM THE APPLICANT OF TRACT K ASLS 2006-24, ADL 229533 AS SHOWN HEREON. I HEREBY APPROVE THIS SURVEY AND PLAT.

DATE: 11-14-08  
*Jacquelyn Starr*  
 JACQUELYN STARR  
 22707 COLUMBIA GLACIER  
 EAGLE RIVER, ALASKA 99577



NOTARY'S ACKNOWLEDGEMENT  
 SUBSCRIBED AND SWORN TO BEFORE ME  
 THIS 14 DAY OF November, 2008

BY: *Jacquelyn Starr*

*Notary Signature*  
 NOTARY FOR THE STATE OF ALASKA  
 MY COMMISSION EXPIRES with office

# APPLICANT CERTIFICATE

I, THE UNDERSIGNED, HEREBY CERTIFY THAT I AM THE APPLICANT OF TRACT L ASLS 2006-24, ADL 229592 AS SHOWN HEREON. I HEREBY APPROVE THIS SURVEY AND PLAT.

DATE: 11-17-08  
*Loretta May Wiffler*  
 LORETTA MAY WIFFLER  
 P.O. BOX 1012  
 WILLOW, ALASKA 99688

NOTARY'S ACKNOWLEDGEMENT  
 SUBSCRIBED AND SWORN TO BEFORE ME  
 THIS 17 DAY OF November, 2008

BY: *Loretta May Wiffler*

*Notary Signature*  
 NOTARY FOR THE STATE OF ALASKA  
 MY COMMISSION EXPIRES with office



THERE IS NO APPLICANT FOR TRACT M (ADL 229758)

1 Meter = 3.280833 U.S. Survey Feet 1 U.S. acre = 0.4047 hectare

DATE OF SURVEY: BEGINNING: 10/04/2007 ENDING: 10/11/2007		NAME OF SURVEYOR: The Crazy Mountains JV 2000 E. Dowling Road, #6 Anchorage, AK 99507	
STATE OF ALASKA DEPARTMENT OF NATURAL RESOURCES DIVISION OF MINING LAND AND WATER Anchorage, Alaska			
ALASKA STATE LAND SURVEY NO. 2006-24 TALACHULITNA WEST REMOTE RECREATIONAL CABIN SITES CREATING TRACTS A THROUGH V WITHIN PROTRACTED SECTION 31, T. 20 N., R. 12 W., SECTIONS 1 & 2, T. 19 N., R. 13 W., SECTIONS 5, 6 & 8, T. 19 N., R. 12 W., SEWARD MERIDIAN, ALASKA ANCHORAGE RECORDING DISTRICT Containing 361.30 Acres			
DRAWN BY: JEM DATE: 4/7/2008		APPROVAL RECOMMENDED <i>William S. Brown</i> 12/12/08 STATEWIDE PLATTING SUPERVISOR DATE	
SCALE: 1" = 200'		CHECKED BY: KJL	File No. ASLS 20060024

N1 S. 24°56'18" E. 150.31'  
 N2 S. 19°50'03" E. 339.01'  
 N3 S. 18°11'37" E. 448.40'  
 N4 N. 13°53'26" W. 293.56'  
 N5 N. 2°32'50" W. 196.34'  
 N6 N. 15°26'02" W. 222.89'  
 N7 N. 6°09'28" W. 226.93'  
 O1 N. 1°34'51" E. 6.36'  
 O2 N. 30°42'26" E. 29.78'  
 O3 N. 3°09'06" E. 69.95'  
 O4 N. 26°08'03" W. 215.62'  
 O5 N. 29°28'34" W. 252.87'  
 O6 N. 14°20'23" W. 126.12'  
 O7 N. 24°58'57" W. 237.33'  
 O8 N. 31°29'32" W. 179.42'  
 O9 N. 26°05'10" W. 53.30'

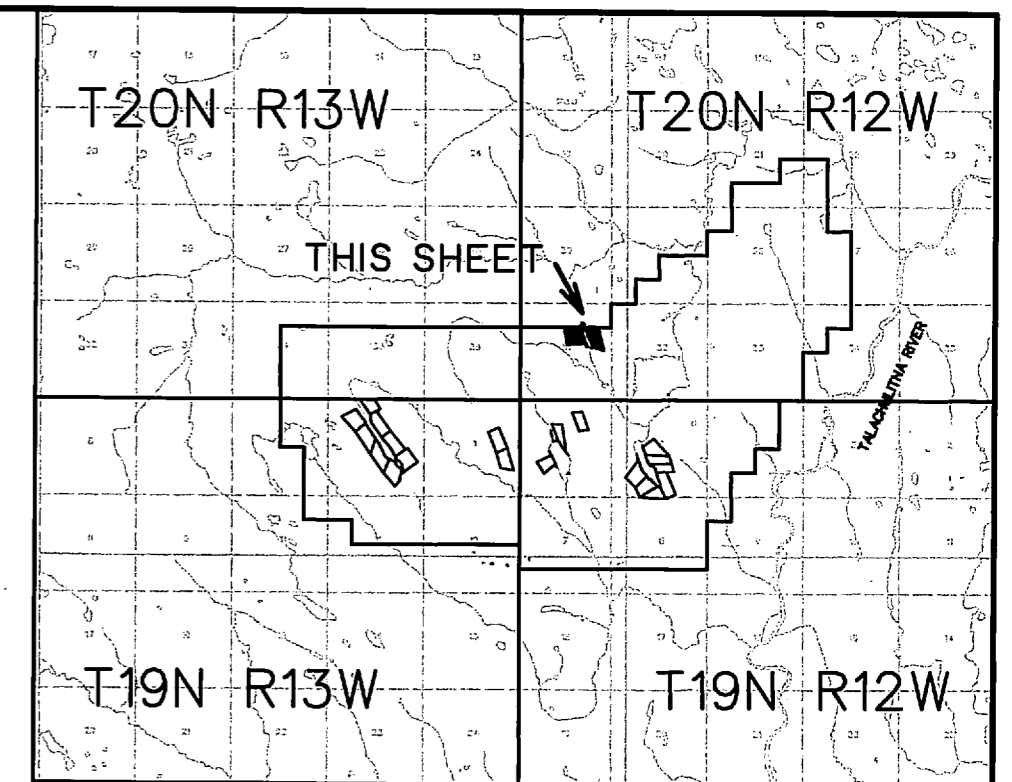

**VICINITY MAP**  
 Source: USGS DLG TYONEK C4, C5, D4 and D5  
 Scale 1" = 2 mile

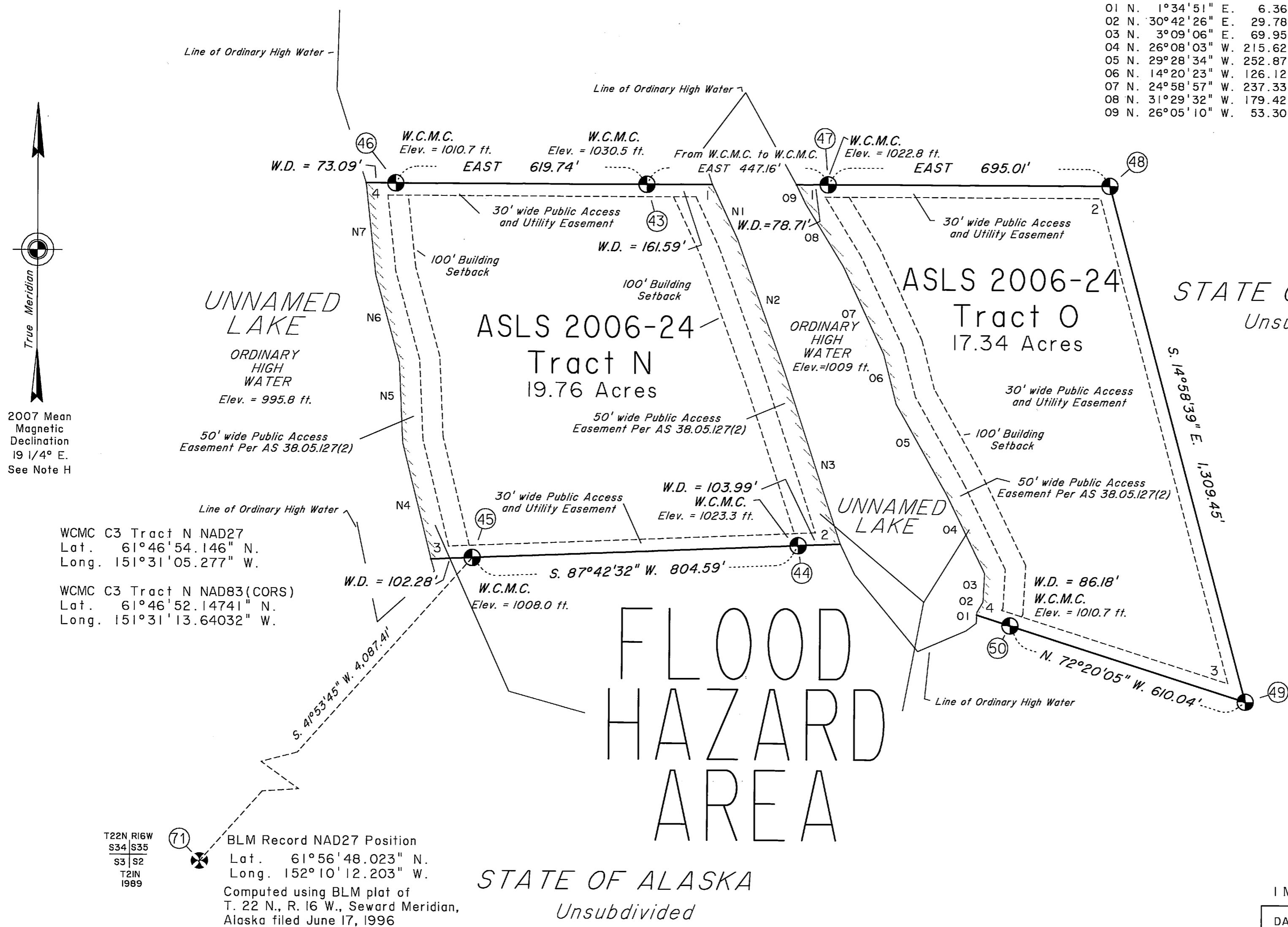

WCMC C3 Tract N NAD27  
 Lat. 61°46'54.146" N.  
 Long. 151°31'05.277" W.  
 WCMC C3 Tract N NAD83(CORS)  
 Lat. 61°46'52.14741" N.  
 Long. 151°31'13.64032" W.

T22N R16W  
 S34 S35  
 S3 S2  
 T21N  
 1989  
 BLM Record NAD27 Position  
 Lat. 61°56'48.023" N.  
 Long. 152°10'12.203" W.  
 Computed using BLM plat of  
 T. 22 N., R. 16 W., Seward Meridian,  
 Alaska filed June 17, 1996

Flood Hazard Note for the Unnamed Lake on the west side of Tract N.

A primary benchmark (BM) was established at WCMC C4 Tract N. An elevation of 1010.7 ft. was assumed for the BM. The plat depicts elevations for selected primary monuments relative to the BM derived from GPS measurements using the GEOID 06 model.

In October 2007 the lake level was 995.8 ft. - 14.9 feet lower than the BM. Based on the topography and outfall to the southeast, and the limited area draining into the lake the BASE FLOOD ELEVATION of the unnamed lake is 996 feet.

West Boundary of Tract N There is a less than one percent chance that any part of the platted area of the west boundary of Tract N, outside of the 50 ft. public access easement, will be inundated by the Base Flood Event in any given year.

Prior to development within the Flood Hazard Area applicant must obtain a development permit from Code Compliance in accordance with M.S.B. 17.29

Flood Hazard Note for the Unnamed Lake between Tracts N and O.

A primary benchmark (BM) was established at WCMC C1 Tract N. An elevation of 1030.5 ft. was assumed for the BM. The plat depicts elevations for selected primary monuments relative to the BM derived from GPS measurements using the GEOID 06 model.

In October 2007 the lake level was 1009 ft. - 21.5 feet lower than the BM. Based on the topography and outfall to the southeast, and the limited area draining into the lake the BASE FLOOD ELEVATION of the unnamed lake is 1009 feet.

West Boundary of Tract N There is a less than one percent chance that any part of the platted area of the east boundary of Tract N, and the west boundary of Tract O, outside of the 50 ft. public access easement, will be inundated by the Base Flood Event in any given year.

Prior to development within the Flood Hazard Area applicant must obtain a development permit from Code Compliance in accordance with M.S.B. 17.29

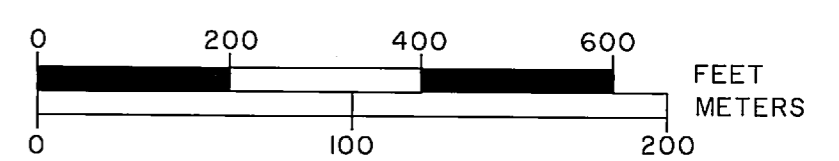

1 Meter = 3.280833 U.S. Survey Feet 1 U.S. acre = 0.4047 hectare

DATE OF SURVEY: BEGINNING: 10/04/2007 ENDING: 10/11/2007		NAME OF SURVEYOR: The Crazy Mountains JV 2000 E. Dowling Road, #6 Anchorage, AK 99507	
STATE OF ALASKA DEPARTMENT OF NATURAL RESOURCES DIVISION OF MINING LAND AND WATER Anchorage, Alaska			
<b>ALASKA STATE LAND SURVEY NO. 2006-24</b> TALACHULITNA WEST REMOTE RECREATIONAL CABIN SITES CREATING TRACTS A THROUGH V WITHIN PROTRACTED SECTION 31, T. 20 N., R. 12 W., SECTIONS 1 & 2, T. 19 N., R. 13 W., SECTIONS 5, 6 & 8, T. 19 N., R. 12 W., SEWARD MERIDIAN, ALASKA ANCHORAGE RECORDING DISTRICT Containing 361.30 Acres			
DRAWN BY: JEM DATE: 4/7/2008		APPROVAL RECOMMENDED William S. Brown 12/12/08 STATEWIDE PLATTING SUPERVISOR DATE	
SCALE: 1" = 200'		CHECKED BY: KJL File No. ASLS 20060024	

ANCHORAGE RECORDING DISTRICT PL 2008-124

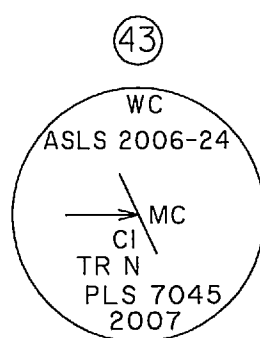

Set an alum. post, 30 ins. long, 2 1/2 ins. diam., 28 ins. in the ground, with alum. cap mkd. as shown.

From which

A birch, 14 ins. diam., bears N. 80° E., 19.2 ft. dist., mkd. X BT.

A steel rebar, 5/8 in. diam., 36 ins. long, driven 33 ins. in the ground with an alum. cap, 2 ins. diam., marked RM 1 25.0 ft., bears West, 25.0 ft. dist.

A spruce, 13 ins. diam., bears N. 6 1/2° W., 109.9 ft. dist., mkd. X BT.

Place a grey DEEP-I magnet at the base of the alum. post and an orange Carsonite witness post 1 ft. North of the corner.

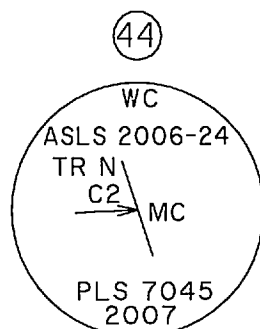

Set an alum. post, 30 ins. long, 2 1/2 ins. diam., 28 ins. in the ground, with alum. cap mkd. as shown.

From which

A spruce, 15 ins. diam., bears N. 29° E., 55.9 ft. dist., mkd. X BT.

A steel rebar, 5/8 in. diam., 36 ins. long, driven 33 ins. in the ground with an alum. cap, 2 ins. diam., marked RM 1 25.0 ft., bears S. 24° E., 25.0 ft. dist.

A spruce, 22 ins. diam., bears S. 69° W., 99.1 ft. dist., mkd. X BT.

Place a grey DEEP-I magnet at the base of the alum. post and an orange Carsonite witness post 1 ft. North of the corner.

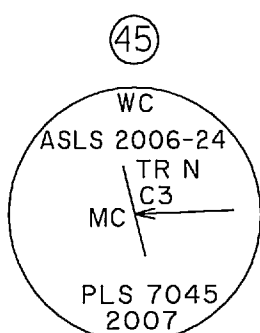

Set an alum. post, 30 ins. long, 2 1/2 ins. diam., 28 ins. in the ground, with alum. cap mkd. as shown.

From which

A spruce, 16 ins. diam., bears N. 61° E., 58.6 ft. dist., mkd. X BT.

A spruce, 15 ins. diam., bears S. 46° E., 38.2 ft. dist., mkd. X BT.

A steel rebar, 5/8 in. diam., 36 ins. long, driven 33 ins. in the ground with an alum. cap, 2 ins. diam., marked RM 1 25.0 ft., bears N. 23 1/2° W., 25.0 ft. dist.

Place a grey DEEP-I magnet at the base of the alum. post and an orange Carsonite witness post 1 ft. North of the corner.

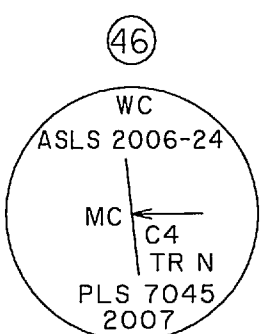

Set an alum. post, 30 ins. long, 2 1/2 ins. diam., 29 ins. in the ground, with alum. cap mkd. as shown.

From which

A spruce, 13 ins. diam., bears N. 44° E., 9.9 ft. dist., mkd. X BT.

A spruce, 6 ins. diam., bears N. 76 1/4° E., 64.1 ft. dist., mkd. X BT.

A spruce, 14 ins. diam., bears S. 77 3/4° W., 29.5 ft. dist., mkd. X BT.

Place a grey DEEP-I magnet at the base of the alum. post and an orange Carsonite witness post 1 ft. North of the corner.

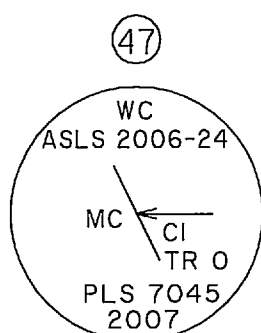

Set an alum. post, 30 ins. long, 2 1/2 ins. diam., 29 ins. in the ground, with alum. cap mkd. as shown.

From which

A spruce, 9 ins. diam., bears N. 10 1/2° E., 107.9 ft. dist., mkd. X BT.

A steel rebar, 5/8 in. diam., 36 ins. long, driven 33 ins. in the ground with an alum. cap, 2 ins. diam., marked RM 1 25.0 ft., bears East, 25.0 ft. dist.

A spruce, 6 ins. diam., bears S. 14° E., 50.6 ft. dist., mkd. X BT.

Place a grey DEEP-I magnet at the base of the alum. post and an orange Carsonite witness post 1 ft. North of the corner.

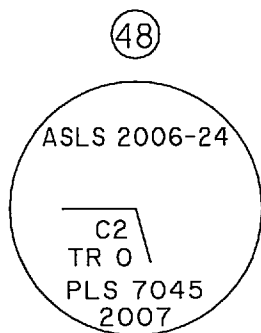

Set an alum. post, 30 ins. long, 2 1/2 ins. diam., 29 ins. in the ground, with alum. cap mkd. as shown.

From which

A spruce, 14 ins. diam., bears N. 41 1/2° E., 36.3 ft. dist., mkd. X BT.

A spruce, 11 ins. diam., bears S. 71 1/2° W., 18.0 ft. dist., mkd. X BT.

A spruce, 14 ins. diam., bears N. 68° W., 30.0 ft. dist., mkd. X BT.

Place a grey DEEP-I magnet at the base of the alum. post and an orange Carsonite witness post 1 ft. North of the corner.

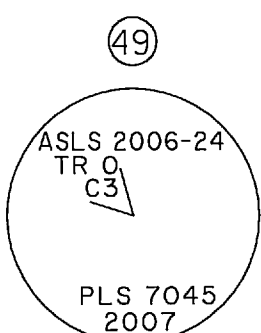

Set an alum. post, 30 ins. long, 2 1/2 ins. diam., 28 ins. in the ground, with alum. cap mkd. as shown.

From which

A spruce, 8 ins. diam., bears N. 86° E., 13.9 ft. dist., mkd. X BT.

A spruce, 13 ins. diam., bears S. 34 1/2° W., 58.9 ft. dist., mkd. X BT.

A spruce, 10 ins. diam., bears N. 25° W., 56.0 ft. dist., mkd. X BT.

Place a grey DEEP-I magnet at the base of the alum. post and an orange Carsonite witness post 1 ft. North of the corner.

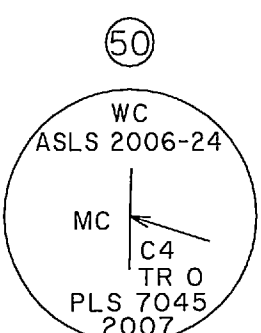

Set an alum. post, 30 ins. long, 2 1/2 ins. diam., 28 ins. in the ground, with alum. cap mkd. as shown.

From which

A spruce, 7 ins. diam., bears N. 11 1/2° E., 22.9 ft. dist., mkd. X BT.

A spruce, 7 ins. diam., bears N. 86° E., 19.5 ft. dist., mkd. X BT.

A spruce, 11 ins. diam., bears S. 10° W., 25.1 ft. dist., mkd. X BT.

Place a grey DEEP-I magnet at the base of the alum. post and an orange Carsonite witness post 1 ft. North of the corner.

# APPLICANT CERTIFICATE

I, THE UNDERSIGNED, HEREBY CERTIFY THAT I AM THE APPLICANT OF TRACT N, ASLS 2006-24, ADL 229752 AS SHOWN HEREON. I HEREBY APPROVE THIS SURVEY AND PLAT.

DATE: 10-28-2008

Woodsen Saunders  
WOODSEN SAUNDERS  
6400 WOODMONT DRIVE  
ANCHORAGE, ALASKA 99516-1890

## NOTARY'S ACKNOWLEDGEMENT

SUBSCRIBED AND SWORN TO BEFORE ME  
THIS 28 DAY OF OCTOBER, 2008

BY WOODSEN SAUNDERS

J. P. Pease  
NOTARY FOR THE STATE OF ALASKA  
MY COMMISSION EXPIRES 11/01/2010

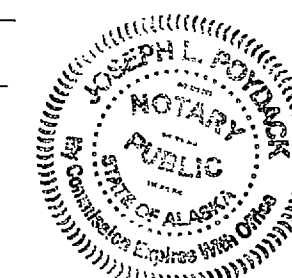

# APPLICANT CERTIFICATE

I, THE UNDERSIGNED, HEREBY CERTIFY THAT I AM THE APPLICANT OF TRACT O, ASLS 2006-24, ADL 229754 AS SHOWN HEREON. I HEREBY APPROVE THIS SURVEY AND PLAT.

DATE: 12/10/2008

William Pease  
WILLIAM PEASE  
P.O. BOX 142209  
ANCHORAGE, ALASKA 99514

## NOTARY'S ACKNOWLEDGEMENT

SUBSCRIBED AND SWORN TO BEFORE ME  
THIS 10 DAY OF DECEMBER, 2008

BY WILLIAM PEASE

J. P. Pease  
NOTARY FOR THE STATE OF ALASKA  
MY COMMISSION EXPIRES 11/01/2010



1 Meter = 3.280833 U.S. Survey Feet 1 U.S. acre = 0.4047 hectare

DATE OF SURVEY: BEGINNING: 10/04/2007 ENDING: 10/11/2007		NAME OF SURVEYOR: The Crazy Mountains JV 2000 E. Dowling Road, #6 Anchorage, AK 99507	
STATE OF ALASKA DEPARTMENT OF NATURAL RESOURCES DIVISION OF MINING LAND AND WATER Anchorage, Alaska			
ALASKA STATE LAND SURVEY NO. 2006-24			
TALACHULITNA WEST REMOTE RECREATIONAL CABIN SITES CREATING TRACTS A THROUGH V WITHIN PROTRACTED SECTION 31, T. 20 N., R. 12 W., SECTIONS 1 & 2, T. 19 N., R. 13 W., SECTIONS 5, 6 & 8, T. 19 N., R. 12 W., SEWARD MERIDIAN, ALASKA ANCHORAGE RECORDING DISTRICT Containing 361.30 Acres			
DRAWN BY: JEM DATE: 4/7/2008		APPROVAL RECOMMENDED <u>William S. Brown</u> 12/12/08 STATEWIDE PLATTING SUPERVISOR DATE	
SCALE: 1" = 200'		CHECKED BY: KJL	File No. ASLS 20060024

ANCHORAGE RECORDING DISTRICT PL 2008-124

SHEET 9 of 13

BLM Record NAD27 Position  
Lat. 61°46'24.19" N.  
Long. 151°32'02.02" W.  
From the BLM plat of T. 20 N.,  
R. 13 W., Seward Meridian, Alaska  
filed July 7, 1965  
SEE SHEET 13 for description

FLOOD  
HAZARD  
AREA

WCMC CI Tract P - NAD27  
Lat. 61°45'51.734" N.  
Long. 151°29'46.350" W.  
  
WCMC CI Tract P - NAD83 (CORS)  
Lat. 61°45'49.73387" N.  
Long. 151°29'54.71180" W.

2007 Mean  
Magnetic  
Declination  
19 1/4° E.  
See Note H

STATE OF ALASKA  
Unsubdivided

#### LEGEND

- BLM/GLO Monument Recovered
- Primary monument set this survey
- Corner Designation
- Surveyed Line
- Unsurveyed Line
- (m) Measured this survey
- (r) Record Per BLM
- Protracted Section Line
- Flood Hazard Area

ANCHORAGE RECORDING DISTRICT PL 2008-124

ASLS 2006-24  
Tract R  
17.17 Acres

STATE OF ALASKA  
Unsubdivided

ASLS 2006-24  
Tract S  
14.04 Acres

ASLS 2006-24  
Tract T  
10.46 Acres

ASLS 2006-24  
Tract P  
19.09 Acres

ASLS 2006-24  
Tract Q  
16.26 Acres

ASLS 2006-24  
Tract U  
19.02 Acres

ASLS 2006-24  
Tract V  
12.19 Acres

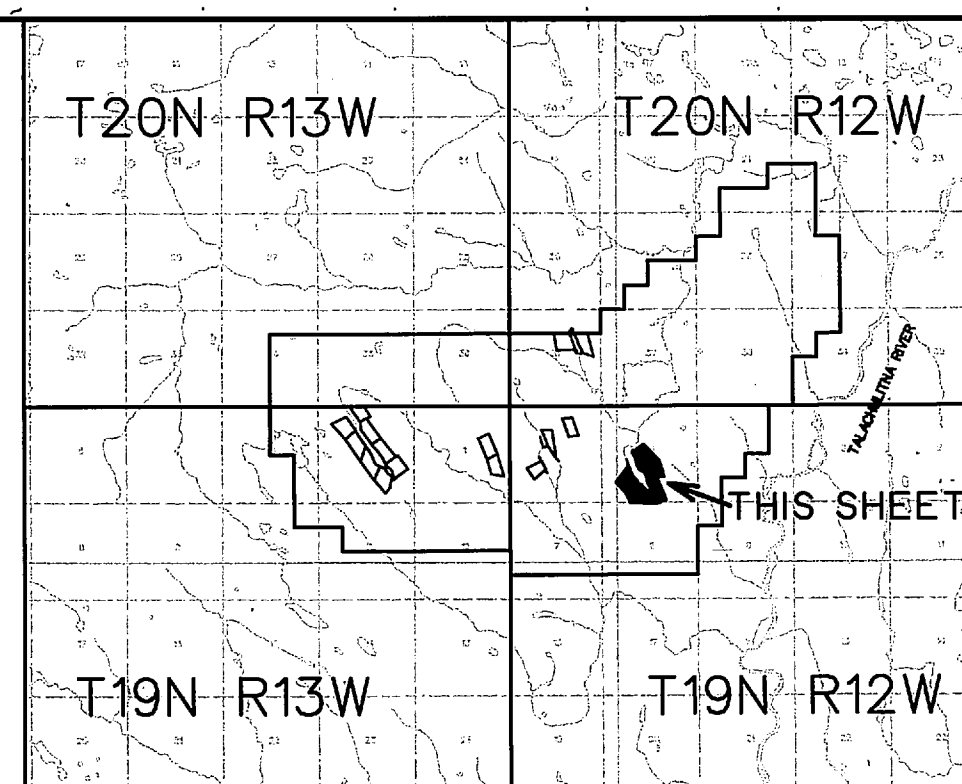

#### VICINITY MAP

Source: USGS DLG TYONEK C4, C5, D4 and D5  
Scale 1" = 2 mile

P1 N. 33°32'52" W. 47.41'	S1 N. 33°11'09" W. 229.98'
P2 N. 39°49'41" W. 103.82'	S2 N. 18°32'52" W. 129.31'
P3 N. 50°31'27" W. 112.54'	S3 N. 10°19'26" W. 196.55'
P4 N. 39°55'04" W. 75.15'	T1 N. 15°45'54" W. 48.41'
P5 N. 24°18'55" W. 169.43'	T2 N. 9°37'16" W. 120.28'
P6 N. 28°05'31" W. 179.36'	T3 N. 23°45'41" W. 112.23'
P7 N. 13°40'12" W. 160.36'	T4 N. 54°26'45" W. 113.50'
P8 N. 20°11'58" W. 135.76'	T5 N. 70°47'28" W. 108.38'
Q1 N. 42°13'52" W. 27.45'	T6 N. 56°10'26" W. 99.55'
Q2 N. 55°48'32" W. 84.89'	T7 N. 42°09'30" W. 39.12'
Q3 N. 40°36'06" W. 129.98'	U1 N. 23°25'48" E. 59.39'
Q4 N. 61°10'10" W. 123.85'	U2 N. 5°40'24" W. 64.74'
Q5 N. 29°54'12" W. 142.51'	U3 N. 25°55'50" W. 134.67'
Q6 N. 52°45'21" W. 38.34'	U4 N. 26°22'13" W. 124.74'
Q7 N. 75°53'21" W. 123.17'	U5 N. 19°12'09" W. 133.23'
Q8 N. 40°38'10" W. 69.28'	U6 N. 11°48'23" W. 173.00'
Q9 N. 21°26'45" W. 100.18'	U7 N. 18°07'29" W. 70.18'
R1 N. 12°18'10" W. 115.33'	V1 S. 36°55'53" E. 39.19'
R2 N. 23°46'50" W. 123.10'	V2 N. 76°44'01" E. 60.03'
R3 N. 32°02'43" W. 228.81'	V3 N. 56°42'04" E. 58.09'

Flood Hazard Note for the Unnamed Lake bordering Tracts P, Q, R, S, T, U and V.

A primary benchmark (BM) was established at WCMC CI Tract P. An elevation of 896.2 ft. was assumed for the BM. The plat depicts elevations for selected primary monuments relative to the BM derived from GPS measurements using the GEOID 06 model.

In October 2007 the lake level was 888 ft. -8.2 feet lower than the BM. Based on the topography and outfall to the north, and the limited area draining into the lake the BASE FLOOD ELEVATION of the unnamed lake is 888 feet

Tracts P, Q, R, S, T, U and V  
There is a less than one percent chance that any part of the platted area of Tracts P, Q, R, S, T, U and V, outside of the 100 ft. building setback, will be inundated by the Base Flood Event in any given year.

Prior to development within the Flood Hazard Area applicant must obtain a development permit from Code Compliance in accordance with M.S.B. 17.29

#### SHEET 10 of 13



1 Meter = 3.280833 U.S. Survey Feet 1 U.S. acre = 0.4047 hectare

DATE OF SURVEY: BEGINNING: 10/04/2007 ENDING: 10/11/2007	NAME OF SURVEYOR: The Crazy Mountains JV 2000 E. Dowling Road, #6 Anchorage, AK 99507
STATE OF ALASKA DEPARTMENT OF NATURAL RESOURCES DIVISION OF MINING LAND AND WATER Anchorage, Alaska	
ALASKA STATE LAND SURVEY NO. 2006-24 TALACHULITNA WEST REMOTE RECREATIONAL CABIN SITES CREATING TRACTS A THROUGH V WITHIN PROTRACTED SECTION 31, T. 20 N., R. 12 W., SECTIONS 1 & 2, T. 19 N., R. 13 W., SECTIONS 5, 6 & 8, T. 19 N., R. 12 W., SEWARD MERIDIAN, ALASKA ANCHORAGE RECORDING DISTRICT Containing 361.30 Acres	
DRAWN BY: JEM DATE: 4/7/2008	APPROVAL RECOMMENDED STATEWIDE PLATTING SUPERVISOR DATE: 12/13/08
SCALE: 1" = 200'	CHECKED BY: KJL FILE NO.: ASLS 20060024

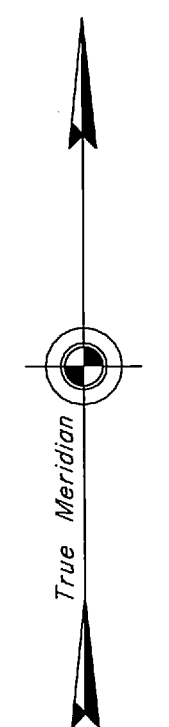

2007 Mean  
Magnetic  
Declination  
19 1/4° E.  
See Note H

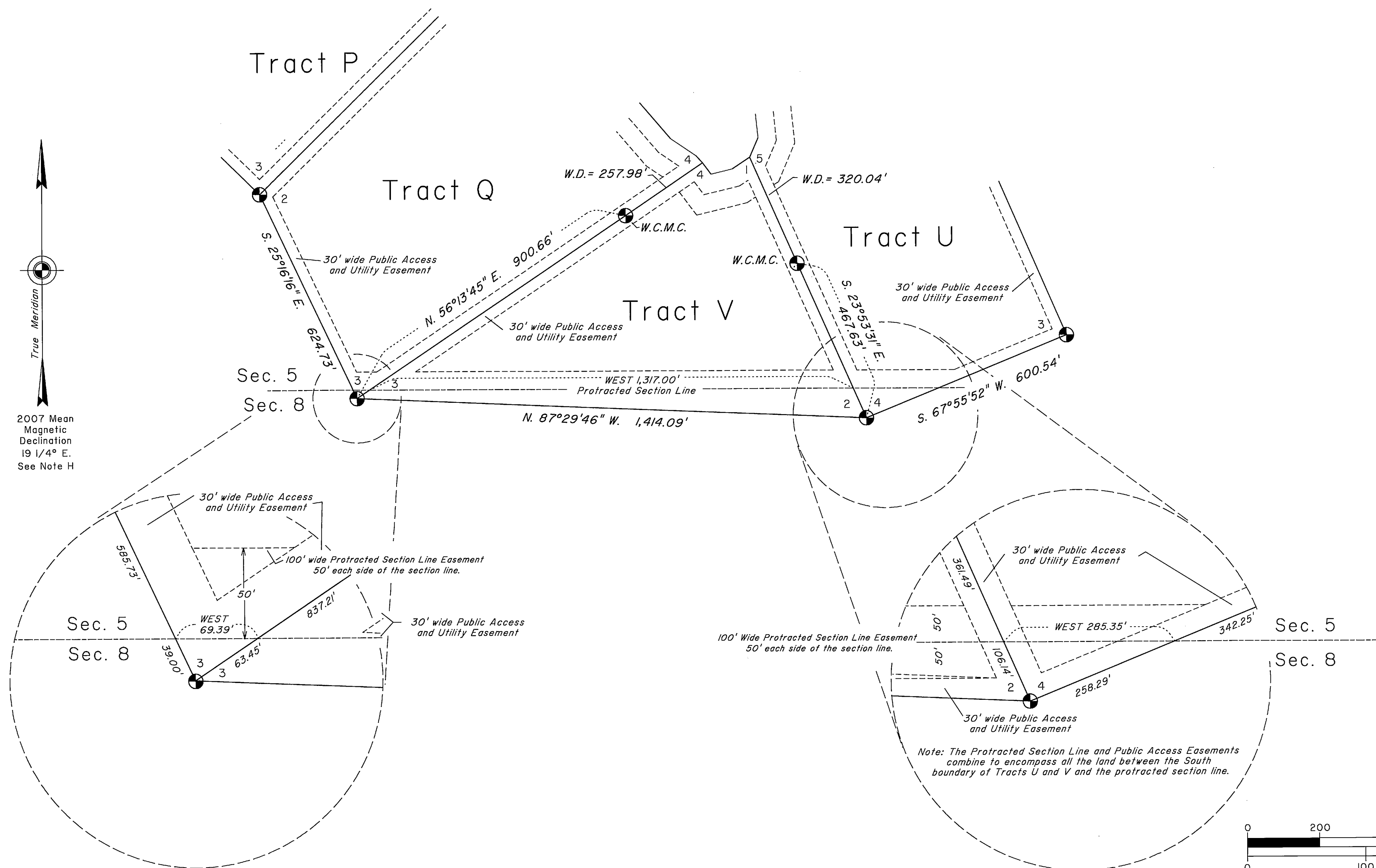

1 Meter = 3.280833 U.S. Survey Feet 1 U.S. acre = 0.4047 hectare

- LEGEND**
- ⊗ BLM/GLO Monument Recovered
  - ⊙ Primary monument set this survey
  - ① Corner Designation
  - Surveyed Line
  - - - Unsurveyed Line
  - (m) Measured this survey
  - (r) Record Per BLM
  - Protracted Section Line
  - ▨ Flood Hazard Area

SHEET II of 13

ANCHORAGE RECORDING DISTRICT PL2008-124

DATE OF SURVEY: BEGINNING: 10/04/2007 ENDING: 10/11/2007		NAME OF SURVEYOR: The Crazy Mountains JV 2000 E. Dowling Road, #6 Anchorage, AK 99507	
STATE OF ALASKA DEPARTMENT OF NATURAL RESOURCES DIVISION OF MINING LAND AND WATER Anchorage, Alaska			
ALASKA STATE LAND SURVEY NO. 2006-24			
TALACHULITNA WEST REMOTE RECREATIONAL CABIN SITES CREATING TRACTS A THROUGH V WITHIN PROTRACTED SECTION 31, T. 20 N., R. 12 W., SECTIONS 1 & 2, T. 19 N., R. 13 W., SECTIONS 5, 6 & 8, T. 19 N., R. 12 W., SEWARD MERIDIAN, ALASKA ANCHORAGE RECORDING DISTRICT Containing 361.30 Acres			
DRAWN BY: JEM DATE: 4/7/2008		APPROVAL RECOMMENDED <i>William S. Brown</i> 12/12/08 STATEWIDE PLATTING SUPERVISOR DATE	
SCALE: 1" = 200'		CHECKED BY: KJL	File No. ASLS 20060024

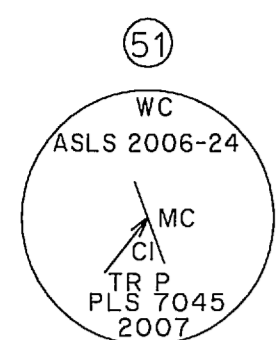

Set an alum. post, 30 ins. long, 2 1/2 ins. diam., 26 ins. in the ground, with alum. cap mkd. as shown. From which

A spruce, 15 ins. diam., bears S. 7° E., 48.2 ft. dist., mkd. X BT.

A spruce, 9 ins. diam., bears S. 71° W., 17.5 ft. dist., mkd. X BT.

A spruce, 6 ins. diam., bears N. 67° W., 31.0 ft. dist., mkd. X BT.

Place a grey DEEP-I magnet at the base of the alum. post and an orange Carsonite witness post 1 ft. S. 50° W. of the corner.

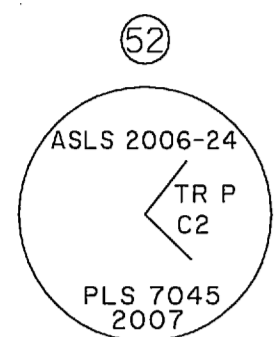

Set an alum. post, 30 ins. long, 2 1/2 ins. diam., 27 ins. in the ground, with alum. cap mkd. as shown. From which

A spruce, 12 ins. diam., bears N. 45° E., 53.7 ft. dist., mkd. X BT.

A birch, 14 ins. diam., bears S. 47 1/4° E., 72.7 ft. dist., mkd. X BT.

A spruce, 18 ins. diam., bears N. 3 1/2° W., 13.8 ft. dist., mkd. X BT.

Place a grey DEEP-I magnet at the base of the alum. post and an orange Carsonite witness post 1 ft. North of the corner.

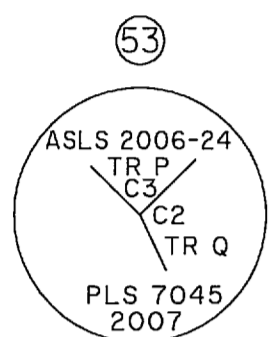

Set an alum. post, 30 ins. long, 2 1/2 ins. diam., 27 ins. in the ground, with alum. cap mkd. as shown. From which

A spruce, 9 ins. diam., bears N. 10 3/4° E., 25.3 ft. dist., mkd. X BT.

A spruce, 14 ins. diam., bears N. 85 1/4° E., 29.6 ft. dist., mkd. X BT.

A spruce, 12 ins. diam., bears N. 35 3/4° W., 37.8 ft. dist., mkd. X BT.

Place a grey DEEP-I magnet at the base of the alum. post and an orange Carsonite witness post 1 ft. North of the corner.

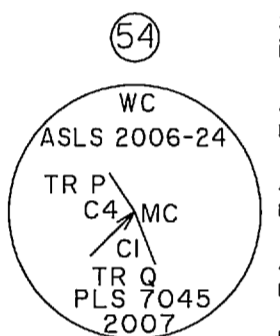

Set an alum. post, 30 ins. long, 2 1/2 ins. diam., 27 ins. in the ground, with alum. cap mkd. as shown. From which

A spruce, 7 ins. diam., bears S. 5° W., 37.25 ft. dist., mkd. X BT.

A spruce, 10 ins. diam., bears S. 45° W., 67.0 ft. dist., mkd. X BT.

A spruce, 6 ins. diam., bears N. 57 3/4° W., 64.7 ft. dist., mkd. X BT.

Place a grey DEEP-I magnet at the base of the alum. post and an orange Carsonite witness post 1 ft. North of the corner.

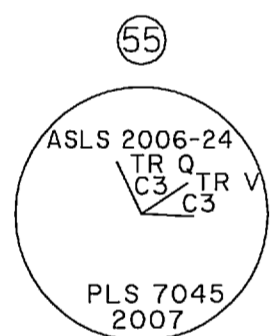

Set an alum. post, 30 ins. long, 2 1/2 ins. diam., 27 ins. in the ground, with alum. cap mkd. as shown. From which

A spruce, 14 ins. diam., bears N. 29° E., 78.0 ft. dist., mkd. X BT.

A birch, 16 ins. diam., bears S. 81° E., 19.4 ft. dist., mkd. X BT.

A birch, 15 ins. diam., bears N. 34 1/4° W., 53.85 ft. dist., mkd. X BT.

Place a grey DEEP-I magnet at the base of the alum. post and an orange Carsonite witness post 1 ft. North of the corner.

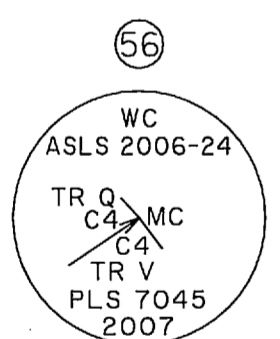

Set an alum. post, 30 ins. long, 2 1/2 ins. diam., 26 ins. in the ground, with alum. cap mkd. as shown. From which

A spruce, 8 ins. diam., bears S. 44 3/4° E., 32.9 ft. dist., mkd. X BT.

A spruce, 16 ins. diam., bears S. 8° W., 90.7 ft. dist., mkd. X BT.

A spruce, 6 ins. diam., bears N. 33 3/4° W., 93.2 ft. dist., mkd. X BT.

Place a grey DEEP-I magnet at the base of the alum. post and an orange Carsonite witness post 1 ft. North of the corner.

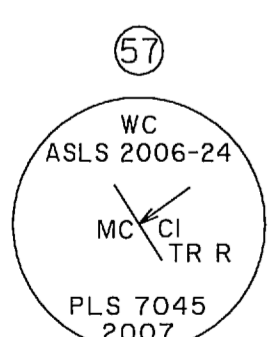

Set an alum. post, 30 ins. long, 2 1/2 ins. diam., 27 ins. in the ground, with alum. cap mkd. as shown. From which

A spruce, 14 ins. diam., bears N. 26° E., 32.6 ft. dist., mkd. X BT.

A spruce, 12 ins. diam., bears S. 41° W., 12.0 ft. dist., mkd. X BT.

A spruce, 6 ins. diam., bears N. 54 1/2° W., 55.5 ft. dist., mkd. X BT.

Place a grey DEEP-I magnet at the base of the alum. post and an orange Carsonite witness post 1 ft. North of the corner.

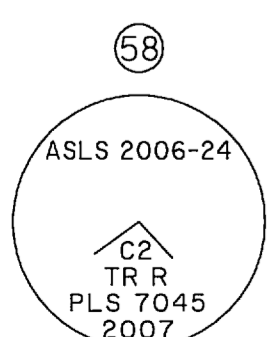

Set an alum. post, 30 ins. long, 2 1/2 ins. diam., 27 ins. in the ground, with alum. cap mkd. as shown. From which

A spruce, 15 ins. diam., bears N. 39° E., 49.2 ft. dist., mkd. X BT.

A spruce, 14 ins. diam., bears S. 23° W., 34.8 ft. dist., mkd. X BT.

A spruce, 10 ins. diam., bears N. 16° W., 36.2 ft. dist., mkd. X BT.

Place a grey DEEP-I magnet at the base of the alum. post and an orange Carsonite witness post 1 ft. North of the corner.

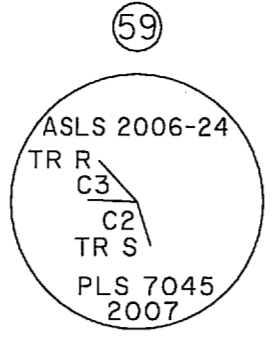

Set an alum. post, 30 ins. long, 2 1/2 ins. diam., 27 ins. in the ground, with alum. cap mkd. as shown. From which

A spruce, 7 ins. diam., bears N. 16° E., 49.1 ft. dist., mkd. X BT.

A spruce, 10 ins. diam., bears S. 63° W., 39.0 ft. dist., mkd. X BT.

A spruce, 7 ins. diam., bears N. 51° W., 28.1 ft. dist., mkd. X BT.

Place a grey DEEP-I magnet at the base of the alum. post and an orange Carsonite witness post 1 ft. North of the corner.

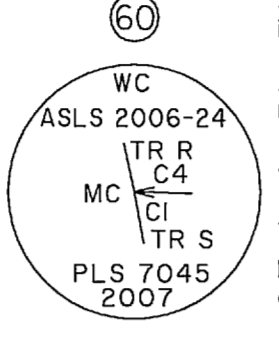

Set an alum. post, 30 ins. long, 2 1/2 ins. diam., 27 ins. in the ground, with alum. cap mkd. as shown. From which

A spruce, 20 ins. diam., bears S. 82° E., 42.6 ft. dist., mkd. X BT.

A spruce, 30 ins. diam., bears N. 61° W., 60.4 ft. dist.

A spruce, 10 ins. diam., bears N. 25° W., 34.1 ft. dist.

Place a grey DEEP-I magnet at the base of the alum. post and an orange Carsonite witness post 1 ft. North of the corner.

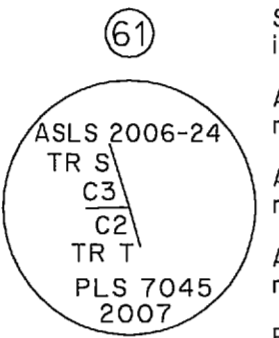

Set an alum. post, 30 ins. long, 2 1/2 ins. diam., 27 ins. in the ground, with alum. cap mkd. as shown. From which

A spruce, 5 ins. diam., bears N. 73° E., 58.3 ft. dist., mkd. X BT.

A spruce, 7 ins. diam., bears S. 19° W., 57.8 ft. dist., mkd. X BT.

A spruce, 8 ins. diam., bears N. 76° W., 58.5 ft. dist., mkd. X BT.

Place a grey DEEP-I magnet at the base of the alum. post and an orange Carsonite witness post 1 ft. North of the corner.

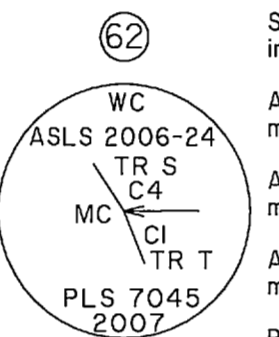

Set an alum. post, 30 ins. long, 2 1/2 ins. diam., 27 ins. in the ground, with alum. cap mkd. as shown. From which

A spruce, 12 ins. diam., bears S. 17° E., 30.7 ft. dist., mkd. X BT.

A spruce, 12 ins. diam., bears N. 89° W., 29.5 ft. dist., mkd. X BT.

A spruce, 12 ins. diam., bears N. 12° W., 52.2 ft. dist., mkd. X BT.

Place a grey DEEP-I magnet at the base of the alum. post and an orange Carsonite witness post 1 ft. North of the corner.

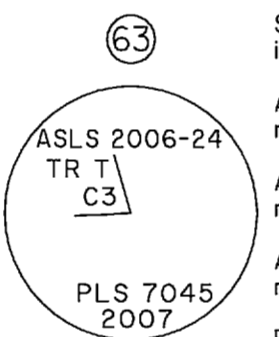

Set an alum. post, 30 ins. long, 2 1/2 ins. diam., 27 ins. in the ground, with alum. cap mkd. as shown. From which

A spruce, 8 ins. diam., bears N. 8° E., 35.7 ft. dist., mkd. X BT.

A spruce, 10 ins. diam., bears N. 78° E., 14.5 ft. dist., mkd. X BT.

A spruce, 10 ins. diam., bears S. 30 1/2° W., 27.1 ft. dist., mkd. X BT.

Place a grey DEEP-I magnet at the base of the alum. post and an orange Carsonite witness post 1 ft. North of the corner.

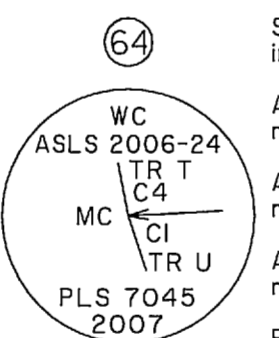

Set an alum. post, 30 ins. long, 2 1/2 ins. diam., 27 ins. in the ground, with alum. cap mkd. as shown. From which

A spruce, 24 ins. diam., bears N. 4° E., 44.1 ft. dist., mkd. X BT.

A spruce, 7 ins. diam., bears S. 70° E., 60.4 ft. dist., mkd. X BT.

A spruce, 8 ins. diam., bears N. 78° W., 23.8 ft. dist., mkd. X BT.

Place a grey DEEP-I magnet at the base of the alum. post and an orange Carsonite witness post 1 ft. North of the corner.

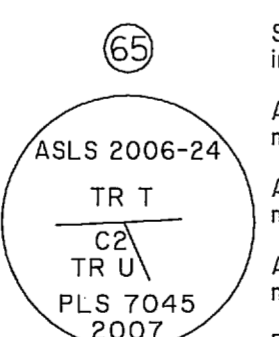

Set an alum. post, 30 ins. long, 2 1/2 ins. diam., 27 ins. in the ground, with alum. cap mkd. as shown. From which

A spruce, 16 ins. diam., bears S. 43° E., 48.9 ft. dist., mkd. X BT.

A spruce, 14 ins. diam., bears S. 71° W., 25.0 ft. dist., mkd. X BT.

A spruce, 14 ins. diam., bears N. 36° W., 48.6 ft. dist., mkd. X BT.

Place a grey DEEP-I magnet at the base of the alum. post and an orange Carsonite witness post 1 ft. North of the corner.

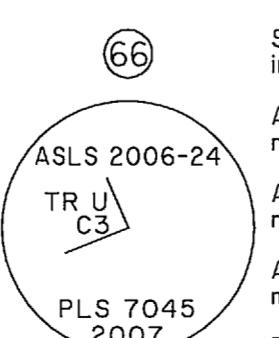

Set an alum. post, 30 ins. long, 2 1/2 ins. diam., 27 ins. in the ground, with alum. cap mkd. as shown. From which

A spruce, 12 ins. diam., bears S. 23 1/4° W., 21.7 ft. dist., mkd. X BT.

A spruce, 12 ins. diam., bears West, 25.3 ft. dist., mkd. X BT.

A spruce, 12 ins. diam., bears N. 36° W., 82.2 ft. dist., mkd. X BT.

Place a grey DEEP-I magnet at the base of the alum. post and an orange Carsonite witness post 1 ft. North of the corner.

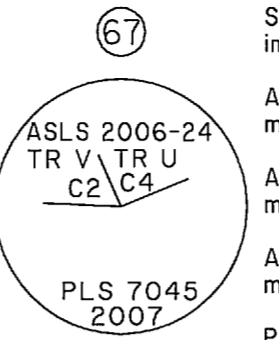

Set an alum. post, 30 ins. long, 2 1/2 ins. diam., 25 ins. in the ground, with alum. cap mkd. as shown. From which

A spruce, 8 ins. diam., bears S. 15° E., 50.8 ft. dist., mkd. X BT.

A spruce, 12 ins. diam., bears S. 66 3/4° W., 40.25 ft. dist., mkd. X BT.

A spruce, 12 ins. diam., bears N. 44 1/4° W., 37.9 ft. dist., mkd. X BT.

Place a grey DEEP-I magnet at the base of the alum. post and an orange Carsonite witness post 1 ft. North of the corner.

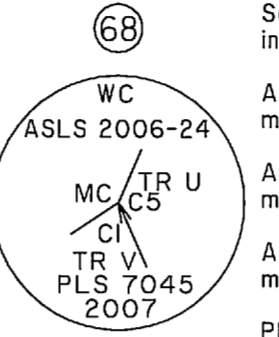

Set an alum. post, 30 ins. long, 2 1/2 ins. diam., 27 ins. in the ground, with alum. cap mkd. as shown. From which

A spruce, 18 ins. diam., bears N. 12° E., 34.4 ft. dist., mkd. X BT.

A spruce, 10 ins. diam., bears N. 60 3/4° E., 13.9 ft. dist., mkd. X BT.

A spruce, 6 ins. diam., bears S. 44° W., 19.6 ft. dist., mkd. X BT.

Place a grey DEEP-I magnet at the base of the alum. post and an orange Carsonite witness post 1 ft. North of the corner.

# APPLICANT CERTIFICATE

I, THE UNDERSIGNED, HEREBY CERTIFY THAT I AM THE APPLICANT OF TRACT Q, ASLS 2006-24, ADL 229753 AS SHOWN HEREON. I HEREBY APPROVE THIS SURVEY AND PLAT.

DATE: 10-31-08  
Peter Turgeon

PETER TURGEON  
3061 N. LAZY EIGHT COURT  
WASILLA, ALASKA 99654

# NOTARY'S ACKNOWLEDGEMENT

SUBSCRIBED AND SWORN TO BEFORE ME THIS 31 DAY OF OCTOBER, 2008

BY: Peter Turgeon

NOTARY FOR THE STATE OF ALASKA  
MY COMMISSION EXPIRES: 12/31/15

# APPLICANT CERTIFICATE

I, THE UNDERSIGNED, HEREBY CERTIFY THAT I AM THE APPLICANT OF TRACT R, ASLS 2006-24, ADL 229561 AS SHOWN HEREON. I HEREBY APPROVE THIS SURVEY AND PLAT.

DATE: 11-04-08

Margaret McMurrough

MARGARET McMURROUGH  
4403 VAN BUREN ST.  
ANCHORAGE, ALASKA 99517

# NOTARY'S ACKNOWLEDGEMENT

SUBSCRIBED AND SWORN TO BEFORE ME THIS 4 DAY OF November, 2008

BY: Margaret McMurrough

NOTARY FOR THE STATE OF ALASKA  
MY COMMISSION EXPIRES: with office

THERE ARE NO APPLICANTS FOR TRACTS P (ADL 229564) and V (ADL 230385)

SHEET 12 of 13

ANCHORAGE RECORDING DISTRICT PL2008-124

# APPLICANT CERTIFICATE

I, THE UNDERSIGNED, HEREBY CERTIFY THAT I AM THE APPLICANT OF TRACT S, ASLS 2006-24, ADL 229550 AS SHOWN HEREON. I HEREBY APPROVE THIS SURVEY AND PLAT.

DATE: 11-20-08  
Mark Farnas as attorney in fact for Christina Karnes  
CHRISTINA J. KARNES  
PMB532 1830 E. PARKS HIGHWAY #A113  
WASILLA, ALASKA 99654

# NOTARY'S ACKNOWLEDGEMENT

SUBSCRIBED AND SWORN TO BEFORE ME THIS 20th DAY OF November, 2008

Mark Farnas for Christina Karnes

NOTARY FOR THE STATE OF ALASKA  
MY COMMISSION EXPIRES: 12/31/15

# APPLICANT CERTIFICATE

I, THE UNDERSIGNED, HEREBY CERTIFY THAT I AM THE APPLICANT OF TRACT T, ASLS 2006-24, ADL 229547 AS SHOWN HEREON. I HEREBY APPROVE THIS SURVEY AND PLAT.

DATE: 12/11/08  
Kenneth A. Wynne

KENNETH A. WYNNE  
9571 NOBLEWOOD STREET  
ANCHORAGE, ALASKA 99502

# NOTARY'S ACKNOWLEDGEMENT

SUBSCRIBED AND SWORN TO BEFORE ME THIS 11 DAY OF December, 2008

BY: Victoria Braun Kenneth A. Wynne

NOTARY FOR THE STATE OF ALASKA  
MY COMMISSION EXPIRES: 12/31/15

# APPLICANT CERTIFICATE

I, THE UNDERSIGNED, HEREBY CERTIFY THAT I AM THE APPLICANT OF TRACT U, ASLS 2006-24, ADL 229745 AS SHOWN HEREON. I HEREBY APPROVE THIS SURVEY AND PLAT.

DATE: Dec 11, 2008  
Roy Roth

ROY ROTH  
7335 EAST SPRINGWOOD DRIVE  
WASILLA, ALASKA 99654

# NOTARY'S ACKNOWLEDGEMENT

SUBSCRIBED AND SWORN TO BEFORE ME THIS 11 DAY OF December, 2008

BY: Roy Roth

NOTARY FOR THE STATE OF ALASKA  
MY COMMISSION EXPIRES: 12/31/15

1 Meter = 3.280833 U.S. Survey Feet 1 U.S. acre = 0.4047 hectare

DATE OF SURVEY: BEGINNING: 10/04/2007 ENDING: 10/11/2007  
NAME OF SURVEYOR: The Crazy Mountains JV 2000 E. Dowling Road, #6 Anchorage, AK 99507

STATE OF ALASKA  
DEPARTMENT OF NATURAL RESOURCES  
DIVISION OF MINING LAND AND WATER  
Anchorage, Alaska

ALASKA STATE LAND SURVEY NO. 2006-24

TALACHULITNA WEST REMOTE RECREATIONAL CABIN SITES  
CREATING TRACTS A THROUGH V  
WITHIN PROTRACTED SECTION 31, T. 20 N., R. 12 W., SECTIONS 1 & 2,  
T. 19 N., R. 13 W., SECTIONS 5, 6 & 8, T. 19 N., R. 12 W., SEWARD MERIDIAN, ALASKA  
ANCHORAGE RECORDING DISTRICT  
Containing 361.30 Acres

DRAWN BY: JEM  
DATE: 4/7/2008  
SCALE: 1" = 200'

APPROVAL RECOMMENDED  
William S. Brown 12/12/08  
STATEWIDE PLATTING SUPERVISOR  
CHECKED BY: KJL  
File No. ASLS 20060024

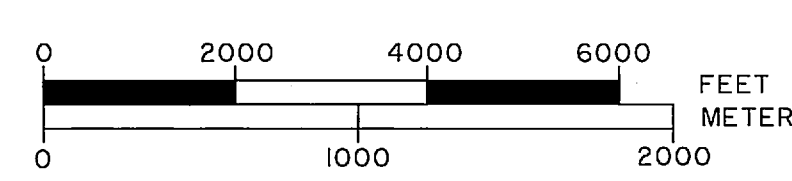
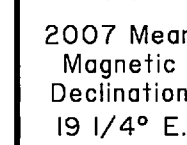

SHEET 13 of 13

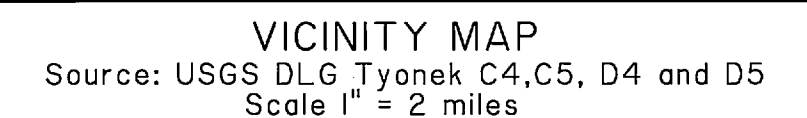

Recovered an iron post, 2 1/2 ins. diam., firmly set, projecting 6 ins. above the ground, with brass cap mkd. as shown.

Pits NE, SE, SW and NW still evident and an orange 55 gal. drum upright next to the corner.

T 19 N  
R 13 W R 12 W  
S 12 S 7  
S 13 S 18  
1963

Recovered an iron post, 2 1/2 ins. diam., firmly set, projecting 2 ins. above the ground, with brass cap mkd. as shown.

Pits NE, SE, SW and NW still evident and an orange 55 gal. drum upright next to the corner.

T 20 N  
R 13 W  
S 33 | S 34  
S 4 | S 3  
T 19 N  
1963

Recovered an iron post, 2 1/2 ins. diam., loosely set and leaning, reset now firmly set projecting 3 ins. above the ground, with brass cap mkd. as shown.

Pits NE, SE, SW and NW still evident and an orange 55 gal. drum upright next to the corner.

A circular diagram representing the 1963-64 season. The top half of the circle is labeled 'T 20 N' (Temperature 20 North) and the bottom half is labeled 'T 19 N' (Temperature 19 North). The circle is divided into 12 segments, each representing a week. The segments are labeled with 'R' (Rainfall) and 'W' (Week). The data for each week is as follows:

Week	Rainfall (R)	Week (W)
1	36	1
2	31	2
3	1	3
4	6	4
5		5
6		6
7		7
8		8
9		9
10		10
11		11
12		12

The year '1963' is written at the bottom of the circle.

72 Recovered an iron post, 2 1/2 ins. diam., firmly set, projecting 5 ins. above the ground, with brass cap mkd. as shown.

From which record accessories

A spruce snag, 14 ins. diam., bears N. 33 1/2° E., 49.5 ft. dist., with healed blaze.

A spruce, 19 ins. diam., bears S. 84 1/4° W., 23.1 ft. dist., with healed blaze.

A rotten birch stump, 30 ins. diam., bears N. 41° W., 56.1 ft. dist.  
and new accessory

A spruce, 21 ins. diam., bears East, 69.7 ft. dist., mkd. X BT.

1 Meter = 3.280833 U.S. Survey Feet    1 U.S. acre = 0.4047 hectare

DATE OF SURVEY:  
BEGINNING: 10/04/2007  
ENDING: 10/11/2007

NAME OF SURVEYOR:  
The Crazy Mountains JV  
2000 E. Dowling Road, #6  
Anchorage, AK 99507

STATE OF ALASKA  
DEPARTMENT OF NATURAL RESOURCES  
DIVISION OF MINING LAND AND WATER  
Anchorage, Alaska

ALASKA STATE LAND SURVEY NO. 2006-24

TALACHULITNA WEST REMOTE RECREATIONAL CABIN SITES  
CREATING TRACTS A THROUGH V  
WITHIN PROTRACTED SECTION 31, T. 20 N., R. 12 W., SECTIONS 1 & 2,  
T. 19 N., R. 13 W., SECTIONS 5, 6 & 8, T. 19 N., R. 12 W., SEWARD MERIDIAN., ALASKA  
ANCHORAGE RECORDING DISTRICT  
Containing 361.30 Acres

DRAWN BY: JEM

DATE: 4/7/2008

SCALE:  
1" = 2000'

APPROVAL RECOMMENDED  
*William S. Brown* 12/12/00  
STATEWIDE PLATTING SUPERVISOR DATE

CHECKED BY:	KJL
-------------	-----

File No.  
ASLS 20060024