

LAKE MINCHUMINA II

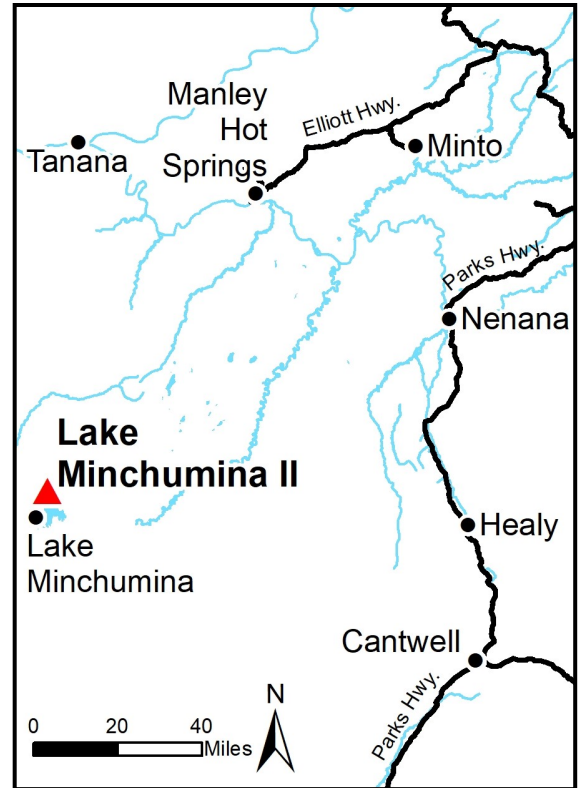

Location	Lake Minchumina II is located approximately 155 air miles southwest of Fairbanks.
Access	Access to Lake Minchumina II is by floatplane the lake or wheeled plane to the state-maintained airstrip four miles south, then overland to the subdivision. The parcels are approximately 1/2 mile from the lake.
Utilities	There is no municipal water supply or sewer system. Please see plat notes and the “ <i>Sewer and Water</i> ” section of this brochure for details. There are no utilities (electric, phone, internet, etc.) currently in this area.
Local Government	Lake Minchumina II is located within the Unorganized Borough and subject to the State of Alaska platting authority.
Tentatively Approved	Lake Minchumina II is located on Tentatively Approved land, please see the “ <i>Tentatively Approved Lands</i> ” section for details.
Fire	This area is in the Full Fire Management Option. See the “ <i>Wildland Fires and Burn Permits</i> ” section of this brochure for details.
Restrictions	Easements affecting these parcels, as depicted on the plat, may include, but are not limited to, utility easements. Information on restrictions, easements, reservations, and setbacks may be depicted on the plat, contained in the plat notes, or be recorded separately.
Survey and MTRS	Lake Minchumina II is survey ASLS 81-168, located in Section 28, Township 11 South, Range 24 West, Fairbanks Meridian. The survey was filed as plate 82-32 in the Fairbanks Recording District.
Homeowner’s Association	Any subsequent owner of parcels within this subdivision automatically becomes a member of the homeowner’s association, if active. The declaration of covenants, conditions, and restrictions for this association was recorded on February 22, 1982 in the Fairbanks Recording District.
Rights-of-way	The rights-of-way within the subdivision are undeveloped.

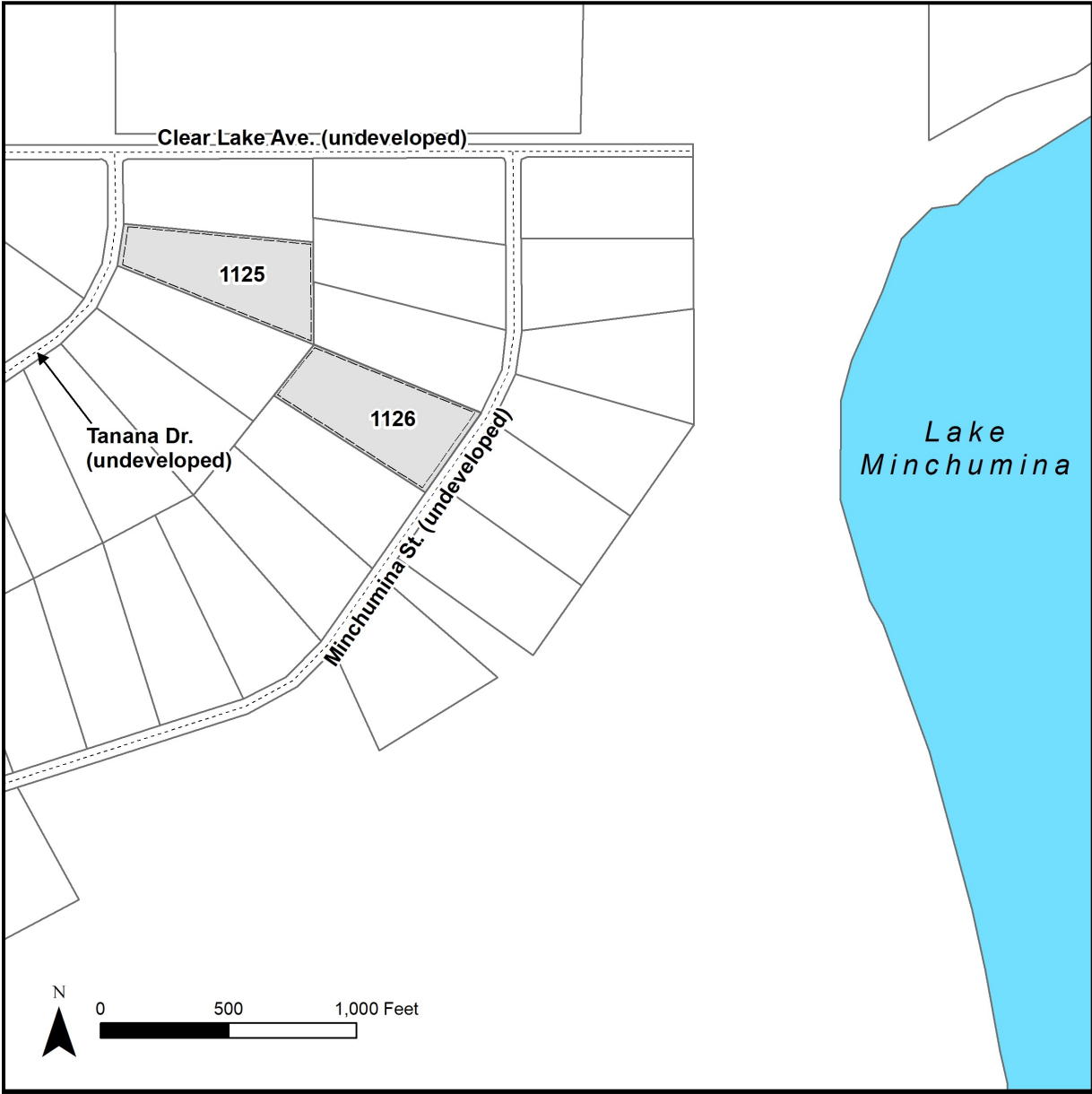

PARCEL #	AK DIVISION OF LANDS (ADL) #	LOT	BLOCK	ACRES	MINIMUM BID
1125	408168	21	2	4.95	\$3,600
1126	408173	4	2	4.99	\$3,600

Note: Maps and photos included in this brochure are for graphic and visual representations only and are intended to be used as a guide. Please see “Land Records, Photos, Plats, and Maps” for details.