

Survey Diagram: Teklanika III RRCS (North Half)

Remote Recreational Cabin Sites Staking Area # 1111104

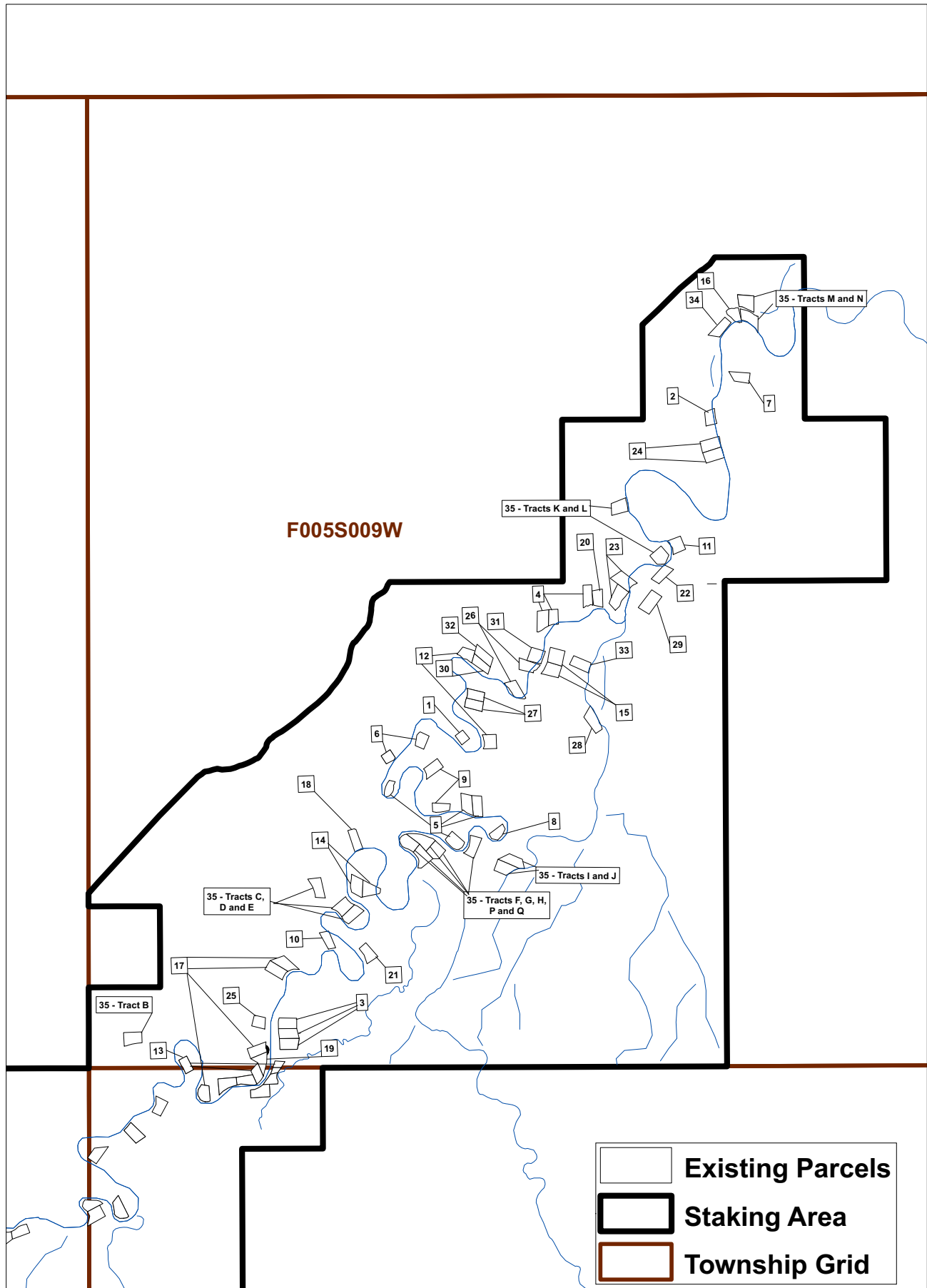

Survey Diagram: Teklanika III RRCS (South Half)

Remote Recreational Cabin Sites Staking Area # 1111104

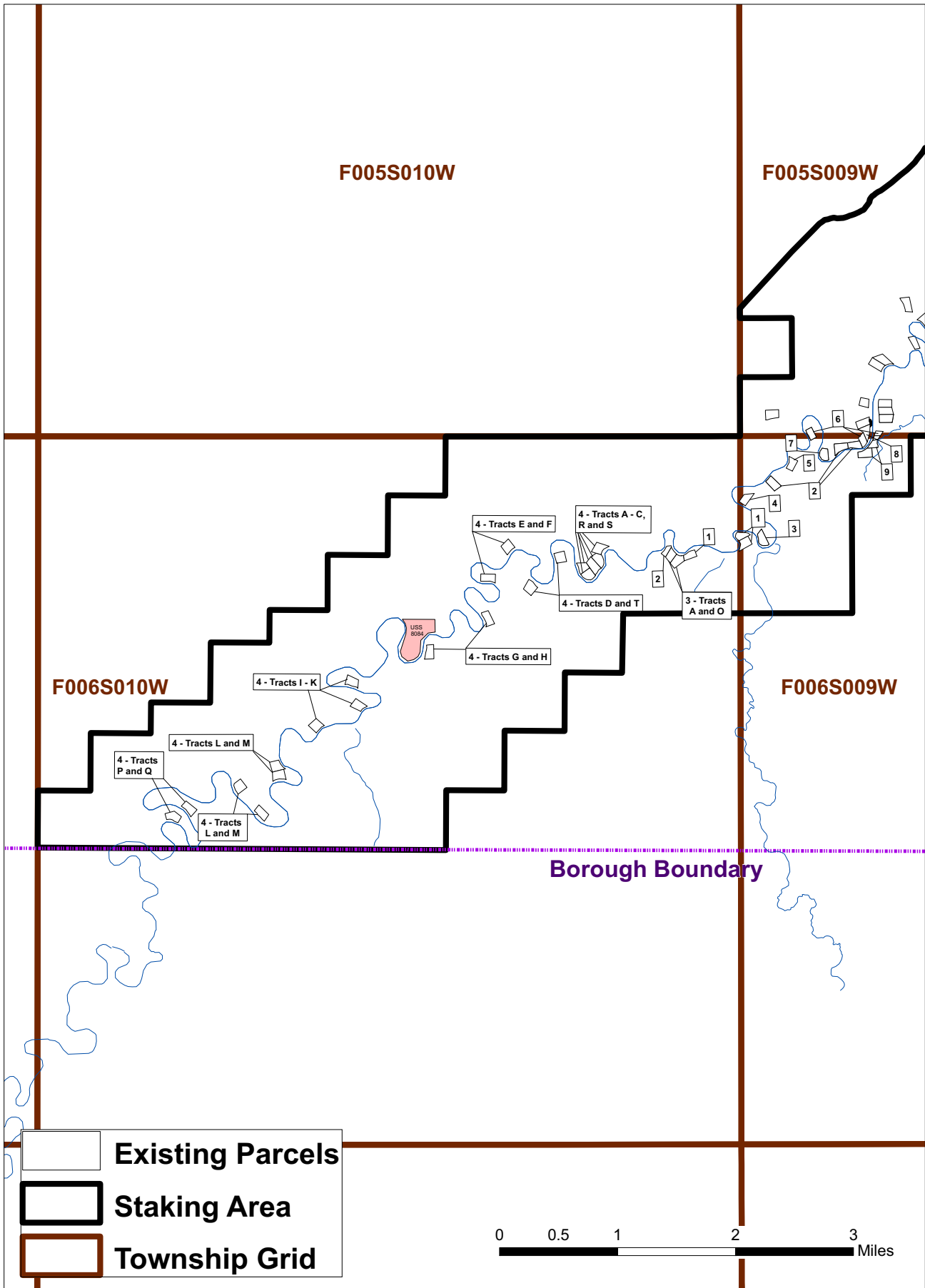

TEKLANIKA III STAKING MAP SURVEYS

The links below are for existing surveys in the Teklanika III staking area vicinity available online from Alaska Land Records. You will need Adobe Acrobat or a similar PDF viewer to view the plats.

Township 5 South, Range 9 West, Fairbanks Meridian

US Rectangular Survey (USRS)

<http://dnr.alaska.gov/gis/raster/blm/usrs/20070505/Fairbanks/AK1300500S00900W002.pdf>

US Survey (USS) 9947 and 9948

<http://dnr.alaska.gov/gis/raster/blm/usrs/20070505/Fairbanks/AK1300500S00900W005.pdf>

Cadastral Survey Control Plat (CS) F005S009W

<http://dnr.alaska.gov/gis/raster/dnr/surveys/20000731/00020010.pdf>

1. Alaska State Land Survey (ASLS) 850332

<http://dnr.alaska.gov/gis/raster/dnr/surveys/20000731/00025773.pdf>

2. ASLS 860149

<http://dnr.alaska.gov/gis/raster/dnr/surveys/20000731/00025635.pdf>

3. ASLS 860150

<http://dnr.alaska.gov/gis/raster/dnr/surveys/20000731/00025634.pdf>

4. ASLS 860151

<http://dnr.alaska.gov/gis/raster/dnr/surveys/20000731/00025633.pdf>

5. ASLS 860152

<http://dnr.alaska.gov/gis/raster/dnr/surveys/20000731/00025632.pdf>

6. ASLS 860180

<http://dnr.alaska.gov/gis/raster/dnr/surveys/20000731/00025601.pdf>

7. ASLS 860181

<http://dnr.alaska.gov/gis/raster/dnr/surveys/20000731/00025600.pdf>

8. ASLS 860234

<http://dnr.alaska.gov/gis/raster/dnr/surveys/20000731/00025562.pdf>

9. ASLS 870080

<http://dnr.alaska.gov/gis/raster/dnr/surveys/20000731/00025451.pdf>

10. ASLS 870081

<http://dnr.alaska.gov/gis/raster/dnr/surveys/20000731/00025450.pdf>

11. ASLS 870082

<http://dnr.alaska.gov/gis/raster/dnr/surveys/20000731/00025449.pdf>

12. ASLS 870109

<http://dnr.alaska.gov/gis/raster/dnr/surveys/20000731/00025427.pdf>

13. ASLS 870206

<http://dnr.alaska.gov/gis/raster/dnr/surveys/20000731/00025351.pdf>

14. ASLS 870267

<http://dnr.alaska.gov/gis/raster/dnr/surveys/20000731/00025327.pdf>

15. ASLS 870268

<http://dnr.alaska.gov/gis/raster/dnr/surveys/20000731/00025326.pdf>

16. ASLS 870275

<http://dnr.alaska.gov/gis/raster/dnr/surveys/20000731/00025320.pdf>

17. ASLS 870379

<http://dnr.alaska.gov/gis/raster/dnr/surveys/20000731/00025242.pdf>

18. ASLS 870380

<http://dnr.alaska.gov/gis/raster/dnr/surveys/20000731/00025241.pdf>

19. ASLS 890057

<http://dnr.alaska.gov/gis/raster/dnr/surveys/20000731/00029227.pdf>

20. ASLS 890189

<http://dnr.alaska.gov/gis/raster/dnr/surveys/20000731/00029107.pdf>

21. ASLS 900102

<http://dnr.alaska.gov/gis/raster/dnr/surveys/20000731/00028961.pdf>

22. ASLS 900103

<http://dnr.alaska.gov/gis/raster/dnr/surveys/20000731/00028960.pdf>

23. ASLS 900118

<http://dnr.alaska.gov/gis/raster/dnr/surveys/20000731/00028946.pdf>

24. ASLS 900119

<http://dnr.alaska.gov/gis/raster/dnr/surveys/20000731/00028945.pdf>

25. ASLS 900121

<http://dnr.alaska.gov/gis/raster/dnr/surveys/20000731/00028943.pdf>

26. ASLS 900134

<http://dnr.alaska.gov/gis/raster/dnr/surveys/20000731/00028933.pdf>

27. ASLS 900179

<http://dnr.alaska.gov/gis/raster/dnr/surveys/20000731/00028891.pdf>

28. ASLS 900196

<http://dnr.alaska.gov/gis/raster/dnr/surveys/20000731/00028880.pdf>

29. ASLS 900215

<http://dnr.alaska.gov/gis/raster/dnr/surveys/20000731/00028866.pdf>

30. ASLS 910115

<http://dnr.alaska.gov/gis/raster/dnr/surveys/20000731/00028663.pdf>

31. ASLS 910114

<http://dnr.alaska.gov/gis/raster/dnr/surveys/20000731/00028650.pdf>

32. ASLS 930086

<http://dnr.alaska.gov/gis/raster/dnr/surveys/20000731/00028251.pdf>

33. ASLS 930087

<http://dnr.alaska.gov/gis/raster/dnr/surveys/20000731/00028250.pdf>

34. ASLS 930088

<http://dnr.alaska.gov/gis/raster/dnr/surveys/20000731/00028249.pdf>

35. ASLS 20020012

http://dnr.alaska.gov/gis/raster/dnr/surveys/20040928/asls20020012_1.pdf

Tracts A, B and O

http://dnr.alaska.gov/gis/raster/dnr/surveys/20040928/asls20020012_2.pdf

Tracts C, D and E

http://dnr.alaska.gov/gis/raster/dnr/surveys/20040928/asls20020012_3.pdf

Tracts F – H, P and Q

http://dnr.alaska.gov/gis/raster/dnr/surveys/20040928/asls20020012_4.pdf

Tracts I and J

http://dnr.alaska.gov/gis/raster/dnr/surveys/20040928/asls20020012_5.pdf

Tracts K and L

http://dnr.alaska.gov/gis/raster/dnr/surveys/20040928/asls20020012_6.pdf

Tracts M and N

http://dnr.alaska.gov/gis/raster/dnr/surveys/20040928/asls20020012_7.pdf

Township 6 South, Range 9 West, Fairbanks Meridian

USRS F006S009W

<http://dnr.alaska.gov/gis/raster/blm/usrs/20070505/Fairbanks/AK1300600S00900W001.pdf>

<http://dnr.alaska.gov/gis/raster/blm/usrs/20070505/Fairbanks/AK1300600S00900W002.pdf>

CS F006S009W

<http://dnr.alaska.gov/gis/raster/dnr/surveys/20000731/00020006.pdf>

1. ASLS 860072

<http://dnr.alaska.gov/gis/raster/dnr/surveys/20000731/00025706.pdf>

2. ASLS 860148

<http://dnr.alaska.gov/gis/raster/dnr/surveys/20000731/00025636.pdf>

3. ASLS 870079

<http://dnr.alaska.gov/gis/raster/dnr/surveys/20000731/00025452.pdf>

4. ASLS 870197

<http://dnr.alaska.gov/gis/raster/dnr/surveys/20000731/00025358.pdf>

5. ASLS 870205

<http://dnr.alaska.gov/gis/raster/dnr/surveys/20000731/00025352.pdf>

6. ASLS 870206

<http://dnr.alaska.gov/gis/raster/dnr/surveys/20000731/00025351.pdf>

7. ASLS 870379

<http://dnr.alaska.gov/gis/raster/dnr/surveys/20000731/00025242.pdf>

8. ASLS 890057

<http://dnr.alaska.gov/gis/raster/dnr/surveys/20000731/00029227.pdf>

9. ASLS 910102

<http://dnr.alaska.gov/gis/raster/dnr/surveys/20000731/00028678.pdf>

Township 6 South, Range 10 W, Fairbanks Meridian

USRS F006S010W

<http://dnr.alaska.gov/gis/raster/blm/usrs/20070505/Fairbanks/AK1300600S01000W001.pdf>

<http://dnr.alaska.gov/gis/raster/blm/usrs/20070505/Fairbanks/AK1300600S01000W002.pdf>

USS 8084

<http://dnr.alaska.gov/gis/raster/blm/uss/20071128/USS008084/USS008084-001.pdf>

1. ASLS 870079

<http://dnr.alaska.gov/gis/raster/dnr/surveys/20000731/00025452.pdf>

2. ASLS 900308

<http://dnr.alaska.gov/gis/raster/dnr/surveys/20000731/00028793.pdf>

3. ASLS 20020012

http://dnr.alaska.gov/gis/raster/dnr/surveys/20040928/asls20020012_1.pdf

Tracts A and O

http://dnr.alaska.gov/gis/raster/dnr/surveys/20040928/asls20020012_2.pdf

4. ASLS 20050028

http://dnr.alaska.gov/gis/raster/dnr/surveys/20071015/ASLS20050028_1.pdf

Tracts A – C, R and S

http://dnr.alaska.gov/gis/raster/dnr/surveys/20071015/ASLS20050028_2.pdf

Tracts D and T

http://dnr.alaska.gov/gis/raster/dnr/surveys/20071015/ASLS20050028_3.pdf

Tracts E and F

http://dnr.alaska.gov/gis/raster/dnr/surveys/20071015/ASLS20050028_4.pdf

Tracts G and H

http://dnr.alaska.gov/gis/raster/dnr/surveys/20071015/ASLS20050028_5.pdf

Tracts I – K

http://dnr.alaska.gov/gis/raster/dnr/surveys/20071015/ASLS20050028_6.pdf

Tracts L and M

http://dnr.alaska.gov/gis/raster/dnr/surveys/20071015/ASLS20050028_7.pdf

Tracts N and O

http://dnr.alaska.gov/gis/raster/dnr/surveys/20071015/ASLS20050028_8.pdf

Tracts P and Q

http://dnr.alaska.gov/gis/raster/dnr/surveys/20071015/ASLS20050028_9.pdf