

A. This survey was accomplished in accordance with AS 38.05.600, GSC 709 RRCS-SI 2005-27.

B. All bearings shown are true bearings as oriented to the Basis of Bearing and distances shown are reduced to horizontal field distances.

C. The accuracy of the survey is greater than 1:5000.

D. All parcels of land owned by the State of Alaska, located within 50.00 feet of, or bisected by a surveyed or protracted section line, are subject to a 50 foot(50') easement, each side of the section line, which is reserved to the State of Alaska for public highways under A.S. 19.10.010.

E. The existing lessee's claim corners were recovered and used to control the location of the tract boundary.

F. BASIS OF BEARING The Basis of Bearing for this plat was determined by high precision GPS survey using Topcon GGD receivers, differentially corrected and processed using Trimble Total Control, Version 2.73 processing software.

BASIS OF COORDINATES NAD27 The coordinates depicted on the plots are based on a tie to a monument of record using high precision GPS survey techniques. The bearing and distance obtained were applied to the record NAD27 position to compute the NAD27 positions of a corner of each tract.

NAD83 coordinates were derived by high precision GPS survey using Topcon GGD receivers, differentially corrected and processed using Trimble Total Control, Version 2.73 processing software. The adjustment was constrained to NGS CORS station ZANI (CORS96) (EPOCH 2003.0)

G. The natural meanders of the line of ordinary high water forms the true bounds of portions of Tract E. The approximate line of OHW as shown, is for area computations only, with the true corners being on the extension of the sidelines and their intersection with the natural meanders.

CERTIFICATE OF OWNERSHIP AND DEDICATION

I, the undersigned, hereby certify that I am the Director, Division of Mining, Land and Water and that the State of Alaska is the owner of ASLS 2005-27 as shown hereon. I hereby approve this survey and plat for the State of Alaska and dedicate for public or private use as noted, all easements, public utility areas, and rights-of-way as shown and described hereon.

Dated: July 29, 2008 for Gerald Jennings
for Director, Division of Mining, Land and Water

NOTARY'S ACKNOWLEDGEMENT

SUBSCRIBED AND SWORN TO BEFORE ME THIS 29 DAY OF July, 2008

BY GERALD JENNINGS

Joseph J. Pothke
NOTARY FOR THE STATE OF ALASKA
MY COMMISSION EXPIRES 11/01/2011

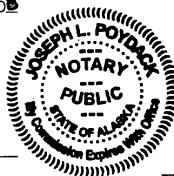

**PORCUPINE BUTTE WEST
REMOTE RECREATIONAL
CABIN SITES**

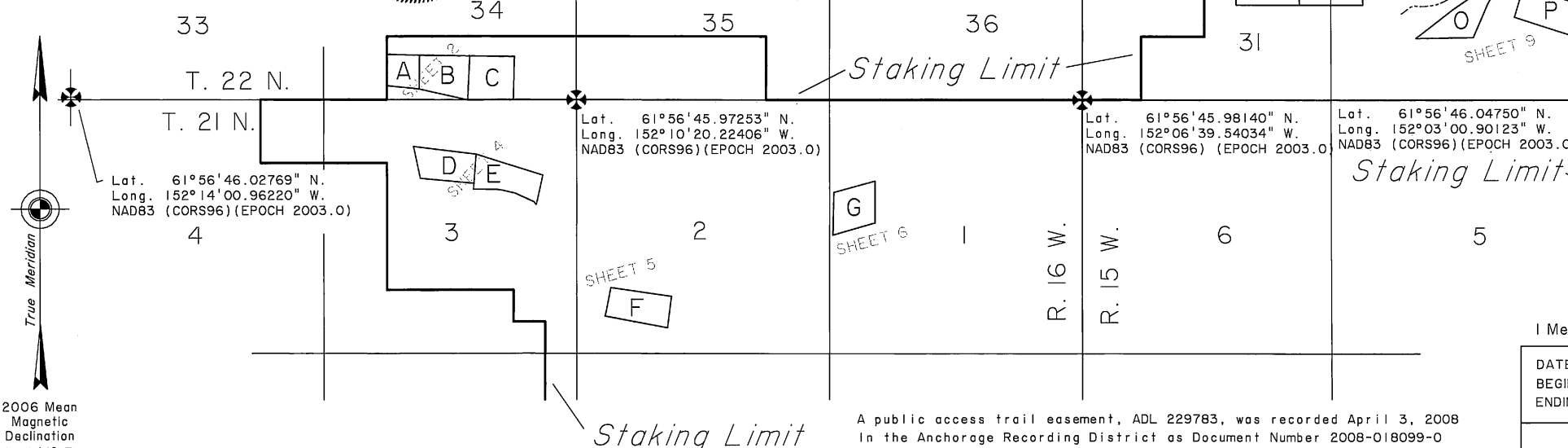

NOTES

H. The 2006 mean magnetic declination was determined by calculation using the Magnetic Declination Calculator (MIRP) maintained by Natural Resources Canada at http://www.geolab.nrcan.gc.ca/geomag/mirp_e.shtml

I. The Matanuska-Susitna Borough is not responsible for road construction or road maintenance.

J. There is an 100 foot building setback from the line of ordinary high water of all public and navigable water bodies.

K. Flood Hazard Note for the Unnamed Lake bordering Tract E.

A primary benchmark (BM) was established at WCMC C2 Tract E. An elevation of 1153 ft. was assumed for the BM. The plat depicts elevations for selected points relative to the BM derived from GPS measurements.

In October 2006 the lake level was 1150 ft. - 3 feet lower than the TBM. Based on the topography and outfall to the southwest, the rainfall during our survey, and the limited area draining into the lake the BASE FLOOD ELEVATION of the unnamed lake is 1150 feet - 3 foot lower than the BM.

Tract E There is a less than one percent chance that any part of the platted area of Tract E, outside of the 100 ft. building setback, will be inundated by the Base Flood Event in any given year.

Prior to development within the Flood Hazard Area applicant must obtain a development permit from Code Compliance in accordance with M.S.B. 17.29

L. Land Use Note: There may be Federal, State and local requirements governing land use. It is the responsibility of the individual parcel owner to obtain a determination whether such requirements apply to the development of parcels shown hereon.

M. Wastewater Note: No individual water supply system or sewage disposal system shall be permitted on any lot unless such system is located, constructed and equipped in accordance with the requirements, standards and recommendations of the State of Alaska, Department of Environmental Conservation, which govern those systems.

N. A public access trail easement, ADL 229783, was recorded April 3, 2008 in the Anchorage Recording District as Document Number 2008-018099-0.

CERTIFICATE OF PAYMENT OF TAXES

I hereby certify that all current taxes and special assessments, through December 31, 2008 against the property, included in the subdivision, hereon have been paid.

Cheryll Hand 10/29/08
BOROUGH TAX COLLECTION OFFICIAL DATE



Eileen Priban 10/29/08
Planning Director Date
Attest Marilyn McLeune
Platting Clerk

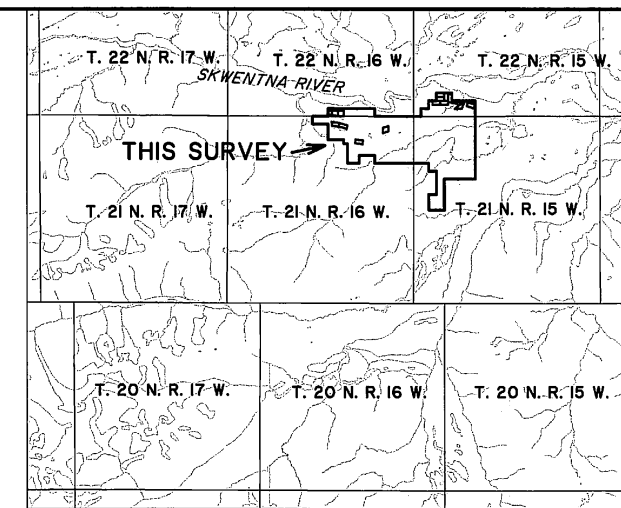

VICINITY MAP

Source: USGS DLG TYONEK D-6 & D-7
Scale 1" = 4 miles

PLAT APPROVAL

I certify that this subdivision plat has been found to comply with the Land Subdivision Regulations of the Matanuska-Susitna Borough and that the plat has been approved by the Platting Authority by Plat Resolution 2008-108-SUB, Dated November 15, 2007 and that this plat has been approved for recording in the Anchorage Recording District, Third Judicial District, State of Alaska.

INDEX SHEET

SHEET INDEX		
TRACT A	SHEETS	2 & 3
TRACT B	SHEETS	2 & 3
TRACT C	SHEETS	2 & 3
TRACT D	SHEET	4
TRACT E	SHEET	4
TRACT F	SHEET	5
TRACT G	SHEET	6
TRACT H	SHEETS	7 & 8
TRACT I	SHEETS	7 & 8
TRACT J	SHEETS	7 & 8
TRACT K	SHEETS	7 & 8
TRACT L	SHEETS	7 & 8
TRACT M	SHEETS	7 & 8
TRACT N	SHEETS	9 & 10
TRACT O	SHEETS	9 & 10
TRACT P	SHEETS	9 & 10

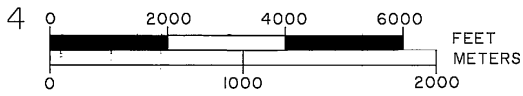

1 Meter = 3.280833 U.S. Survey Feet | U.S. acre = 0.4047 hectare

DATE OF SURVEY: BEGINNING: 10/07/2006 ENDING: 10/14/2006	NAME OF SURVEYOR: The Crazy Mountains JV 2000 E. Dowling Road, #6 Anchorage, AK 99507
--	--

STATE OF ALASKA
DEPARTMENT OF NATURAL RESOURCES
DIVISION OF MINING LAND AND WATER
Anchorage, Alaska

ALASKA STATE LAND SURVEY NO. 2005-27
PORCUPINE BUTTE WEST REMOTE RECREATIONAL CABIN SITES
CREATING TRACTS A - P
WITHIN UNSURVEYED SECTIONS 31 and 32, T. 22 N., R. 15 W., SECTIONS 1, 2, & 3, T. 21 N., R. 16 W., and SECTION 34, T. 22 N., R. 16 W., all of the SEWARD MERIDIAN, ALASKA
ANCHORAGE RECORDING DISTRICT
Containing 290.66 Acres

DRAWN BY: JEM	APPROVAL RECOMMENDED <u>William S. Brown</u> 7-29-08
DATE: 1/7/2008 FOR	STATEWIDE PLATTING SUPERVISOR DATE
SCALE: 1" = 2000'	CHECKED BY: KJL File No. ASLS 20050027

SURVEYOR'S CERTIFICATE

I hereby certify that I am properly registered and licensed to practice land surveying in the State of Alaska, that this plat represents a survey made by me or under my direct supervision, that the monuments shown hereon exist as described, and that all dimensions and other details are correct.

Date: April 4, 2008 Registration No. LS-7045

James E. Mitchell
James E. Mitchell, Registered Land Surveyor

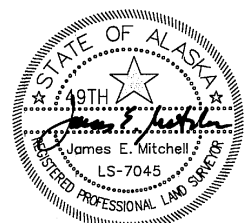

TYPICAL PRIMARY MONUMENT

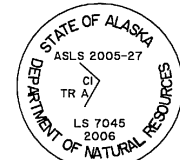

Primary monument - Aluminum post
30 inches long, 2 1/2 inch diameter

- LEGEND**
- ⊗ BLM/GLO Monument Recovered
 - Primary monument set this survey
 - ⓪ Corner Designation
 - Surveyed Line
 - Unsurveyed Line

Anchorage Recording District Plat 2008-114

APPLICANT CERTIFICATE

I, THE UNDERSIGNED, HEREBY CERTIFY THAT I AM THE APPLICANT OF TRACT B ASLS 2005-27, ADL 229160 AS SHOWN HEREON. I HEREBY APPROVE THIS SURVEY AND PLAT.

DATE: April 23, 2008
Donna Claus

DONNA CLAUD
 P.O. Box 109
 CHITINA, ALASKA 99566

NOTARY'S ACKNOWLEDGEMENT

SUBSCRIBED AND SWORN TO BEFORE ME THIS 23rd DAY OF April, 2008

BY: Donna Claus

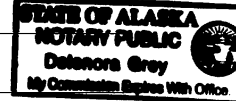

NOTARY FOR THE STATE OF ALASKA
 MY COMMISSION EXPIRES: 12/31/2011

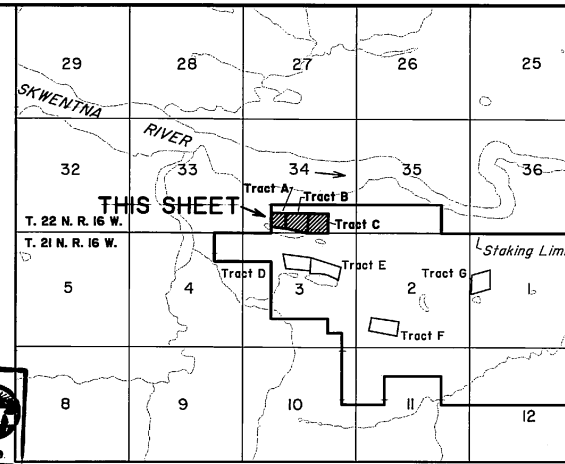

VICINITY MAP

Source: USGS DLG TYONEK D-6
 Scale 1" = 1 mile

STATE OF ALASKA
 Unsubdivided

NOTE: THERE ARE NO APPLICANTS FOR TRACT A (ADL 229542) or TRACT C (ADL 229543)

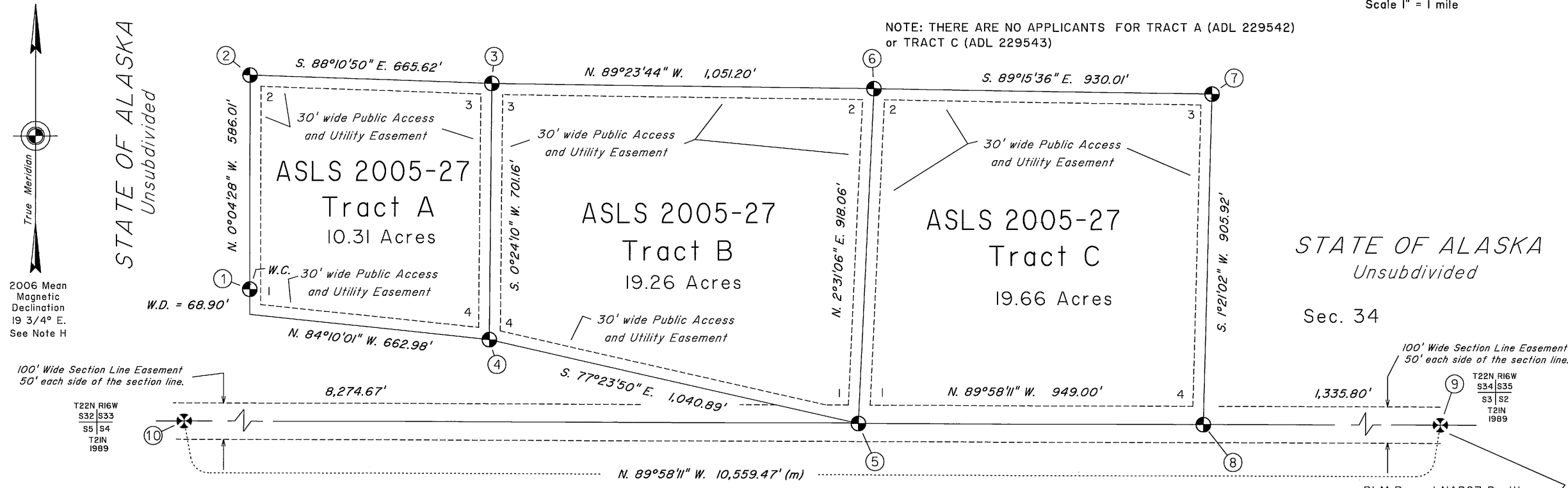

2006 Mean Magnetic Declination 19 3/4° E. See Note H

100' Wide Section Line Easement 50' each side of the section line.

T22N R16W S32 S33 S5 S4 T21N 1989

100' Wide Section Line Easement 50' each side of the section line.

T22N R16W S34 S35 S3 S2 T21N 1989

C4 Tract C - NAD27
 Lat. 61°56'48.016" N.
 Long. 152°10'40.126" W.
 C4 Tract C - NAD83 (CORS)
 Lat. 61°56'45.97951" N.
 Long. 152°10'48.14804" W.

BLM Record NAD27 Position
 Lat. 61°56'48.023" N.
 Long. 152°10'12.203" W.
 Computed using BLM plat of T. 22 N., R. 16 W., Seward Meridian, Alaska filed June 17, 1996

1 Meter = 3.280833 U.S. Survey Feet 1 U.S. acre = 0.4047 hectare

STATE OF ALASKA
 Unsubdivided

SEE SHEET 3 FOR MONUMENT DESCRIPTIONS

- LEGEND**
- ⊗ BLM/GLO Monument Recovered
 - Primary monument set this survey
 - ① Corner Designation
 - Surveyed Line
 - - - Unsurveyed Line
 - (m) Measured this survey
 - (r) Record Per BLM
 - - - Protracted Section Line

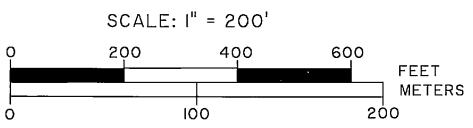

SHEET 2 of 10

Anchorage Recording District Plat 2008-114

DATE OF SURVEY: BEGINNING: 10/07/2006 ENDING: 10/14/2006		NAME OF SURVEYOR: The Crazy Mountains JV 2000 E. Dowling Road, #6 Anchorage, AK 99507	
STATE OF ALASKA DEPARTMENT OF NATURAL RESOURCES DIVISION OF MINING LAND AND WATER Anchorage, Alaska			
ALASKA STATE LAND SURVEY NO. 2005-27			
PORCUPINE BUTTE WEST REMOTE RECREATIONAL CABIN SITES CREATING TRACTS A - P WITHIN UNSURVEYED SECTIONS 31 and 32, T. 22 N., R. 15 W., SECTIONS 1, 2, & 3, T. 21 N., R. 16 W., and SECTION 34, T. 22 N., R. 16 W., all of the SEWARD MERIDIAN, ALASKA ANCHORAGE RECORDING DISTRICT Containing 290.66 Acres			
DRAWN BY: JEM		APPROVAL RECOMMENDED	
DATE: 1/7/2008		<u>William S. Brown</u> 7-24-08	
SCALE: 1" = 200'		STATEWIDE PLATTING SUPERVISOR DATE	
CHECKED BY: KJL		File No. ASLS 20050027	

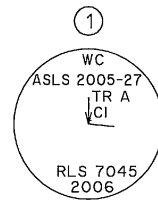

① Set an alum. post, 30 ins. long, 2 1/2 ins. diam., 26 ins. in the ground, with alum. cap mkd. as shown.

From which

A spruce, 20 ins. diam., bears N. 39° E., 42.8 ft. dist., mkd. X BT.

A spruce, 20 ins. diam., bears N. 66 1/2° E., 31.1 ft. dist., mkd. X BT.

A spruce, 26 ins. diam., bears N. 20° W., 39.2 ft., dist., mkd. X BT.

Place a blue DEEP-1 magnet at the base of the alum. post and an orange Carsonite witness post 1 ft. North of the corner.

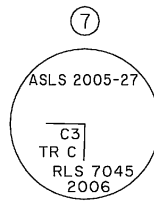

⑦ Set an alum. post, 30 ins. long, 2 1/2 ins. diam., 26 ins. in the ground, with alum. cap mkd. as shown.

From which

A spruce, 20 ins. diam., bears N. 64° E., 78.2 ft. dist., mkd. X BT.

A spruce, 11 ins. diam., bears S. 56° E., 44.75 ft. dist., mkd. X BT.

A spruce, 16 ins. diam., bears S. 25° E., 44.9 ft., dist., mkd. X BT.

Place a blue DEEP-1 magnet at the base of the alum. post and an orange Carsonite witness post 1 ft. North of the corner.

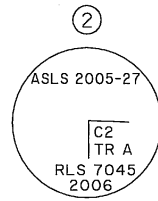

② Set an alum. post, 30 ins. long, 2 1/2 ins. diam., 26 ins. in the ground, with alum. cap mkd. as shown.

From which

A spruce, 12 ins. diam., bears N. 13° E., 97.5 ft. dist., mkd. X BT.

A spruce, 4 ins. diam., bears S. 87° E., 165.6 ft. dist., mkd. X BT.

A twin top spruce, 9 ins. diam., bears S. 76 1/2° W., 80.9 ft., dist., mkd. X BT.

Place a blue DEEP-1 magnet at the base of the alum. post and an orange Carsonite witness post 1 ft. North of the corner.

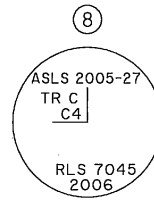

⑧ Set an alum. post, 30 ins. long, 2 1/2 ins. diam., 26 ins. in the ground, with alum. cap mkd. as shown.

From which

A spruce, 14 ins. diam., bears N. 10° E., 36.9 ft. dist., mkd. X BT.

A spruce, 14 ins. diam., bears S. 47° E., 31.8 ft. dist., mkd. X BT.

A spruce, 8 ins. diam., bears N. 74° W., 47.5 ft., dist., mkd. X BT.

Place a blue DEEP-1 magnet at the base of the alum. post and an orange Carsonite witness post 1 ft. North of the corner.

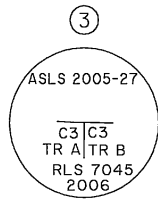

③ Set an alum. post, 30 ins. long, 2 1/2 ins. diam., 26 ins. in the ground, with alum. cap mkd. as shown.

From which

A spruce, 20 ins. diam., bears N. 67° E., 59.1 ft. dist., mkd. X BT.

A spruce, 16 ins. diam., bears S. 50° W., 41.35 ft. dist., mkd. X BT.

A spruce, 20 ins. diam., bears N. 7 1/2° W., 44.1 ft., dist., mkd. X BT.

Place a blue DEEP-1 magnet at the base of the alum. post and an orange Carsonite witness post 1 ft. North of the corner.

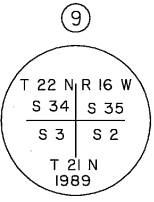

⑨ Recovered an iron post, 2 1/2 ins. diam., firmly set, projecting 3 ins. above the ground, with brass cap mkd. as shown

from which existing bearing trees

A spruce 6 ins. diam., bears S. 34° E., 8.7 ft. dist., with scribe marks T2IN R16W S2 BT visible on an open blaze.

A spruce 4 ins. diam., bears S. 64° W., 26.45 ft. dist., with healed double blaze.

A birch stump 12 ins. diam., bears N. 13° W., 11.3 ft. dist., with bark scribe marks T22N R16W S34 BT visible.

and new bearing trees

A spruce 10 ins. diam., bears N. 24° E., 71.5 ft. dist., marked X BT.

A spruce 12 ins. diam., bears N. 7 1/2° W., 24.1 ft. dist., marked T22N R16W S34 BT.

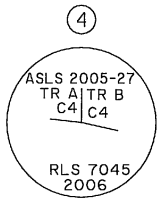

④ Set an alum. post, 30 ins. long, 2 1/2 ins. diam., 26 ins. in the ground, with alum. cap mkd. as shown.

From which

A spruce, 9 ins. diam., bears N. 50 1/2° E., 38.8 ft. dist., mkd. X BT.

A spruce, 16 ins. diam., bears N. 46° W., 87.5 ft. dist., mkd. X BT.

A spruce, 12 ins. diam., bears N. 4° W., 41.9 ft., dist., mkd. X BT.

Place a blue DEEP-1 magnet at the base of the alum. post and an orange Carsonite witness post 1 ft. North of the corner.

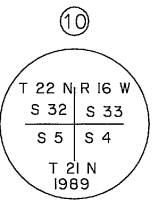

⑩ Recovered an iron post, 2 1/2 ins. diam., firmly set, projecting 2 ins. above the ground, with brass cap mkd. as shown

from which existing bearing trees

A spruce 5 ins. diam., bears N. 75° E., 73.8 ft. dist., with a healed double blaze.

A spruce 6 ins. diam., bears S. 72° E., 32.1 ft. dist., with scribe marks T2IN R16W S4 BT visible on an open blaze.

A spruce 8 ins. diam., bears S. 50° W., 80.2 ft. dist., with a healed blaze.

A birch 4 ins. diam., bears N. 38° W., 52.6 ft. dist., with bark scribe marks X BT visible.

A spruce 12 ins. diam., bears N. 7 1/2° W., 24.1 ft. dist., marked T22N R16W S34 BT.

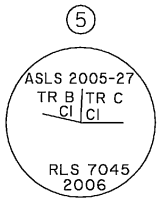

⑤ Set an alum. post, 30 ins. long, 2 1/2 ins. diam., 26 ins. in the ground, with alum. cap mkd. as shown.

From which

A spruce, 6 ins. diam., bears N. 46 1/2° E., 53.1 ft. dist., mkd. X BT.

A spruce, 10 ins. diam., bears S. 84 1/2° E., 42.65 ft. dist., mkd. X BT.

A spruce, 15 ins. diam., bears N. 31° W., 27.5 ft., dist., mkd. X BT.

Place a blue DEEP-1 magnet at the base of the alum. post and an orange Carsonite witness post 1 ft. North of the corner.

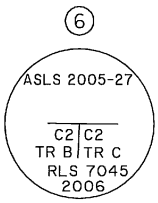

⑥ Set an alum. post, 30 ins. long, 2 1/2 ins. diam., 26 ins. in the ground, with alum. cap mkd. as shown.

From which

A spruce, 11 ins. diam., bears N. 37 1/2° E., 52.0 ft. dist., mkd. X BT.

A spruce, 7 ins. diam., bears S. 34° E., 34.7 ft. dist., mkd. X BT.

A spruce, 8 ins. diam., bears S. 63 1/2° W., 38.9 ft., dist., mkd. X BT.

Place a blue DEEP-1 magnet at the base of the alum. post and an orange Carsonite witness post 1 ft. North of the corner.

SHEET 3 of 10

1 Meter = 3.280833 U.S. Survey Feet 1 U.S. acre = 0.4047 hectare

DATE OF SURVEY: BEGINNING: 10/07/2006 ENDING: 10/14/2006		NAME OF SURVEYOR: The Crazy Mountains JV 2000 E. Dowling Road, #6 Anchorage, AK 99507	
STATE OF ALASKA DEPARTMENT OF NATURAL RESOURCES DIVISION OF MINING LAND AND WATER Anchorage, Alaska			
ALASKA STATE LAND SURVEY NO. 2005-27			
PORCUPINE BUTTE WEST REMOTE RECREATIONAL CABIN SITES CREATING TRACTS A - P WITHIN UNSURVEYED SECTIONS 31 and 32, T. 22 N., R. 15 W., SECTIONS 1, 2, & 3, T. 21 N., R. 16 W., and SECTION 34, T. 22 N., R. 16 W., all of the SEWARD MERIDIAN, ALASKA ANCHORAGE RECORDING DISTRICT Containing 290.66 Acres			
DRAWN BY: JEM		APPROVAL RECOMMENDED	
DATE: 1/7/2008		<i>William S. Brown</i> 7-24-08	
SCALE: 1" = 200'		STATEWIDE PLATTING SUPERVISOR DATE	
CHECKED BY: KJL		File No. ASLS 20050027	

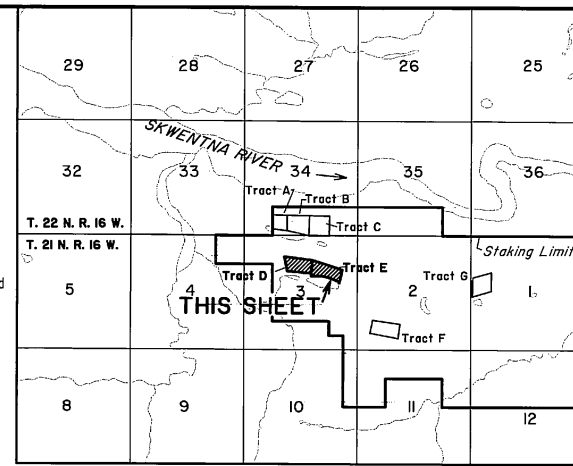

VICINITY MAP
Source: USGS DLG TYONEK D-6
Scale 1" = 1 mile

BLM Record NAD27 Position
Lat. 61°56'48.023" N.
Long. 152°10'12.203" W.
Computed using BLM plat of
T. 22 N., R. 16 W., Seward Meridian,
Alaska filed June 17, 1996

See Sheet 3
T22N R16W
S34 S35
S3 S2
T21N
1989

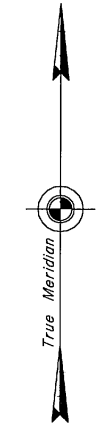

2006 Mean
Magnetic
Declination
19 3/4° E.
See Note H

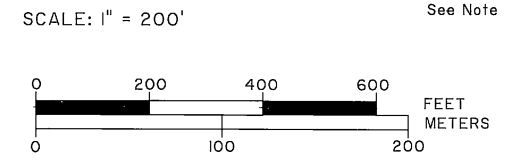

1 Meter = 3.280833 U.S. Survey Feet | U.S. acre = 0.4047 hectare

DATE OF SURVEY: BEGINNING: 10/07/2006 ENDING: 10/14/2006	NAME OF SURVEYOR: The Crazy Mountains JV 2000 E. Dowling Road, #6 Anchorage, AK 99507
--	--

STATE OF ALASKA
DEPARTMENT OF NATURAL RESOURCES
DIVISION OF MINING LAND AND WATER
Anchorage, Alaska

ALASKA STATE LAND SURVEY NO. 2005-27
PORCUPINE BUTTE WEST REMOTE RECREATIONAL CABIN SITES
CREATING TRACTS A - P
WITHIN UNSURVEYED SECTIONS 31 and 32, T. 22 N., R. 15 W., SECTIONS 1, 2, & 3,
T. 21 N., R. 16 W., and SECTION 34, T. 22 N., R. 16 W., all of the SEWARD MERIDIAN, ALASKA
ANCHORAGE RECORDING DISTRICT
Containing 290.66 Acres

DRAWN BY: JEM	APPROVAL RECOMMENDED <i>William S. Brown</i> 9-24-08
DATE: 1/7/2008	FOR STATEWIDE PLATTING SUPERVISOR DATE
SCALE: 1" = 200'	CHECKED BY: KJL File No. ASLS 20050027

17 Set an alum. post, 30 ins. long, 2 1/2 ins. diam., 26 ins. in the ground, with alum. cap mkd. as shown.
From which
A spruce, 7 ins. diam., bears S. 33° W., 42.3 ft. dist., mkd. X BT.
A spruce, 9 ins. diam., bears S. 65° W., 43.6 ft. dist., mkd. X BT.
A spruce, 15 ins. diam., bears N. 54° W., 28.3 ft., dist., mkd. X BT.
Place a blue DEEP-I magnet at the base of the alum. post and an orange Carsonite witness post 1 ft. North of the corner.

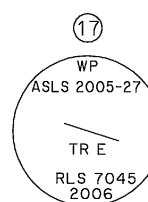

16 Set an alum. post, 30 ins. long, 2 1/2 ins. diam., 26 ins. in the ground, with alum. cap mkd. as shown.
From which
A spruce, 9 ins. diam., bears N. 23 1/2° E., 20.4 ft. dist., mkd. X BT.
A spruce, 5 ins. diam., bears S. 38° E., 24.2 ft. dist., mkd. X BT.
A spruce, 5 ins. diam., bears N. 30° W., 12.0 ft., dist., mkd. X BT.
Place a blue DEEP-I magnet at the base of the alum. post and an orange Carsonite witness post 1 ft. North of the corner.

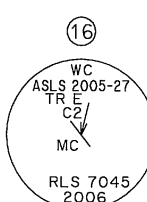

11 Set an alum. post, 30 ins. long, 2 1/2 ins. diam., 26 ins. in the ground, with alum. cap mkd. as shown.
From which
A spruce, 13 ins. diam., bears S. 89 1/2° E., 70.0 ft. dist., mkd. X BT.
A spruce, 15 ins. diam., bears S. 25 1/2° W., 27.1 ft. dist., mkd. X BT.
A spruce, 16 ins. diam., bears N. 35 1/2° W., 21.4 ft., dist., mkd. X BT.
Place a blue DEEP-I magnet at the base of the alum. post and an orange Carsonite witness post 1 ft. North of the corner.

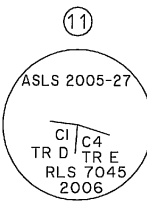

15 Set an alum. post, 30 ins. long, 2 1/2 ins. diam., 26 ins. in the ground, with alum. cap mkd. as shown.
From which
A spruce, 14 ins. diam., bears N. 43 1/2° E., 14.5 ft. dist., mkd. X BT.
A spruce, 13 ins. diam., bears S. 78° E., 16.8 ft. dist., mkd. X BT.
A spruce, 14 ins. diam., bears N. 36 1/4° W., 64.3 ft., dist., mkd. X BT.
Place a blue DEEP-I magnet at the base of the alum. post and an orange Carsonite witness post 1 ft. North of the corner.

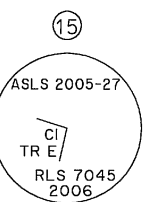

12 Set an alum. post, 30 ins. long, 2 1/2 ins. diam., 26 ins. in the ground, with alum. cap mkd. as shown.
From which
A spruce, 11 ins. diam., bears N. 8° E., 114.9 ft. dist., mkd. X BT.
A spruce, 5 ins. diam., bears S. 41 3/4° E., 50.2 ft. dist., mkd. X BT.
A twin top spruce, 9 ins. diam., bears S. 82 1/2° W., 51.2 ft., dist., mkd. X BT.
Place a blue DEEP-I magnet at the base of the alum. post and an orange Carsonite witness post 1 ft. North of the corner.

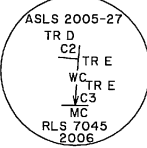

13 Set an alum. post, 30 ins. long, 2 1/2 ins. diam., 26 ins. in the ground, with alum. cap mkd. as shown.
From which
A spruce, 6 ins. diam., bears N. 50 1/2° E., 81.1 ft. dist., mkd. X BT.
A spruce, 9 ins. diam., bears S. 73 1/2° E., 68.8 ft. dist., mkd. X BT.
A spruce, 9 ins. diam., bears S. 66 1/2° W., 40.9 ft., dist., mkd. X BT.
Place a blue DEEP-I magnet at the base of the alum. post and an orange Carsonite witness post 1 ft. North of the corner.

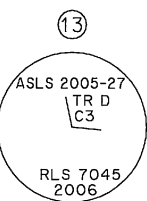

14 Set an alum. post, 30 ins. long, 2 1/2 ins. diam., 26 ins. in the ground, with alum. cap mkd. as shown.
From which
A spruce, 13 ins. diam., bears N. 77° E., 82.9 ft. dist., mkd. X BT.
A spruce, 18 ins. diam., bears S. 5° W., 34.5 ft. dist., mkd. X BT.
A birch, 16 ins. diam., bears S. 42° W., 26.8 ft., dist., mkd. X BT.
Place a blue DEEP-I magnet at the base of the alum. post and an orange Carsonite witness post 1 ft. North of the corner.

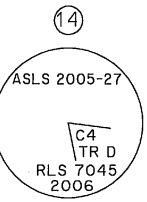

SEE PLAT NOTE K FOR BASE FLOOD ELEVATION AND FLOOD HAZARD INFORMATION

STATE OF ALASKA
Unsubdivided

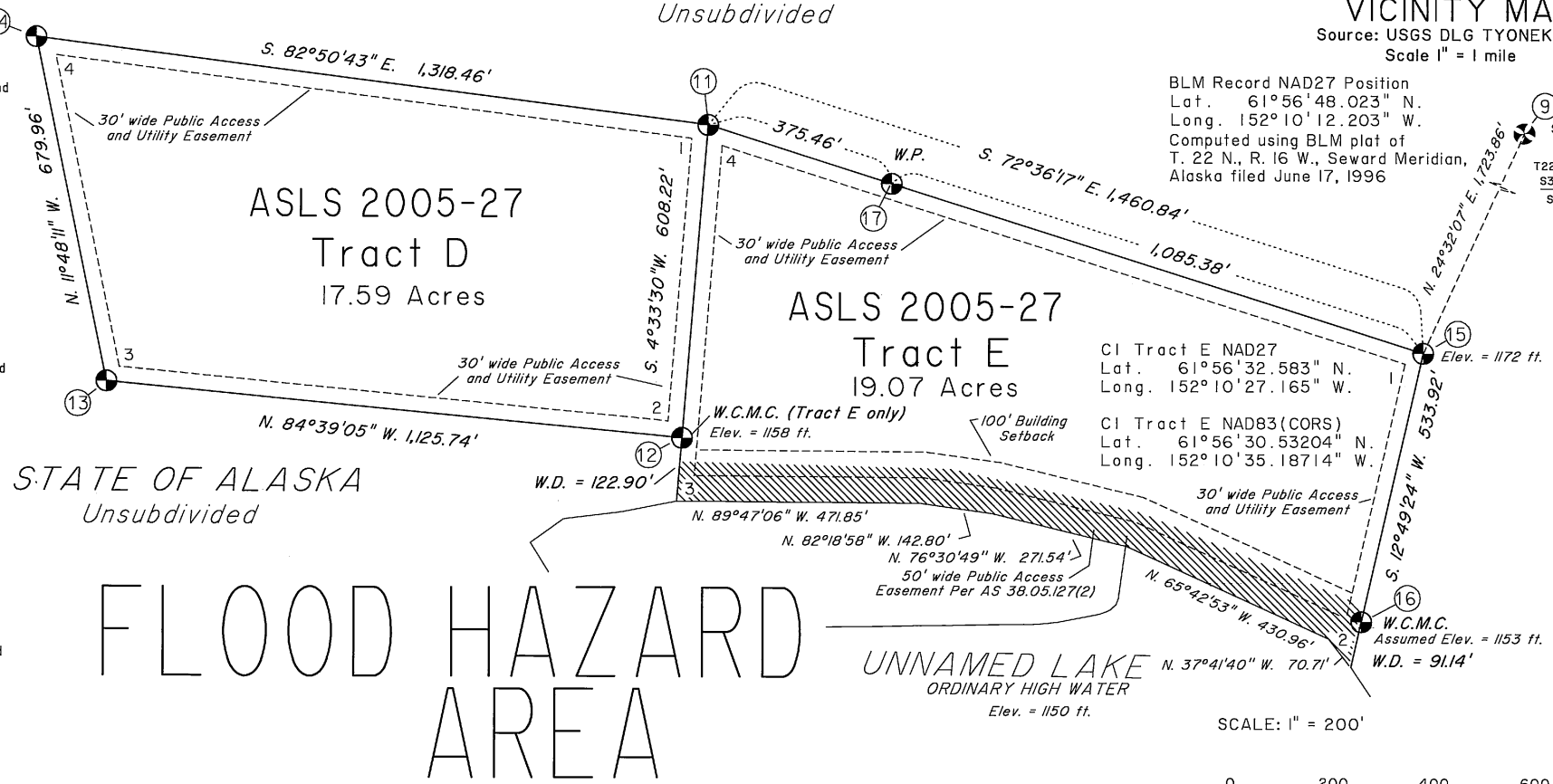

STATE OF ALASKA
Unsubdivided

FLOOD HAZARD AREA

UNNAMED LAKE
ORDINARY HIGH WATER
Elev. = 1150 ft.

APPLICANT CERTIFICATE

I, THE UNDERSIGNED, HEREBY CERTIFY THAT I AM THE APPLICANT OF TRACT D, ASLS 2005-27, ADL 229140 AS SHOWN HEREON. I HEREBY APPROVE THIS SURVEY AND PLAT.

DATE: N/A

JASON R. MARKLE
6020 MORE LANE
ANCHORAGE, ALASKA 99504

NOTARY'S ACKNOWLEDGEMENT

SUBSCRIBED AND SWORN TO BEFORE ME THIS 28 DAY OF MAY, 2008.

BY: N/A

NOTARY FOR THE STATE OF ALASKA
MY COMMISSION EXPIRES _____

APPLICANT CERTIFICATE

I, THE UNDERSIGNED, HEREBY CERTIFY THAT I AM THE APPLICANT OF TRACT E, ASLS 2005-27, ADL 229136 AS SHOWN HEREON. I HEREBY APPROVE THIS SURVEY AND PLAT.

DATE: 5-28-08

JEFFERE S. EDWARDS
1240 DURENDA CIRCLE
ANCHORAGE, ALASKA 99507

NOTARY'S ACKNOWLEDGEMENT

SUBSCRIBED AND SWORN TO BEFORE ME THIS 28 DAY OF MAY, 2008.

BY: JEFFERE S. EDWARDS

NOTARY FOR THE STATE OF ALASKA
MY COMMISSION EXPIRES 11/01/08

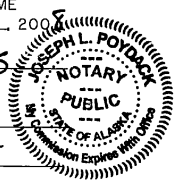

LEGEND

- BLM/GLO Monument Recovered
- Primary monument set this survey
- Corner Designation
- Surveyed Line
- Unsurveyed Line
- Measured this survey
- Record Per BLM
- Protracted Section Line
- Flood Hazard Area

NOTE: THERE IS NO APPLICANT FOR TRACT D (ADL 229140).

Anchorage Recording District Plat 2008-114

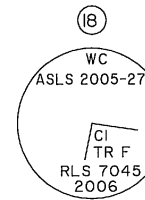

18 Set an alum. post, 30 ins. long, 2 1/2 ins. diam., 26 ins. in the ground, with alum. cap mkd. as shown.

From which

A spruce, 9 ins. diam., bears S. 69° E., 66.5 ft. dist., mkd. X BT.

A spruce, 12 ins. diam., bears S. 28 1/2° E., 27.8 ft. dist., mkd. X BT.

The north trunk of a double spruce, 8 ins. diam., bears S. 88° W., 25.3 ft., dist. mkd. X BT.

Place a blue DEEP-I magnet at the base of the alum. post and an orange Carsonite witness post 1 ft. North of the corner.

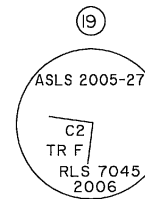

19 Set an alum. post, 30 ins. long, 2 1/2 ins. diam., 26 ins. in the ground, with alum. cap mkd. as shown.

From which

A spruce, 5 ins. diam., bears N. 21° E., 68.8 ft. dist., mkd. X BT.

A spruce, 5 ins. diam., bears S. 79 1/2° E., 56.0 ft. dist., mkd. X BT.

A spruce, 12 ins. diam., bears N. 87° W., 46.3 ft., dist., mkd. X BT.

Place a blue DEEP-I magnet at the base of the alum. post and an orange Carsonite witness post 1 ft. North of the corner.

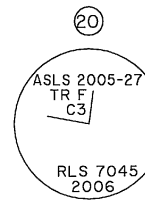

20 Set an alum. post, 30 ins. long, 2 1/2 ins. diam., 26 ins. in the ground, with alum. cap mkd. as shown.

From which

A birch, 13 ins. diam., bears N. 59 1/2° E., 44.0 ft. dist., mkd. X BT.

A birch, 15 ins. diam., bears N. 67 1/2° E., 44.0 ft. dist., mkd. X BT.

A birch, 15 ins. diam., bears S. 82 1/2° W., 85.4 ft., dist., mkd. X BT.

Place a blue DEEP-I magnet at the base of the alum. post and an orange Carsonite witness post 1 ft. North of the corner.

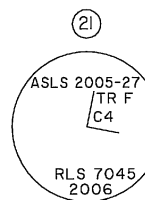

21 Set an alum. post, 30 ins. long, 2 1/2 ins. diam., 26 ins. in the ground, with alum. cap mkd. as shown.

From which

A spruce, 9 ins. diam., bears N. 12° E., 63.6 ft. dist., mkd. X BT.

A birch, 22 ins. diam., bears S. 74 1/2° E., 54.6 ft. dist., mkd. X BT.

A birch, 14 ins. diam., bears S. 46 1/2° W., 69.8 ft., dist., mkd. X BT.

Place a blue DEEP-I magnet at the base of the alum. post and an orange Carsonite witness post 1 ft. North of the corner.

LEGEND

- ⊗ BLM/GLO Monument Recovered
- Primary monument set this survey
- ① Corner Designation
- Surveyed Line
- Unsurveyed Line
- (m) Measured this survey
- (r) Record Per BLM
- Protracted Section Line

See Sheet 3

T22N R16W
S34 S35
S3 S2
T21N

BLM Record NAD27 Position
Lat. 61°56'48.023" N.
Long. 152°10'12.203" W.
Computed using BLM plat of
T. 22 N., R. 16 W., Seward Meridian,
Alaska filed June 17, 1996

APPLICANT CERTIFICATE

I, THE UNDERSIGNED, HEREBY CERTIFY THAT I AM THE APPLICANT OF TRACT F, ASLS 2005-27, ADL 229293 AS SHOWN HEREON. I HEREBY APPROVE THIS SURVEY AND PLAT.

DATE: 5/13/08
Kirsten Dixon, Attorney in Good Faith for Jami Forbes
JAMI FORBES
2626 GALEWOOD ST.
ANCHORAGE, ALASKA 99508

NOTARY'S ACKNOWLEDGEMENT

SUBSCRIBED AND SWORN TO BEFORE ME
THIS 13 DAY OF MAY, 2008.
BY KIRSTEN DIXON

Joe Palk
NOTARY FOR THE STATE OF ALASKA
MY COMMISSION EXPIRES WITH OFFICE

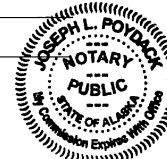

CI Tract F NAD27
Lat. 61°56'09.595" N.
Long. 152°09'57.506" W.

CI Tract F NAD83(CORS)
Lat. 61°56'07.54394" N.
Long. 152°10'05.52690" W.

STATE OF ALASKA
Unsubdivided

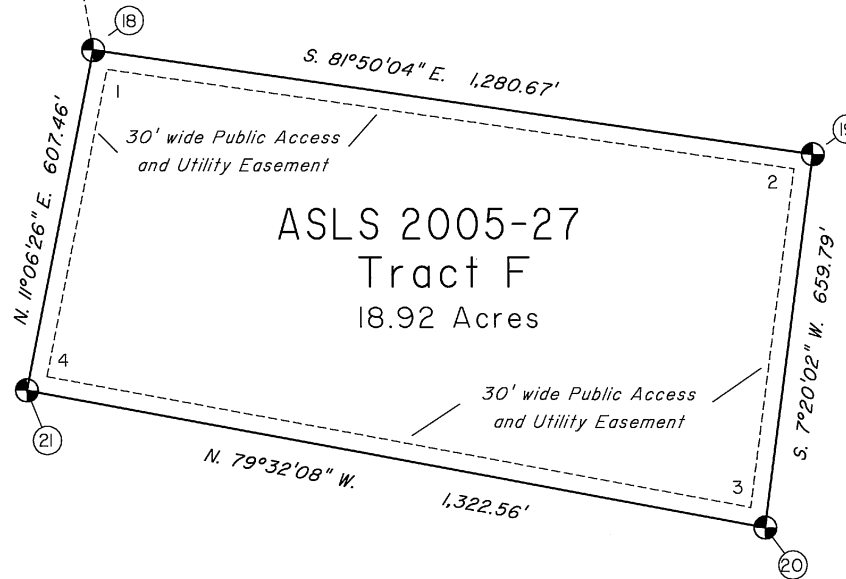

STATE OF ALASKA
Unsubdivided

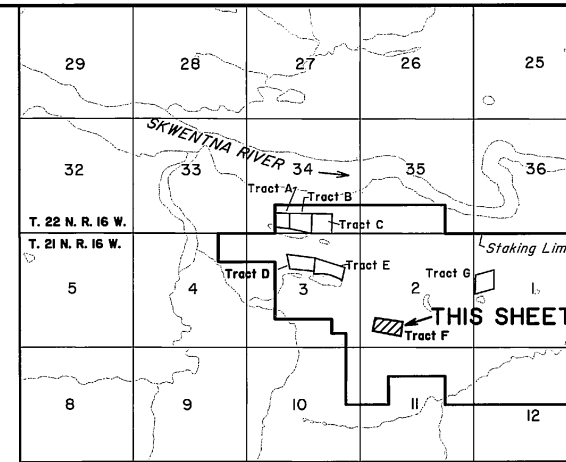

VICINITY MAP
Source: USGS DLG TYONEK D-6
Scale 1" = 1 mile

STATE OF ALASKA
Unsubdivided

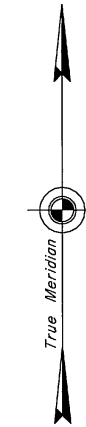

2006 Mean
Magnetic
Declination
19 3/4° E.
See Note H

SCALE: 1" = 200'

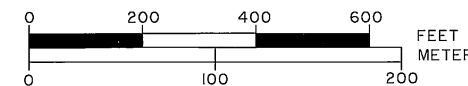

1 Meter = 3.280833 U.S. Survey Feet | U.S. acre = 0.4047 hectare

DATE OF SURVEY: BEGINNING: 10/07/2006 ENDING: 10/14/2006	NAME OF SURVEYOR: The Crazy Mountains JV 2000 E. Dowling Road, #6 Anchorage, AK 99507
STATE OF ALASKA DEPARTMENT OF NATURAL RESOURCES DIVISION OF MINING LAND AND WATER Anchorage, Alaska	
ALASKA STATE LAND SURVEY NO. 2005-27 PORCUPINE BUTTE WEST REMOTE RECREATIONAL CABIN SITES CREATING TRACTS A - P WITHIN UNSURVEYED SECTIONS 31 and 32, T. 22 N., R. 15 W., SECTIONS 1, 2, & 3, T. 21 N., R. 16 W., and SECTION 34, T. 22 N., R. 16 W., all of the SEWARD MERIDIAN, ALASKA ANCHORAGE RECORDING DISTRICT Containing 290.66 Acres	
DRAWN BY: JEM DATE: 1/7/2008	APPROVAL RECOMMENDED <u>William S. Brown</u> 7-24-08 STATEWIDE PLATTING SUPERVISOR DATE
SCALE: 1" = 200'	CHECKED BY: KJL File No. ASLS 20050027

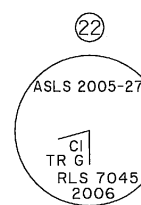

22 Set an alum. post, 30 ins. long, 2 1/2 ins. diam., 26 ins. in the ground, with alum. cap mkd. as shown.

From which

A spruce, 9 ins. diam., bears N. 81° E., 27.3 ft. dist., mkd. X BT.

A spruce, 8 ins. diam., bears S. 68 1/4° W., 75.3 ft. dist., mkd. X BT.

A spruce, 15 ins. diam., bears N. 41 1/2° W., 39.2 ft., dist., mkd. X BT.

Place a blue DEEP-I magnet at the base of the alum. post and an orange Carsonite witness post 1 ft. North of the corner.

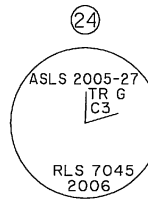

24 Set an alum. post, 30 ins. long, 2 1/2 ins. diam., 26 ins. in the ground, with alum. cap mkd. as shown.

From which

A spruce, 15 ins. diam., bears N. 74° E., 19.6 ft. dist., mkd. X BT.

A spruce, 5 ins. diam., bears S. 71 1/2° E., 19.7 ft. dist., mkd. X BT.

A spruce, 15 ins. diam., bears N. 76 1/2° W., 30.7 ft., dist., mkd. X BT.

Place a blue DEEP-I magnet at the base of the alum. post and an orange Carsonite witness post 1 ft. North of the corner.

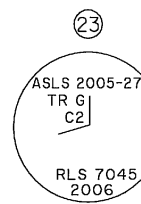

23 Set an alum. post, 30 ins. long, 2 1/2 ins. diam., 26 ins. in the ground, with alum. cap mkd. as shown.

From which

A spruce, 9 ins. diam., bears N. 47° E., 29.3 ft. dist., mkd. X BT.

A spruce, 8 ins. diam., bears S. 11 1/2° E., 23.4 ft. dist., mkd. X BT.

A spruce, 14 ins. diam., bears N. 86 3/4° W., 49.2 ft., dist., mkd. X BT.

Place a blue DEEP-I magnet at the base of the alum. post and an orange Carsonite witness post 1 ft. North of the corner.

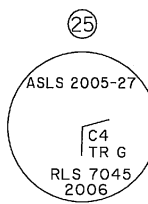

25 Set an alum. post, 30 ins. long, 2 1/2 ins. diam., 26 ins. in the ground, with alum. cap mkd. as shown.

From which

A spruce, 6 ins. diam., bears N. 67 1/4° E., 27.5 ft. dist., mkd. X BT.

A spruce, 8 ins. diam., bears S. 51 1/2° E., 34.4 ft. dist., mkd. X BT.

A spruce, 5 ins. diam., bears S. 81° W., 52.6 ft., dist., mkd. X BT.

Place a blue DEEP-I magnet at the base of the alum. post and an orange Carsonite witness post 1 ft. North of the corner.

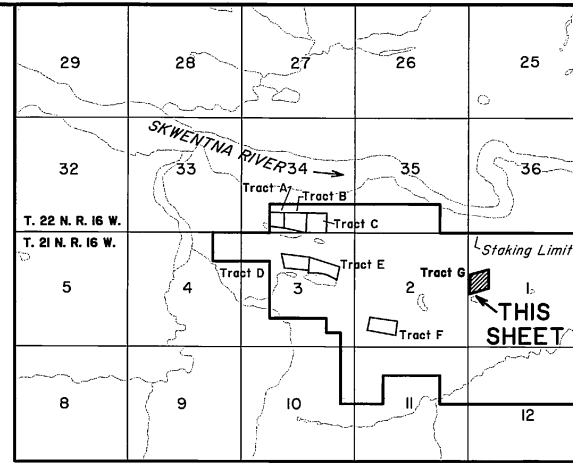

VICINITY MAP
Source: USGS DLG TYONEK D-6
Scale 1" = 1 mile

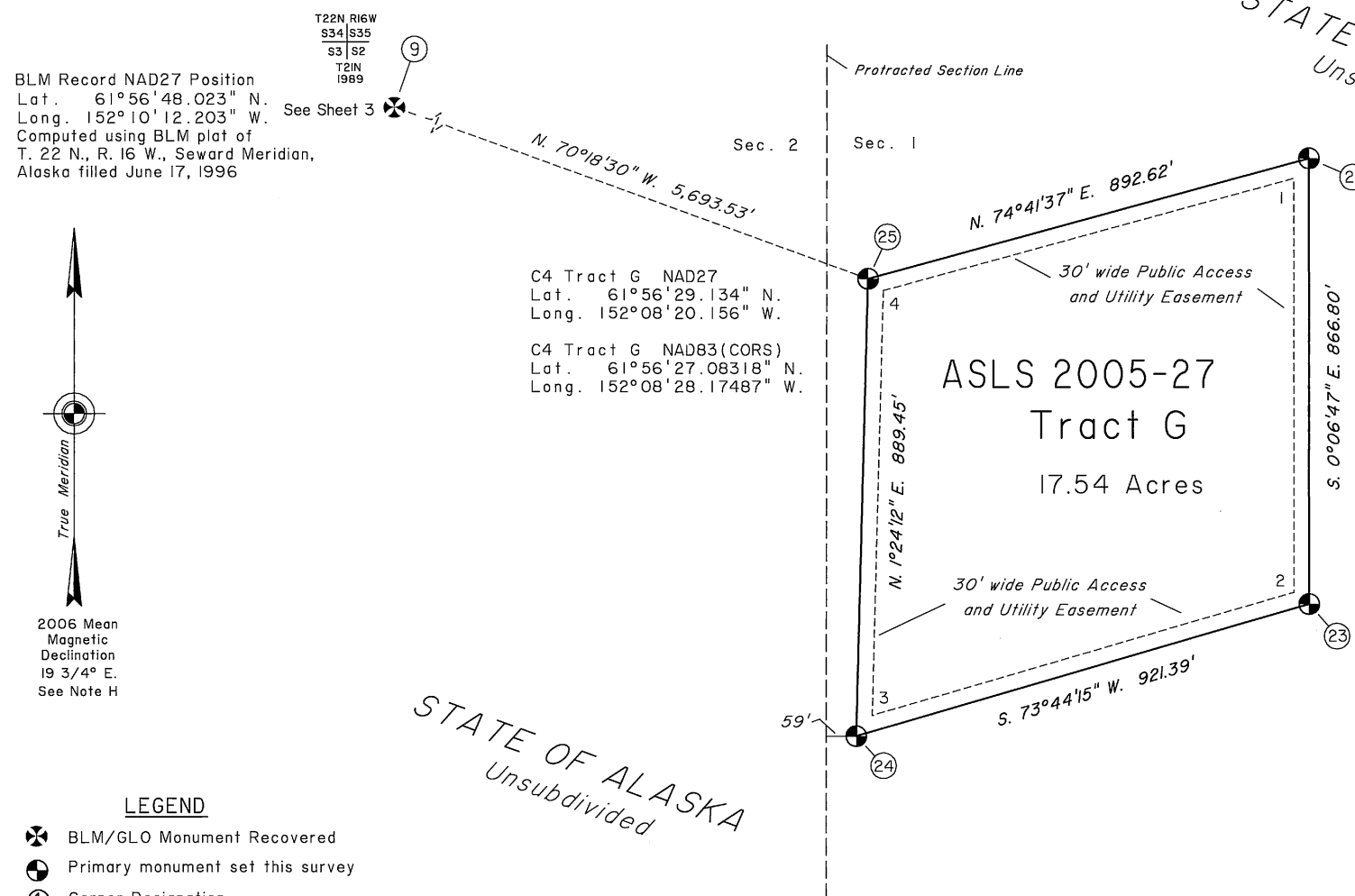

BLM Record NAD27 Position
Lat. 61°56'48.023" N.
Long. 152°10'12.203" W.
Computed using BLM plat of
T. 22 N., R. 16 W., Seward Meridian,
Alaska filed June 17, 1996

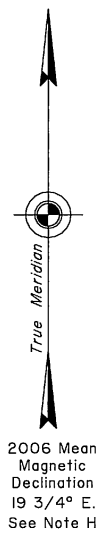

- LEGEND**
- ⊗ BLM/GLO Monument Recovered
 - Primary monument set this survey
 - Corner Designation
 - Surveyed Line
 - - - Unsurveyed Line
 - (m) Measured this survey
 - (r) Record Per BLM
 - - - Protracted Section Line

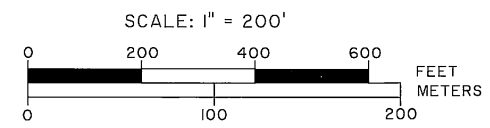

STATE OF ALASKA
Unsubdivided

STATE OF ALASKA
Unsubdivided

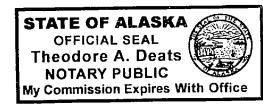

APPLICANT CERTIFICATE

I, THE UNDERSIGNED, HEREBY CERTIFY THAT I AM THE APPLICANT OF TRACT G, ASLS 2005-27, ADL 229245 AS SHOWN HEREON. I HEREBY APPROVE THIS SURVEY AND PLAT.

DATE: 4/6/08

Maeagan Mackey
MAEGAN MACKEY
P.O. Box 109
CHITINA, ALASKA 99566

NOTARY'S ACKNOWLEDGEMENT

SUBSCRIBED AND SWORN TO BEFORE ME
THIS 6th DAY OF June, 2008

BY: Theodore A. Deats
for Maeagan Mackey
NOTARY FOR THE STATE OF ALASKA
MY COMMISSION EXPIRES with office

1 Meter = 3.280833 U.S. Survey Feet | U.S. acre = 0.4047 hectare

DATE OF SURVEY: BEGINNING: 10/07/2006 ENDING: 10/14/2006	NAME OF SURVEYOR: The Crazy Mountains JV 2000 E. Dowling Road, #6 Anchorage, AK 99507
STATE OF ALASKA DEPARTMENT OF NATURAL RESOURCES DIVISION OF MINING LAND AND WATER Anchorage, Alaska	
ALASKA STATE LAND SURVEY NO. 2005-27	
PORCUPINE BUTTE WEST REMOTE RECREATIONAL CABIN SITES CREATING TRACTS A - P WITHIN UNSURVEYED SECTIONS 31 and 32, T. 22 N., R. 15 W., SECTIONS 1, 2, & 3, T. 21 N., R. 16 W., and SECTION 34, T. 22 N., R. 16 W., all of the SEWARD MERIDIAN, ALASKA ANCHORAGE RECORDING DISTRICT Containing 290.66 Acres	
DRAWN BY: JEM	APPROVAL RECOMMENDED
DATE: 1/7/2008	<u>William S. Brown 7-29-08</u>
SCALE: 1" = 200'	CHECKED BY: KJL STATEWIDE PLATTING SUPERVISOR DATE
	File No. ASLS 20050027

LEGEND

- ⊗ BLM/GLO Monument Recovered
- ⊙ Primary monument set this survey
- ⊙ Corner Designation
- Surveyed Line
- - - Unsurveyed Line
- (m) Measured this survey
- (r) Record Per BLM
- - - Protracted Section Line

STATE OF ALASKA
Unsubdivided

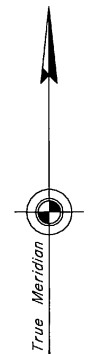

2006 Mean
Magnetic
Declination
19 3/4° E.
See Note H

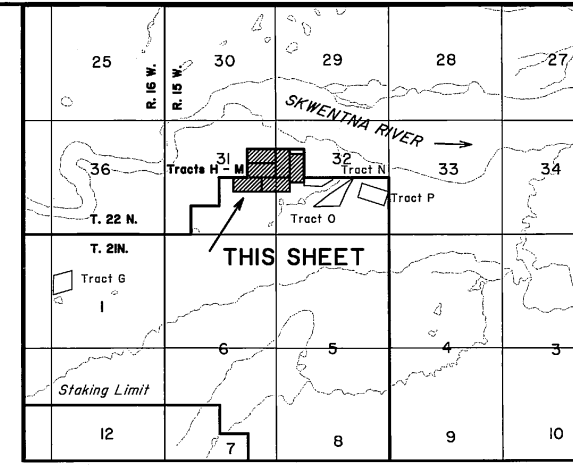

VICINITY MAP

Source: USGS DLG TYONEK D-6
Scale 1" = 1 mile

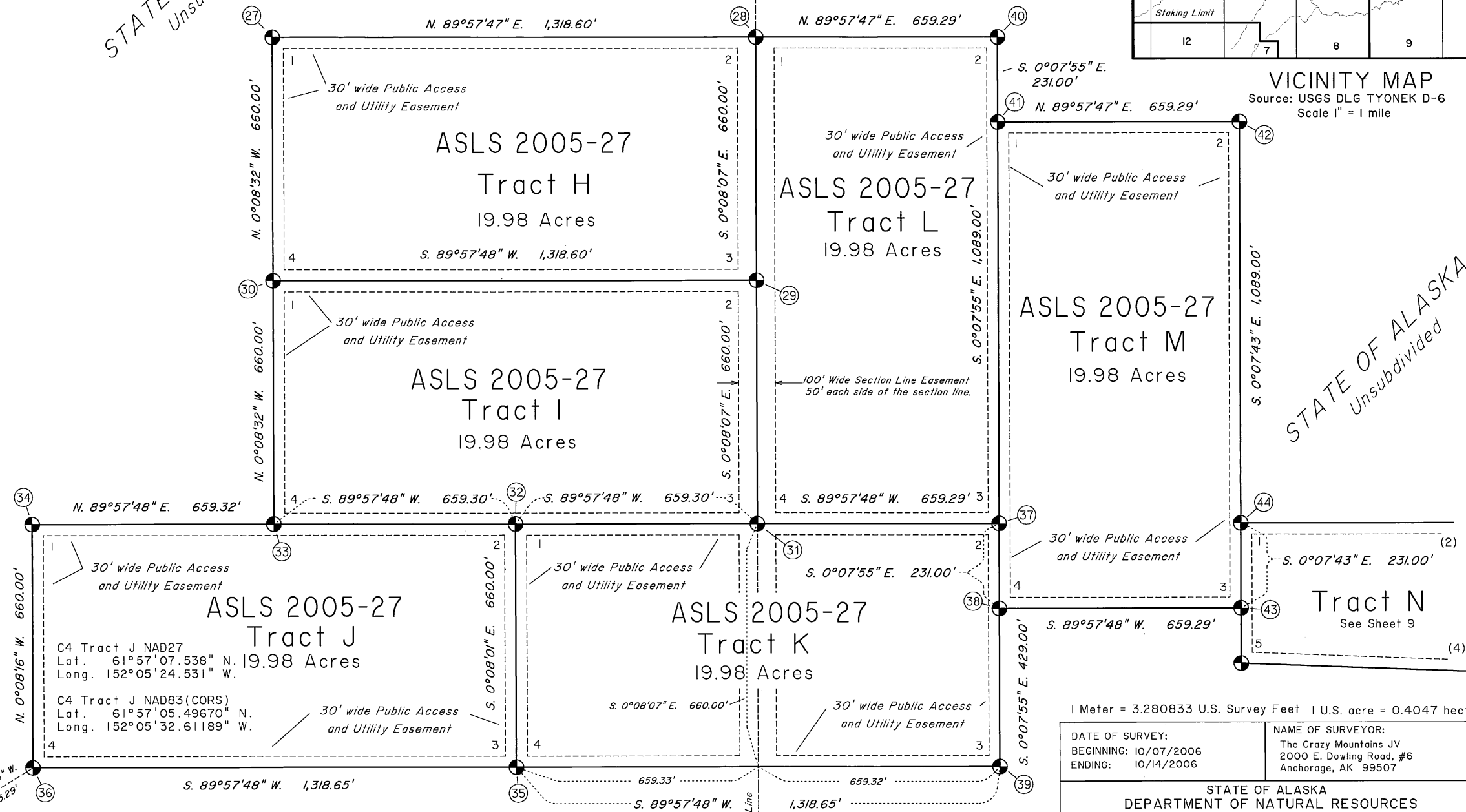

STATE OF ALASKA
Unsubdivided

T22N
R16W R15W
S36 S31
S1 S6
T21N
R16W
1969
See Sheet 10

BLM Record NAD27 Position
Lat 61°56'48.02" N.
Long. 152°06'31.46" W.
BLM plat of T. 22 N., R. 16 W.,
Seward Meridian, Alaska
filled June 17, 1996

SEE SHEET 8 FOR MONUMENT DESCRIPTIONS
AND APPLICANTS' CERTIFICATES

Sec. 31

Sec. 32

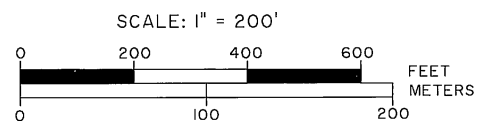

SHEET 7 of 10

1 Meter = 3.280833 U.S. Survey Feet 1 U.S. acre = 0.4047 hectare

DATE OF SURVEY: BEGINNING: 10/07/2006 ENDING: 10/14/2006	NAME OF SURVEYOR: The Crazy Mountains JV 2000 E. Dowling Road, #6 Anchorage, AK 99507
--	--

STATE OF ALASKA
DEPARTMENT OF NATURAL RESOURCES
DIVISION OF MINING LAND AND WATER
Anchorage, Alaska

ALASKA STATE LAND SURVEY NO. 2005-27

PORCUPINE BUTTE WEST REMOTE RECREATIONAL CABIN SITES
CREATING TRACTS A - P
WITHIN UNSURVEYED SECTIONS 31 and 32, T. 22 N., R. 15 W., SECTIONS 1, 2, & 3,
T. 21 N., R. 16 W., and SECTION 34, T. 22 N., R. 16 W., all of the SEWARD MERIDIAN, ALASKA
ANCHORAGE RECORDING DISTRICT
Containing 290.66 Acres

DRAWN BY: JEM	APPROVAL RECOMMENDED
DATE: 1/7/2008	for <i>William S. Brown</i> 7-29-08
SCALE: 1" = 200'	CHECKED BY: KJL File No. ASLS 20050027

27 Set an alum. post, 30 ins. long, 2 1/2 ins. diam., 26 ins. in the ground, with alum. cap mkd. as shown.

From which

A birch, 22 ins. diam., bears S. 2° E., 35.0 ft. dist., mkd. X BT.

A spruce, 8 ins. diam., bears N. 53° W., 28.9 ft. dist., mkd. X BT.

A birch, 9 ins. diam., bears N. 1° W., 29.9 ft., dist., mkd. X BT.

Place a blue DEEP-I magnet at the base of the alum. post and an orange Carsonite witness post 1 ft. North of the corner.

28 Set an alum. post, 30 ins. long, 2 1/2 ins. diam., 26 ins. in the ground, with alum. cap mkd. as shown.

From which

A birch, 11 ins. diam., bears S. 64° E., 64.1 ft. dist., mkd. X BT.

A birch, 12 ins. diam., bears S. 1° E., 73.8 ft. dist., mkd. X BT.

A spruce, 14 ins. diam., bears N. 70 1/4° W., 87.3 ft., dist., mkd. X BT.

Place a blue DEEP-I magnet at the base of the alum. post and an orange Carsonite witness post 1 ft. North of the corner.

29 Set an alum. post, 30 ins. long, 2 1/2 ins. diam., 26 ins. in the ground, with alum. cap mkd. as shown.

From which

A spruce, 6 ins. diam., bears N. 48 1/2° E., 45.8 ft. dist., mkd. X BT.

A spruce, 13 ins. diam., bears S. 62 1/2° E., 40.7 ft. dist., mkd. X BT.

A spruce, 12 ins. diam., bears S. 59° W., 12.5 ft., dist., mkd. X BT.

Place a blue DEEP-I magnet at the base of the alum. post and an orange Carsonite witness post 1 ft. North of the corner.

30 Set an alum. post, 30 ins. long, 2 1/2 ins. diam., 26 ins. in the ground, with alum. cap mkd. as shown.

From which

A spruce, 12 ins. diam., bears N. 72 1/2° E., 90.2 ft. dist., mkd. X BT.

A spruce, 8 ins. diam., bears S. 26° E., 69.0 ft. dist., mkd. X BT.

A spruce, 15 ins. diam., bears N. 25 1/2° W., 47.1 ft., dist., mkd. X BT.

Place a blue DEEP-I magnet at the base of the alum. post and an orange Carsonite witness post 1 ft. North of the corner.

31 Set an alum. post, 30 ins. long, 2 1/2 ins. diam., 26 ins. in the ground, with alum. cap mkd. as shown.

From which

A spruce, 11 ins. diam., bears S. 67 1/2° E., 28.7 ft. dist., mkd. X BT.

A spruce, 12 ins. diam., bears S. 6° W., 39.4 ft. dist., mkd. X BT.

A spruce, 8 ins. diam., bears N. 65° W., 34.2 ft., dist., mkd. X BT.

Place a blue DEEP-I magnet at the base of the alum. post and an orange Carsonite witness post 0.6 ft. North of the corner.

32 Set an alum. post, 30 ins. long, 2 1/2 ins. diam., 26 ins. in the ground, with alum. cap mkd. as shown.

From which

A spruce, 11 ins. diam., bears S. 71 1/2° E., 45.4 ft. dist., mkd. X BT.

A spruce, 11 ins. diam., bears S. 24° W., 25.6 ft. dist., mkd. X BT.

A spruce, 9 ins. diam., bears N. 36° W., 26.7 ft., dist., mkd. X BT.

Place a blue DEEP-I magnet at the base of the alum. post and an orange Carsonite witness post 1 ft. North of the corner.

33 Set an alum. post, 30 ins. long, 2 1/2 ins. diam., 26 ins. in the ground, with alum. cap mkd. as shown.

From which

A spruce, 9 ins. diam., bears N. 40 1/2° E., 51.5 ft. dist., mkd. X BT.

A spruce, 6 ins. diam., bears S. 59° E., 33.6 ft. dist., mkd. X BT.

A spruce, 9 ins. diam., bears S. 24° W., 30.1 ft., dist., mkd. X BT.

Place a blue DEEP-I magnet at the base of the alum. post and an orange Carsonite witness post 1 ft. North of the corner.

34 Set an alum. post, 30 ins. long, 2 1/2 ins. diam., 26 ins. in the ground, with alum. cap mkd. as shown.

From which

A spruce, 11 ins. diam., bears N. 17° E., 35.2 ft. dist., mkd. X BT.

A spruce, 8 ins. diam., bears N. 85° E., 30.4 ft. dist., mkd. X BT.

A spruce, 10 ins. diam., bears S. 82 1/2° W., 76.2 ft., dist., mkd. X BT.

Place a blue DEEP-I magnet at the base of the alum. post and an orange Carsonite witness post 1 ft. North of the corner.

35 Set an alum. post, 30 ins. long, 2 1/2 ins. diam., 26 ins. in the ground, with alum. cap mkd. as shown.

From which

A spruce, 11 ins. diam., bears N. 46° E., 54.2 ft. dist., mkd. X BT.

A spruce, 15 ins. diam., bears S. 64° E., 47.4 ft. dist., mkd. X BT.

A spruce, 11 ins. diam., bears N. 59° W., 38.9 ft., dist., mkd. X BT.

Place a blue DEEP-I magnet at the base of the alum. post and an orange Carsonite witness post 1 ft. North of the corner.

36 Set an alum. post, 30 ins. long, 2 1/2 ins. diam., 26 ins. in the ground, with alum. cap mkd. as shown.

From which

A spruce, 12 ins. diam., bears S. 12° W., 76.4 ft. dist., mkd. X BT.

A spruce, 6 ins. diam., bears N. 59 1/2° W., 41.6 ft. dist., mkd. X BT.

A spruce, 5 ins. diam., bears N. 2° W., 11.9 ft., dist., mkd. X BT.

Place a blue DEEP-I magnet at the base of the alum. post and an orange Carsonite witness post 1 ft. North of the corner.

37 Set an alum. post, 30 ins. long, 2 1/2 ins. diam., 26 ins. in the ground, with alum. cap mkd. as shown.

From which

A spruce, 9 ins. diam., bears N. 10 1/2° E., 104.3 ft. dist., mkd. X BT.

A spruce, 15 ins. diam., bears S. 71 1/2° W., 55.9 ft. dist., mkd. X BT.

A spruce, 14 ins. diam., bears N. 32 1/2° W., 78.8 ft., dist., mkd. X BT.

Place a blue DEEP-I magnet at the base of the alum. post and an orange Carsonite witness post 1 ft. North of the corner.

38 Set an alum. post, 30 ins. long, 2 1/2 ins. diam., 26 ins. in the ground, with alum. cap mkd. as shown.

From which

A spruce, 7 ins. diam., bears N. 24° E., 76.5 ft. dist., mkd. X BT.

A birch, 12 ins. diam., bears S. 63 1/2° E., 91.9 ft. dist., mkd. X BT.

A spruce, 15 ins. diam., bears S. 32 1/2° E., 85.1 ft., dist., mkd. X BT.

Place a blue DEEP-I magnet at the base of the alum. post and an orange Carsonite witness post 1 ft. North of the corner.

39 Set an alum. post, 30 ins. long, 2 1/2 ins. diam., 26 ins. in the ground, with alum. cap mkd. as shown.

From which

A spruce, 12 ins. diam., bears S. 86 1/2° E., 112.8 ft. dist., mkd. X BT.

A spruce, 16 ins. diam., bears S. 54 1/2° W., 25.9 ft. dist., mkd. X BT.

A spruce, 17 ins. diam., bears N. 58° W., 20.8 ft., dist., mkd. X BT.

Place a blue DEEP-I magnet at the base of the alum. post and an orange Carsonite witness post 1 ft. North of the corner.

40 Set an alum. post, 30 ins. long, 2 1/2 ins. diam., 26 ins. in the ground, with alum. cap mkd. as shown.

From which

A spruce, 7 ins. diam., bears N. 75 3/4° E., 44.4 ft. dist., mkd. X BT.

A spruce, 20 ins. diam., bears S. 24 1/2° W., 33.0 ft. dist., mkd. X BT.

A birch, 6 ins. diam., bears N. 60 1/2° W., 30.7 ft., dist., mkd. X BT.

Place a blue DEEP-I magnet at the base of the alum. post and an orange Carsonite witness post 1 ft. North of the corner.

41 Set an alum. post, 30 ins. long, 2 1/2 ins. diam., 26 ins. in the ground, with alum. cap mkd. as shown.

From which

A spruce, 14 ins. diam., bears N. 17° E., 101.9 ft. dist., mkd. X BT.

A spruce, 22 ins. diam., bears S. 28 1/2° W., 83.7 ft. dist., mkd. X BT.

A spruce, 20 ins. diam., bears N. 65° W., 21.4 ft., dist., mkd. X BT.

Place a blue DEEP-I magnet at the base of the alum. post and an orange Carsonite witness post 1 ft. North of the corner.

42 Set an alum. post, 30 ins. long, 2 1/2 ins. diam., 26 ins. in the ground, with alum. cap mkd. as shown.

From which

A spruce, 10 ins. diam., bears N. 9 1/2° E., 64.0 ft. dist., mkd. X BT.

A spruce, 9 ins. diam., bears S. 33° E., 56.5 ft. dist., mkd. X BT.

A spruce, 10 ins. diam., bears S. 75 1/2° W., 36.5 ft., dist., mkd. X BT.

Place a blue DEEP-I magnet at the base of the alum. post and an orange Carsonite witness post 1 ft. North of the corner.

43 Set an alum. post, 30 ins. long, 2 1/2 ins. diam., 26 ins. in the ground, with alum. cap mkd. as shown.

From which

A birch, 13 ins. diam., bears N. 24° E., 52.8 ft. dist., mkd. X BT.

A spruce, 5 ins. diam., bears S. 72 1/4° E., 119.9 ft. dist., mkd. X BT.

A birch, 9 ins. diam., bears N. 47° W., 32.0 ft., dist., mkd. X BT.

Place a blue DEEP-I magnet at the base of the alum. post and an orange Carsonite witness post 1 ft. North of the corner.

APPLICANT CERTIFICATE

I, THE UNDERSIGNED, HEREBY CERTIFY THAT I AM THE APPLICANT OF TRACT H, ASLS 2005-27, ADL 229193 AS SHOWN HEREON. I HEREBY APPROVE THIS SURVEY AND PLAT.

DATE: 4/30/08
 Carl L. Dixon
 CARL L. DIXON
 2626 GALEWOOD ST.
 ANCHORAGE, ALASKA 99508

NOTARY'S ACKNOWLEDGEMENT
 SUBSCRIBED AND SWORN TO BEFORE ME
 THIS 30 DAY OF APRIL, 2008
 BY Joseph L. Dixon
 Joseph L. Dixon
 NOTARY FOR THE STATE OF ALASKA
 MY COMMISSION EXPIRES WITH OFFICE

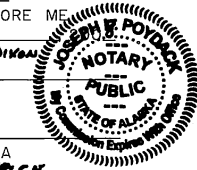

APPLICANT CERTIFICATE

I, THE UNDERSIGNED, HEREBY CERTIFY THAT I AM THE APPLICANT OF TRACT I, ASLS 2005-27, ADL 229194 AS SHOWN HEREON. I HEREBY APPROVE THIS SURVEY AND PLAT.

DATE: 5/5/2008
 Kirsten Dixon
 KIRSTEN DIXON
 2626 GALEWOOD ST.
 ANCHORAGE, ALASKA 99508

NOTARY'S ACKNOWLEDGEMENT
 SUBSCRIBED AND SWORN TO BEFORE ME
 THIS 5th DAY OF May, 2008
 BY Kirsten Dixon
 Kirsten Dixon
 NOTARY FOR THE STATE OF ALASKA
 MY COMMISSION EXPIRES WITH OFFICE

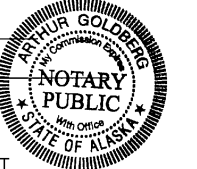

NOTE: THERE IS NO APPLICANT FOR TRACT J (ADL 229544)

APPLICANT CERTIFICATE

I, THE UNDERSIGNED, HEREBY CERTIFY THAT I AM THE APPLICANT OF TRACT K, ASLS 2005-27, ADL 229251 AS SHOWN HEREON. I HEREBY APPROVE THIS SURVEY AND PLAT.

DATE: 4/9/08
 Kristen Dixon
 HEATH FORBES
 2626 GALEWOOD ST.
 ANCHORAGE, ALASKA 99508

NOTARY'S ACKNOWLEDGEMENT
 SUBSCRIBED AND SWORN TO BEFORE ME
 THIS 9 DAY OF June, 2008
 BY Kristen Dixon
 Kristen Dixon
 NOTARY FOR THE STATE OF ALASKA
 MY COMMISSION EXPIRES WITH OFFICE

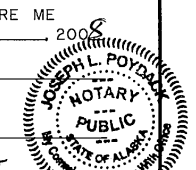

APPLICANT CERTIFICATE

I, THE UNDERSIGNED, HEREBY CERTIFY THAT I AM THE APPLICANT OF TRACT L, ASLS 2005-27, ADL 229195 AS SHOWN HEREON. I HEREBY APPROVE THIS SURVEY AND PLAT.

DATE: 5/5/2008
 Amanda Dixon
 AMANDA DIXON
 2626 GALEWOOD ST.
 ANCHORAGE, ALASKA 99508

NOTARY'S ACKNOWLEDGEMENT
 SUBSCRIBED AND SWORN TO BEFORE ME
 THIS 5th DAY OF May, 2008
 BY Amanda Dixon
 Amanda Dixon
 NOTARY FOR THE STATE OF ALASKA
 MY COMMISSION EXPIRES WITH OFFICE

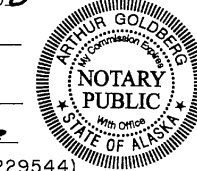

APPLICANT CERTIFICATE

I, THE UNDERSIGNED, HEREBY CERTIFY THAT I AM THE APPLICANT OF TRACT M, ASLS 2005-27, ADL 229250 AS SHOWN HEREON. I HEREBY APPROVE THIS SURVEY AND PLAT.

DATE: 5/13/08
 James O. Schmidt
 JAMES O. SCHMIDT
 2626 GALEWOOD ST.
 ANCHORAGE, ALASKA 99508

NOTARY'S ACKNOWLEDGEMENT
 SUBSCRIBED AND SWORN TO BEFORE ME
 THIS 13 DAY OF MAY, 2008
 BY Kirsten Dixon
 Kirsten Dixon
 NOTARY FOR THE STATE OF ALASKA
 MY COMMISSION EXPIRES WITH OFFICE



1 Meter = 3.280833 U.S. Survey Feet 1 U.S. acre = 0.4047 hectare

DATE OF SURVEY: BEGINNING: 10/07/2006 ENDING: 10/14/2006	NAME OF SURVEYOR: The Crazy Mountains JV 2000 E. Dowling Road, #6 Anchorage, AK 99507
STATE OF ALASKA DEPARTMENT OF NATURAL RESOURCES DIVISION OF MINING LAND AND WATER Anchorage, Alaska	
ALASKA STATE LAND SURVEY NO. 2005-27 PORCUPINE BUTTE WEST REMOTE RECREATIONAL CABIN SITES CREATING TRACTS A - P WITHIN UNSURVEYED SECTIONS 31 and 32, T. 22 N., R. 15 W., SECTIONS 1, 2, & 3, T. 21 N., R. 16 W., and SECTION 34, T. 22 N., R. 16 W., all of the SEWARD MERIDIAN, ALASKA ANCHORAGE RECORDING DISTRICT Containing 290.66 Acres	
DRAWN BY: JEM	APPROVAL RECOMMENDED
DATE: 1/7/2008	FOR William S. Brown 7-29-08 STATEWIDE PLATTING SUPERVISOR DATE
SCALE: 1" = 200'	CHECKED BY: KJL File No. ASLS 20050027

Anchorage Recording District Plat 2005-114

SEE SHEET 10 FOR MONUMENT DESCRIPTIONS
AND APPLICANTS' CERTIFICATES

STATE OF ALASKA
Unsubdivided

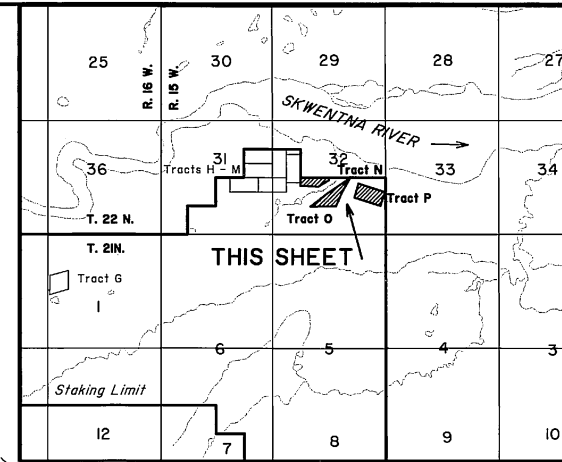

Tract M
See Sheet 7

STATE OF ALASKA
Unsubdivided

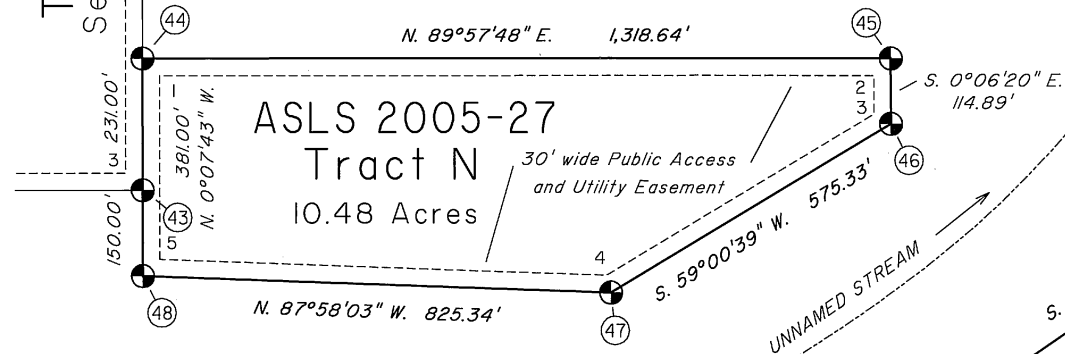

STATE OF ALASKA
Unsubdivided

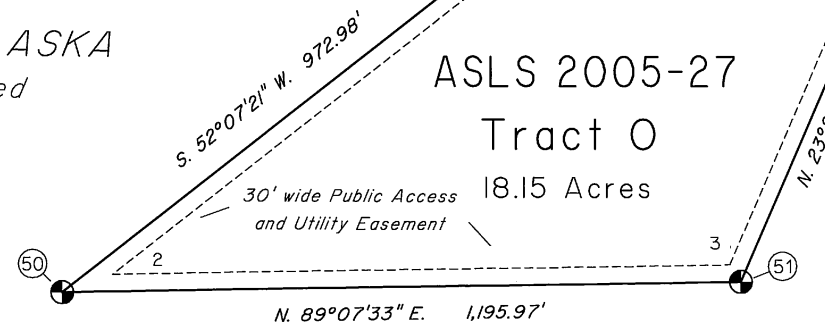

STATE OF ALASKA
Unsubdivided

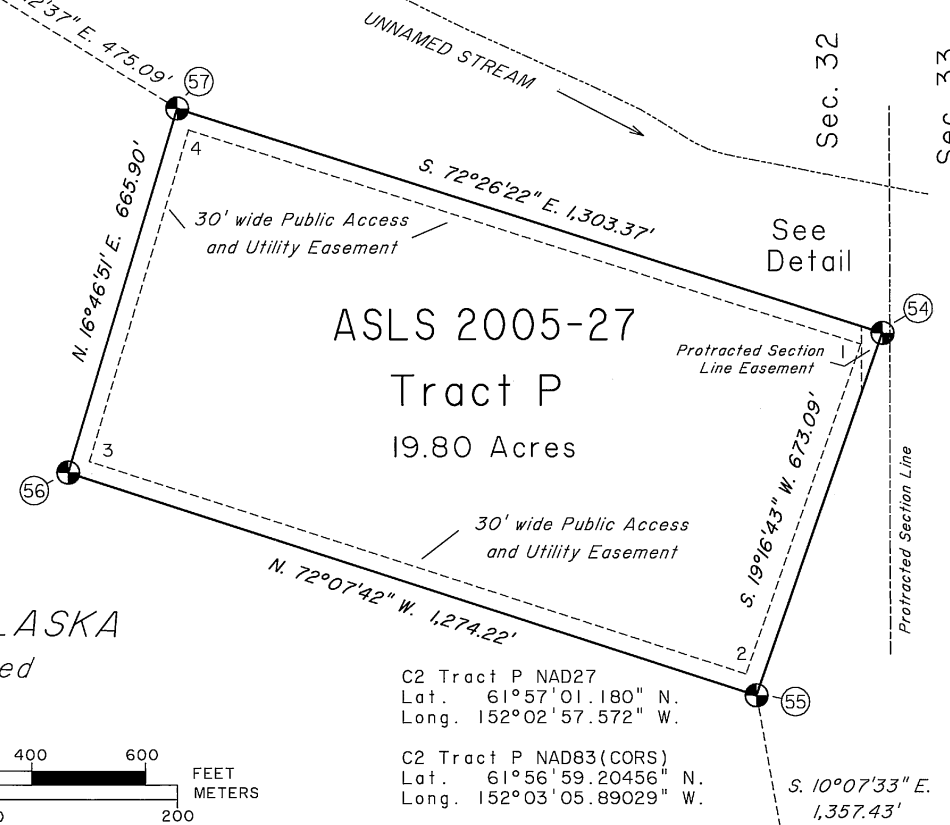

C2 Tract P NAD27
Lat. 61°57'01.180" N.
Long. 152°02'57.572" W.

C2 Tract P NAD83(CORS)
Lat. 61°56'59.20456" N.
Long. 152°03'05.89029" W.

S. 10°07'33" E. 1,357.43'

BLM Record NAD27 Position
Lat. 61°56'48.023" N.
Long. 152°02'52.583" W.
Computed using BLM plot of
T. 22 N., R. 15 W., Seward Meridian,
Alaska filed June 17, 1996

1 Meter = 3.280833 U.S. Survey Feet | U.S. acre = 0.4047 hectare

DATE OF SURVEY: BEGINNING: 10/07/2006 ENDING: 10/14/2006	NAME OF SURVEYOR: The Crazy Mountains JV 2000 E. Dowling Road, #6 Anchorage, AK 99507
--	--

STATE OF ALASKA
DEPARTMENT OF NATURAL RESOURCES
DIVISION OF MINING LAND AND WATER
Anchorage, Alaska

ALASKA STATE LAND SURVEY NO. 2005-27
PORCUPINE BUTTE WEST REMOTE RECREATIONAL CABIN SITES
CREATING TRACTS A - P
WITHIN UNSURVEYED SECTIONS 31 and 32, T. 22 N., R. 15 W., SECTIONS 1, 2, & 3,
T. 21 N., R. 16 W., and SECTION 34, T. 22 N., R. 16 W., all of the SEWARD MERIDIAN, ALASKA
ANCHORAGE RECORDING DISTRICT
Containing 290.66 Acres

DRAWN BY: JEM	APPROVAL RECOMMENDED
DATE: 1/7/2008	<i>William S. Brown</i> 7-29-08
SCALE: 1" = 200'	CHECKED BY: KJL STATEWIDE PLATTING SUPERVISOR FILE NO. ASLS 20050027

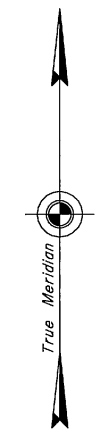
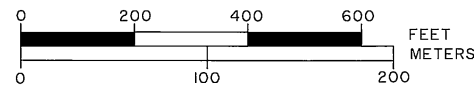

2006 Mean
Magnetic
Declination
19 3/4° E.
See Note H

LEGEND

- ⊗ BLM/GLO Monument Recovered
- ⊙ Primary monument set this survey
- ⊙ Corner Designation
- Surveyed Line
- - - Unsurveyed Line
- (m) Measured this survey
- (r) Record Per BLM
- - - Protracted Section Line

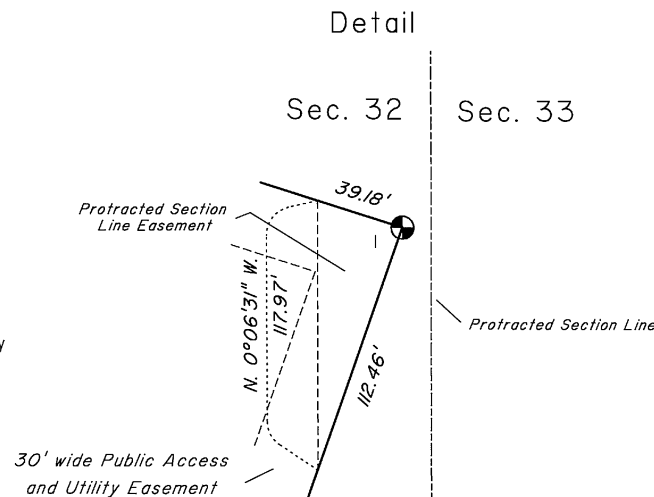

SCALE: 1" = 50'

Anchorage Recording District Plat 2008-114

SHEET 9 of 10

44 Set an alum. post, 30 ins. long, 2 1/2 ins. diam., 26 ins. in the ground, with alum. cap mkd. as shown.

From which

ASLS 2005-27
TR M
CI
TR N
RLS 7045
2006

A birch, 12 ins. diam., bears N. 55 1/2° E., 44.9 ft. dist., mkd. X BT.

A spruce, 8 ins. diam., bears S. 20 1/2° E., 84.7 ft. dist., mkd. X BT.

A birch, 10 ins. diam., bears S. 88° W., 14.2 ft. dist., mkd. X BT.

Place a blue DEEP-1 magnet at the base of the alum. post and an orange Carsonite witness post 1 ft. North of the corner.

45 Set an alum. post, 30 ins. long, 2 1/2 ins. diam., 26 ins. in the ground, with alum. cap mkd. as shown.

From which

ASLS 2005-27
C2
TR N
RLS 7045
2006

A spruce, 9 ins. diam., bears S. 24° W., 31.9 ft. dist., mkd. X BT.

A spruce, 11 ins. diam., bears S. 85° W., 44.8 ft. dist., mkd. X BT.

A spruce, 10 ins. diam., bears N. 36 1/2° W., 46.4 ft., dist., mkd. X BT.

Place a blue DEEP-1 magnet at the base of the alum. post and an orange Carsonite witness post 1 ft. North of the corner.

46 Set an alum. post, 30 ins. long, 2 1/2 ins. diam., 26 ins. in the ground, with alum. cap mkd. as shown.

From which

ASLS 2005-27
TR N
C3
RLS 7045
2006

A spruce, 8 ins. diam., bears S. 18 1/2° E., 64.1 ft. dist., mkd. X BT.

A spruce, 10 ins. diam., bears S. 53° W., 39.9 ft. dist., mkd. X BT.

A spruce, 12 ins. diam., bears N. 31° W., 15.9 ft., dist., mkd. X BT.

Place a blue DEEP-1 magnet at the base of the alum. post and an orange Carsonite witness post 1 ft. North of the corner.

47 Set an alum. post, 30 ins. long, 2 1/2 ins. diam., 26 ins. in the ground, with alum. cap mkd. as shown.

From which

ASLS 2005-27
TR N
C4
RLS 7045
2006

A spruce, 13 ins. diam., bears N. 60° E., 59.2 ft. dist., mkd. X BT.

A spruce, 13 ins. diam., bears S. 3° W., 47.1 ft. dist., mkd. X BT.

A spruce, 11 ins. diam., bears S. 54 1/2° W., 21.7 ft., dist., mkd. X BT.

Place a blue DEEP-1 magnet at the base of the alum. post and an orange Carsonite witness post 1 ft. North of the corner.

48 Set an alum. post, 30 ins. long, 2 1/2 ins. diam., 26 ins. in the ground, with alum. cap mkd. as shown.

From which

ASLS 2005-27
TR N
C5
RLS 7045
2006

A spruce, 11 ins. diam., bears S. 33 1/2° E., 68.8 ft. dist., mkd. X BT.

A birch, 18 ins. diam., bears S. 39° W., 51.6 ft. dist., mkd. X BT.

A birch, 21 ins. diam., bears N. 42° W., 42.4 ft., dist., mkd. X BT.

Place a blue DEEP-1 magnet at the base of the alum. post and an orange Carsonite witness post 0.6 ft. North of the corner.

49 Set an alum. post, 30 ins. long, 2 1/2 ins. diam., 26 ins. in the ground, with alum. cap mkd. as shown.

From which

ASLS 2005-27
CI
TR O
RLS 7045
2006

A spruce, 16 ins. diam., bears N. 86° E., 38.5 ft. dist., mkd. X BT.

A spruce, 15 ins. diam., bears S. 14° W., 33.0 ft. dist., mkd. X BT.

A spruce, 12 ins. diam., bears N. 63 1/2° W., 39.2 ft., dist., mkd. X BT.

Place a blue DEEP-1 magnet at the base of the alum. post and an orange Carsonite witness post 1 ft. North of the corner.

50 Set an alum. post, 30 ins. long, 2 1/2 ins. diam., 26 ins. in the ground, with alum. cap mkd. as shown.

From which

ASLS 2005-27
TR O
C2
TR J
RLS 7045
2006

A spruce, 8 ins. diam., bears N. 27° E., 24.8 ft. dist., mkd. X BT.

A spruce, 14 ins. diam., bears N. 76° W., 24.5 ft. dist., mkd. X BT.

A spruce, 12 ins. diam., bears N. 11° W., 44.6 ft., dist., mkd. X BT.

Place a blue DEEP-1 magnet at the base of the alum. post and an orange Carsonite witness post 1 ft. North of the corner.

51 Set an alum. post, 30 ins. long, 2 1/2 ins. diam., 26 ins. in the ground, with alum. cap mkd. as shown.

From which

ASLS 2005-27
TR O
C3
RLS 7045
2006

A spruce, 12 ins. diam., bears S. 37° E., 69.7 ft. dist., mkd. X BT.

A spruce, 12 ins. diam., bears S. 26° W., 35.4 ft. dist., mkd. X BT.

A spruce, 16 ins. diam., bears N. 27 1/2° W., 41.8 ft., dist., mkd. X BT.

Place a blue DEEP-1 magnet at the base of the alum. post and an orange Carsonite witness post 1 ft. North of the corner.

52 Set an alum. post, 30 ins. long, 2 1/2 ins. diam., 26 ins. in the ground, with alum. cap mkd. as shown.

From which

ASLS 2005-27
TR O
C4
RLS 7045
2006

A birch, 10 ins. diam., bears S. 15° W., 27.9 ft. dist., mkd. X BT.

A spruce, 15 ins. diam., bears S. 79 1/2° W., 27.3 ft. dist., mkd. X BT.

A birch, 16 ins. diam., bears N. 1° W., 16.8 ft., dist., mkd. X BT.

Place a blue DEEP-1 magnet at the base of the alum. post and an orange Carsonite witness post 1 ft. North of the corner.

53 Set an alum. post, 30 ins. long, 2 1/2 ins. diam., 26 ins. in the ground, with alum. cap mkd. as shown.

From which

ASLS 2005-27
C5
TR O
RLS 7045
2006

A spruce, 18 ins. diam., bears N. 65° E., 59.0 ft. dist., mkd. X BT.

A spruce, 20 ins. diam., bears S. 49° E., 30.6 ft. dist., mkd. X BT.

A spruce, 20 ins. diam., bears S. 15° W., 40.1 ft., dist., mkd. X BT.

Place a blue DEEP-1 magnet at the base of the alum. post and an orange Carsonite witness post 1 ft. North of the corner.

54 Set an alum. post, 30 ins. long, 2 1/2 ins. diam., 26 ins. in the ground, with alum. cap mkd. as shown.

From which

ASLS 2005-27
CI
TR P
RLS 7045
2006

A spruce, 6 ins. diam., bears N. 37° E., 68.1 ft. dist., mkd. X BT.

A spruce, 18 ins. diam., bears S. 20° W., 106.5 ft. dist., mkd. X BT.

A spruce, 10 ins. diam., bears N. 77 1/2° W., 35.6 ft., dist., mkd. X BT.

Place a blue DEEP-1 magnet at the base of the alum. post and an orange Carsonite witness post 1 ft. North of the corner.

55 Set an alum. post, 30 ins. long, 2 1/2 ins. diam., 26 ins. in the ground, with alum. cap mkd. as shown.

From which

ASLS 2005-27
TR P
C2
RLS 7045
2006

A spruce, 24 ins. diam., bears N. 70 1/2° E., 45.6 ft. dist., mkd. X BT.

A spruce, 16 ins. diam., bears S. 1° W., 57.7 ft. dist., mkd. X BT.

A spruce, 16 ins. diam., bears N. 42° W., 20.8 ft., dist., mkd. X BT.

Place a blue DEEP-1 magnet at the base of the alum. post and an orange Carsonite witness post 1 ft. North of the corner.

56 Set an alum. post, 30 ins. long, 2 1/2 ins. diam., 26 ins. in the ground, with alum. cap mkd. as shown.

From which

ASLS 2005-27
TR P
C3
RLS 7045
2006

A spruce, 18 ins. diam., bears N. 74° E., 52.3 ft. dist., mkd. X BT.

A spruce, 6 ins. diam., bears S. 11° W., 45.1 ft. dist., mkd. X BT.

A spruce, 20 ins. diam., bears N. 40° W., 34.1 ft., dist., mkd. X BT.

Place a blue DEEP-1 magnet at the base of the alum. post and an orange Carsonite witness post 1 ft. North of the corner.

57 Set an alum. post, 30 ins. long, 2 1/2 ins. diam., 26 ins. in the ground, with alum. cap mkd. as shown.

From which

ASLS 2005-27
C4
TR P
RLS 7045
2006

A spruce, 14 ins. diam., bears S. 32 1/2° E., 33.6 ft. dist., mkd. X BT.

A spruce, 12 ins. diam., bears S. 63° W., 52.75 ft. dist., mkd. X BT.

A spruce, 8 ins. diam., bears N. 1° W., 15.85 ft., dist., mkd. X BT.

Place a blue DEEP-1 magnet at the base of the alum. post and an orange Carsonite witness post 1 ft. North of the corner.

58 Recovered an iron post, 2 1/2 ins. diam., firmly set, projecting 2 ins. above the ground, with brass cap mkd. as shown

from which existing bearing trees

ASLS 2005-27
T 22 N
R 16 W R 15 W
S 36 S 31
S 1 S 6
T 21 N
1989

A spruce 8 ins. diam., bears N. 65° E., 35.3 ft. dist., with scribe marks T22N R15W S31 BT visible on an open blaze.

A spruce 6 ins. diam., bears S. 55° E., 43.3 ft. dist., with scribe marks X BT visible on an open double blaze.

A spruce 12 ins. diam., bears S. 68° W., 57.0 ft. dist., with scribe marks T2 visible on a partially healed blaze.

A spruce 10 ins. diam., bears N. 18° W., 41.4 ft. dist., with healed blaze.

59 Recovered an iron post, 2 1/2 ins. diam., firmly set, projecting 1 ins. above the ground, with brass cap mkd. as shown

from which existing bearing trees

ASLS 2005-27
T 22 N R 15 W
S 32 S 33
S 5 S 4
T 21 N
1989

A spruce 8 ins. diam., bears N. 22° E., 39.5 ft. dist., with scribe marks T22N R15W S33 BT visible on an open blaze.

A spruce 6 ins. diam., bears S. 53° E., 23.6 ft. dist., with scribe marks T2IN R15W S4 BT visible on an open blaze.

A spruce 8 ins. diam., bears S. 57° W., 34.1 ft. dist., with healed blaze.

A spruce 10 ins. diam., bears N. 42° W., 23.2 ft. dist., with healed blaze.

2008-114
Anchorage REC DIST
Date 11-4-2008
Time 8:47 A.M.
Requested By DNR
Address

APPLICANT CERTIFICATE

I, THE UNDERSIGNED, HEREBY CERTIFY THAT I AM THE APPLICANT OF TRACT O, ASLS 2005-27, ADL 229258 AS SHOWN HEREON. I HEREBY APPROVE THIS SURVEY AND PLAT.

DATE: 6-2-08

Staci D. Griffin
STACI D. GRIFFIN
833 W. 20th Ave. Unit A
ANCHORAGE, ALASKA 99503

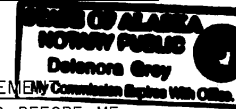

NOTARY'S ACKNOWLEDGEMENT

SUBSCRIBED AND SWORN TO BEFORE ME THIS 2nd DAY OF June, 2008

BY: Staci Griffin

Deb Cy
NOTARY FOR THE STATE OF ALASKA
MY COMMISSION EXPIRES: w/o office

APPLICANT CERTIFICATE

I, THE UNDERSIGNED, HEREBY CERTIFY THAT I AM THE APPLICANT OF TRACT P, ASLS 2005-27, ADL 229201 AS SHOWN HEREON. I HEREBY APPROVE THIS SURVEY AND PLAT.

DATE: 5/27/2008

Gregory J. Waisanen
GREGORY J. WAISANEN
P.O. Box 87-3603
WASILLA, ALASKA 99687

NOTARY'S ACKNOWLEDGEMENT

SUBSCRIBED AND SWORN TO BEFORE ME THIS 27th DAY OF May, 2008

BY: Gregory J. Waisanen

Arthur Goldberg
NOTARY FOR THE STATE OF ALASKA
MY COMMISSION EXPIRES: w/o office

NOTE: THERE IS NO APPLICANT FOR TRACT N (ADL 229545)



1 Meter = 3.280833 U.S. Survey Feet | U.S. acre = 0.4047 hectare

DATE OF SURVEY: BEGINNING: 10/07/2006 ENDING: 10/14/2006	NAME OF SURVEYOR: The Crazy Mountains JV 2000 E. Dowling Road, #6 Anchorage, AK 99507
STATE OF ALASKA DEPARTMENT OF NATURAL RESOURCES DIVISION OF MINING LAND AND WATER Anchorage, Alaska	
ALASKA STATE LAND SURVEY NO. 2005-27 PORCUPINE BUTTE WEST REMOTE RECREATIONAL CABIN SITES CREATING TRACTS A - P WITHIN UNSURVEYED SECTIONS 31 and 32, T. 22 N., R. 15 W., SECTIONS 1, 2, & 3, T. 21 N., R. 16 W., and SECTION 34, T. 22 N., R. 16 W., all of the SEWARD MERIDIAN, ALASKA ANCHORAGE RECORDING DISTRICT Containing 290.66 Acres	
DRAWN BY: JEM DATE: 1/7/2008	APPROVAL RECOMMENDED William S. Brown 7-29-08 STATEWIDE PLATTING SUPERVISOR DATE
SCALE: 1" = 200'	CHECKED BY: KJL File No. ASLS 20050027