

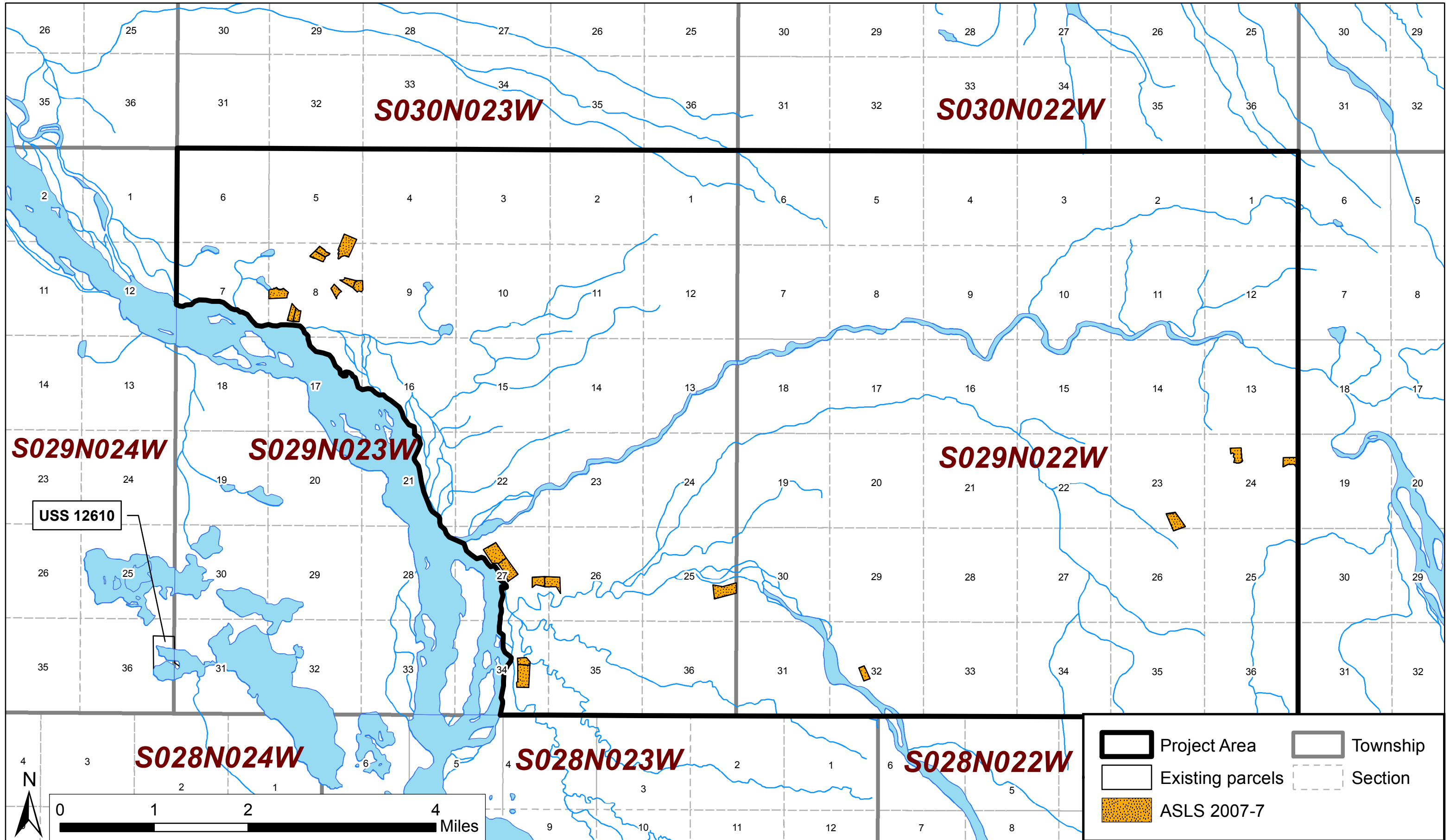

# Survey Key: Dillinger River II RRCS

Remote Recreational Cabin Sites Staking Area # 1114203



## DILLINGER RIVER II STAKING MAP SURVEYS

The links below are for existing surveys in the Dillinger River II staking area vicinity available online from Alaska Land Records. You will need Adobe Acrobat or a similar PDF viewer to view the plats.

Township 29 North, Range 22 West, Seward Meridian

*US Rectangular Survey (USRS)*

[http://dnr.alaska.gov/mlw/landsale/remrec/surveys/TWP\\_S029N022W.pdf](http://dnr.alaska.gov/mlw/landsale/remrec/surveys/TWP_S029N022W.pdf)

*ASLS 2007-7*

<http://dnr.alaska.gov/mlw/landsale/remrec/surveys/asls2007-7.pdf>

Township 29 North, Range 23 West, Seward Meridian

*USRS*

[http://dnr.alaska.gov/mlw/landsale/remrec/surveys/TWP\\_S029N023W.pdf](http://dnr.alaska.gov/mlw/landsale/remrec/surveys/TWP_S029N023W.pdf)

*Alaska State Land Survey (ASLS) 2007-7*

<http://dnr.alaska.gov/mlw/landsale/remrec/surveys/asls2007-7.pdf>

Township 29 North, Range 24 West, Seward Meridian

*United States Survey (USS) 12610*

[http://dnr.alaska.gov/mlw/landsale/remrec/surveys/USS\\_12610.pdf](http://dnr.alaska.gov/mlw/landsale/remrec/surveys/USS_12610.pdf)