

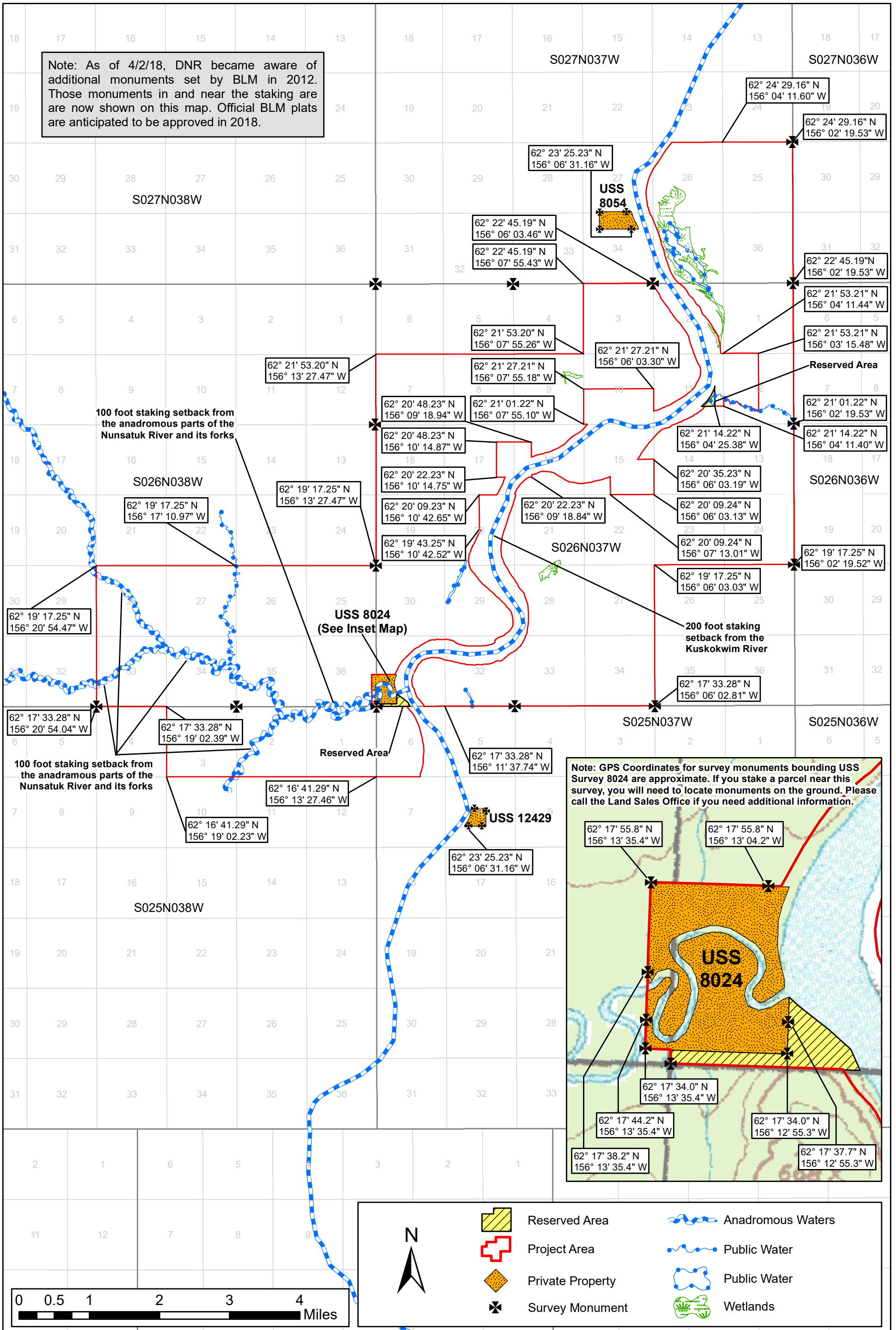

# BOUNDARY COORDINATE DIAGRAM: GRANITE MOUNTAIN

REMOTE RECREATIONAL CABIN SITES STAKING AREA 1117202

Note: As of 4/2/18, DNR became aware of additional monuments set by BLM in 2012. Those monuments in and near the staking area are now shown on this map. Official BLM plats are anticipated to be approved in 2018.



Note: GPS Coordinates for survey monuments bounding USS Survey 8024 are approximate. If you stake a parcel near this survey, you will need to locate monuments on the ground. Please call the Land Sales Office if you need additional information.

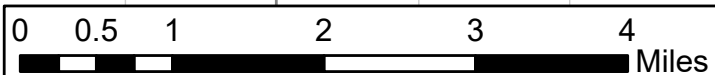
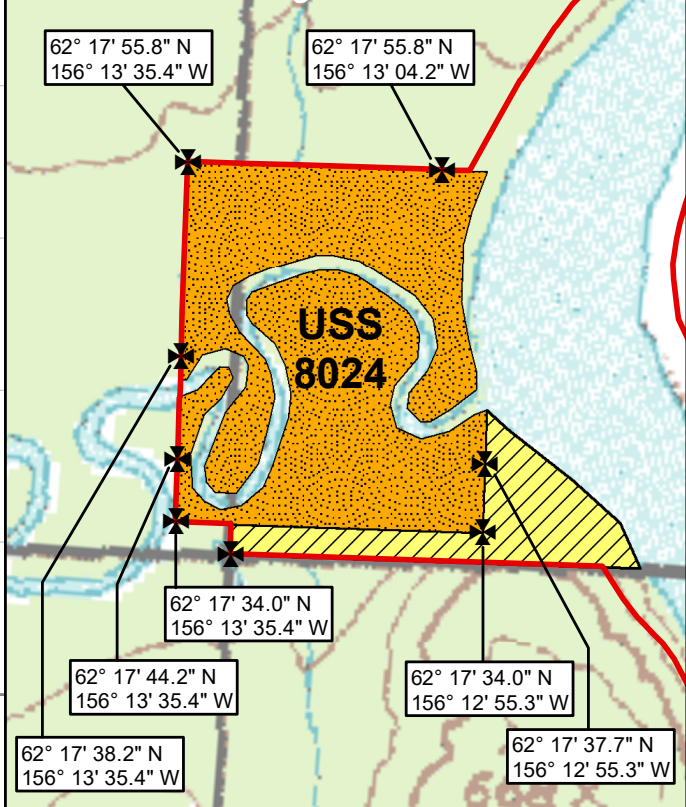

- Reserved Area
- Project Area
- Private Property
- Survey Monument
- Anadromous Waters
- Public Water
- Public Water
- Wetlands