

MANAGEMENT UNIT 3: North of Tazlina River

Background

This management unit includes state land between the Glenn Highway and Tazlina Lake and Tazlina River and state land north of the Glenn Highway near Tolsona Lake and Tolsona Creek. Most of the unit is state owned, except for scattered parcels of private land along the Glenn Highway. Most of the state land in this unit is quite boggy. The U.S. Air Force is currently evaluating parts of subunits 3C, 3E, and 3F as a possible site for an Over-the-Horizon Backscatter (OTH-B) Radar System.

Management Intent

Most state land in this unit will be retained in public ownership and managed for multiple use, with emphasis on forestry and wildlife habitat. Isolated parcels (approximately 250 acres) of land along the highway (subunit 3D) may be offered for settlement. Land within this management unit may be used for the USAF Backscatter radar system. Most of the unit will remain open to mineral entry, except for Tolsona Creek and Mendeltna Creek which will be closed to mineral location to protect salmon spawning areas, resident fish populations, water quality, and recreation resources. The existing Tolsona Creek recreation site (subunit 3E) is also closed to mineral location. Tolsona and Moose Lakes will be managed as general development lakes (see p. 2-42).

In addition to the overall management intent described above, the following applies to specific subunits:

Subunit 3B. This subunit, which includes the Mendeltna Creek corridor, should be retained in public ownership and managed to protect salmon populations, recreation values, and any archaeological resources. The stream offers good fishing and floating, although log jams and sweepers are potential hazards. An archaeological review should be conducted before any timber sales in this subunit.

Subunit 3F. The salt springs and mud volcano north of the Glenn Highway should be retained and managed for scientific values. This is the most accessible mud volcano in the Copper River Basin and can be reached easily from a hiking trail located at mile 178 of the Glenn Highway. The trailhead should be marked by DNR.

Management Guidelines

Trails. The Resource Information Summary lists several trails, all of which should be retained for public use if adjacent lands are offered for sale. The trailheads should also be marked, especially the ones adjacent to or near private property to prevent trespass problems.

Gravel Pits. Existing gravel pits and areas identified on the management units map as having high potential for material extraction will be retained in public ownership.

Mineral Closures. Land within 200 feet of Tolsona and Mendeltna Creeks, and the creeks themselves will be closed to mineral location to protect valuable fisheries and recreation resources. Mendeltna Creek also has potential archaeological resources.

The complete set of management guidelines is presented in Chapter 2. Any of the guidelines could apply to uses within this management unit; however, guidelines that are most likely to apply are:

- Fish and wildlife habitat
- Forestry
- Recreation, cultural, and scenic resources
- Settlement
- Stream corridors and instream flow
- Trail management
- Wetlands management

LAND USE DESIGNATION SUMMARY
MANAGEMENT UNIT: 3 - North of Tazlina River
(Page 1 of 2)

SUBUNIT	LAND OWNERSHIP (GENERALIZED)	LAND USE DESIGNATIONS				PROHIBITED SURFACE USE(S)*	COMMENTS
		SURFACE		SUBSURFACE			
		PRIMARY USE(S)	SECONDARY USE(S)	LOCATABLE MINERALS	LEASEABLE MINERALS		
3A	State	Forestry Wildlife habitat	Sand and gravel	Open to mineral entry	Available for leasing	Land offerings Remote cabins Trapping cabins	
3B	State	Forestry Public recreation Wildlife habitat	Heritage resources	Uplands open to mineral entry, Mendeltna Creek closed to mineral entry	Available for leasing	Land offerings Remote cabins Trapping cabins	Includes Mendeltna Creek below Glenn Highway
3C	State	Forestry Wildlife habitat	Public recreation	Open to mineral entry, except Tolsona Creek	Available for leasing	Land offerings Remote cabins	
3D	State, some private	Settlement	Forestry Sand and gravel Wildlife habitat	Open, except disposal area closed before offering	Available for leasing	Remote cabins Trapping cabins	Estimated net land offerings - 250 acres

* Other uses such as material sales, land leases, or permits, that are not specifically prohibited may be allowed. Such uses will be allowed if consistent with the management intent statement, the management guidelines of this unit, and the relevant management guidelines listed in Chapter 2.

3-21

ACE 6329430

LAND USE DESIGNATION SUMMARY
MANAGEMENT UNIT: 3 - North of Tazlina River
(Page 2 of 2)

SUBUNIT	LAND OWNERSHIP (GENERALIZED)	LAND USE DESIGNATIONS				PROHIBITED SURFACE USE(S)*	COMMENTS
		SURFACE		SUBSURFACE			
		PRIMARY USE(S)	SECONDARY USE(S)	LOCATABLE MINERALS	LEASEABLE MINERALS		
3E	State	Recreation site	Wildlife habitat	Closed to mineral entry	Available for leasing	Land offerings Remote cabins Trapping cabins	Tolsona Creek recreation site (existing)
3F	State	Geothermal Public recreation Wildlife habitat		Open to mineral entry	Available for leasing	Land offerings Remote cabins Trapping cabins	Tolsona mud volcanoes

* Other uses such as material sales, land leases, or permits, that are not specifically prohibited may be allowed. Such uses will be allowed if consistent with the management intent statement, the management guidelines of this unit, and the relevant management guidelines listed in Chapter 2.

3-22

ACE 6329431

RESOURCE INFORMATION SUMMARY

Management Unit 3 - North of Tazlina River (page 1 of 2)

RESOURCE	SUBUNIT			
	3A	3B	3C	3D
Fish	none docum.	salmon - s	salmon - s/r steelhead - s	salmon s/r
Forestry	moderate conif.	high and moderate conif.	high and moderate conif.	moderate conif. and decid.
Historic-Cultural	none ident.	Sites - along Mendeltna Creek	none ident.	none ident.
Minerals	outside of known mineral terraces	outside of known mineral terraces	outside of known mineral terraces	outside of known mineral terraces
Oil and Gas	low	low	low	low
Recreation	low	high; floating and fishing	moderate to small lakes; high - Tolsona, Moose Lakes	low
Sand and Gravel	none ident.	none ident.	existing sites	existing sites
Settlement Suitability	low	unsuitable	low	low
Transportation	Glenn Hwy.	Glenn Hwy.	Glenn Hwy.; Smoky Lakes & Trapper's Den airstrips	Glenn Hwy.
Wildlife	B-1 habitat	B-1 habitat	A-2 habitat - caribou, moose; B-1 habitat	A-2 habitat caribou, moose

Important Trails: (Note: Some trails cross private land, inquire before using.)

Subunit 3C: Trail from Tolsona Lake on Glenn Hwy. north to Crosswind Lake (primary winter access to lake)

Trail from Glenn Hwy. near Bob Lake north to Twin Lakes

Trail from Glenn Hwy. west of Mud Lake to Crosswind Lake

Trail from Glenn Hwy., 4 mi east of Atlasta House, south to Tazlina River

Trail paralleling Tazlina River on the north

Trail from Trapper's Den on Glenn Hwy. south to Sucker Lake

Trail from Glenn Hwy., about 1 mile east of Mendeltna Lodge, south to Mendeltna Creek

Subunit 3D: Trail from Glenn Hwy., 4 miles east of Atlasta House, north to Tolsona Creek

For definitions of ratings, see glossary. For more detailed information on any resources, see resource elements published under separate cover.

RESOURCE INFORMATION SUMMARY

Management Unit 3 - North of Tazlina River (page 2 of 2)

RESOURCE	SUBUNIT	
	3E	3F
Fish	salmon - s	N/A
Forestry	moderate conif. and decid.	moderate conif.
Historic-Cultural	none ident.	high salt springs
Minerals	outside of known mineral terranes	outside of known mineral terranes
Oil and Gas	low	low
Recreation	existing state rec. site - Tolsona Creek none ident.	high - scientific values
Sand and Gravel	none ident.	none ident.
Settlement Suitability	low	unsuitable
Transportation	Glenn Hwy.	Glenn Hwy., trail to springs
Wildlife	B-1 habitat	B-1 habitat

Notes: Salt springs and mud volcano are located in subunit 3F north of Glenn Hwy.

For definitions of ratings, see glossary. For more detailed information on any resources, see resource elements published under separate cover.

MANAGEMENT UNIT 3

North of Tazlina River

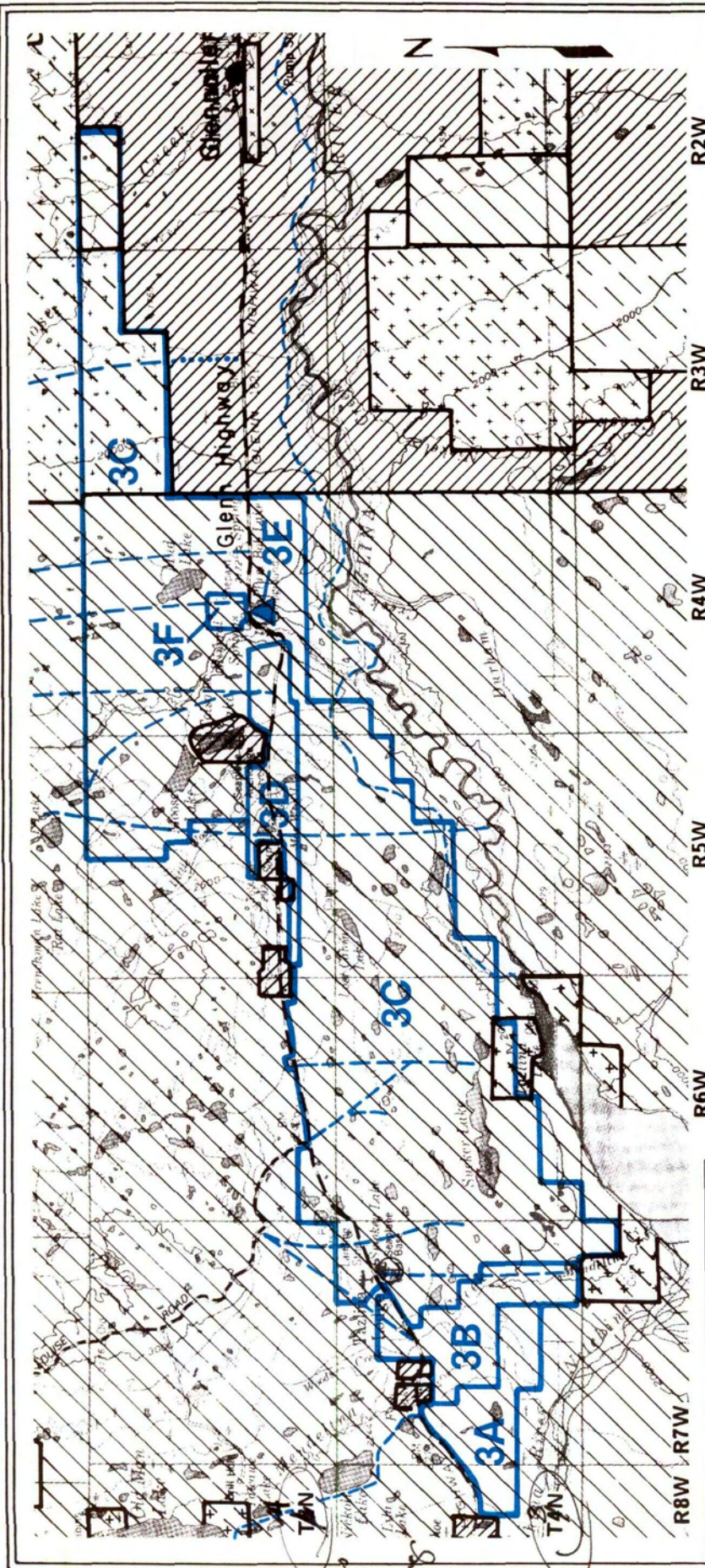

U.S.G.S. Quads:
Gulkana
Valdez
Map scale:
1:250,000

Location Map

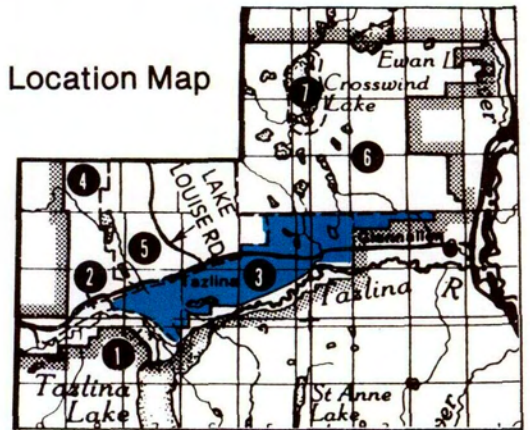

- State Owned
- State Selected
- Native/Private Owned
- Native Selected
- Federal
- Trails on public lands
- Public easements to state land - ANCSA 17(b)

Map shows approximate location of easements to state land and major trails across state land. Portions of trails may cross private lands. See appendix D.