

LEGEND

- New Diversion Ditch
- - - Extent of 20MT Material Placement
- ⊕ CPTs
- ⊙ BORINGS
- SRK 2012 BORINGS
- ⊙ AMEC 2000 BORINGS
- Shell
- Compacted Tailings
- Berm
- GPA Materials
- Flow-Through Drain

NOTES

1. Contour interval is 50ft.
2. Base contour data received from POGO mine site dated May 20, 2010.

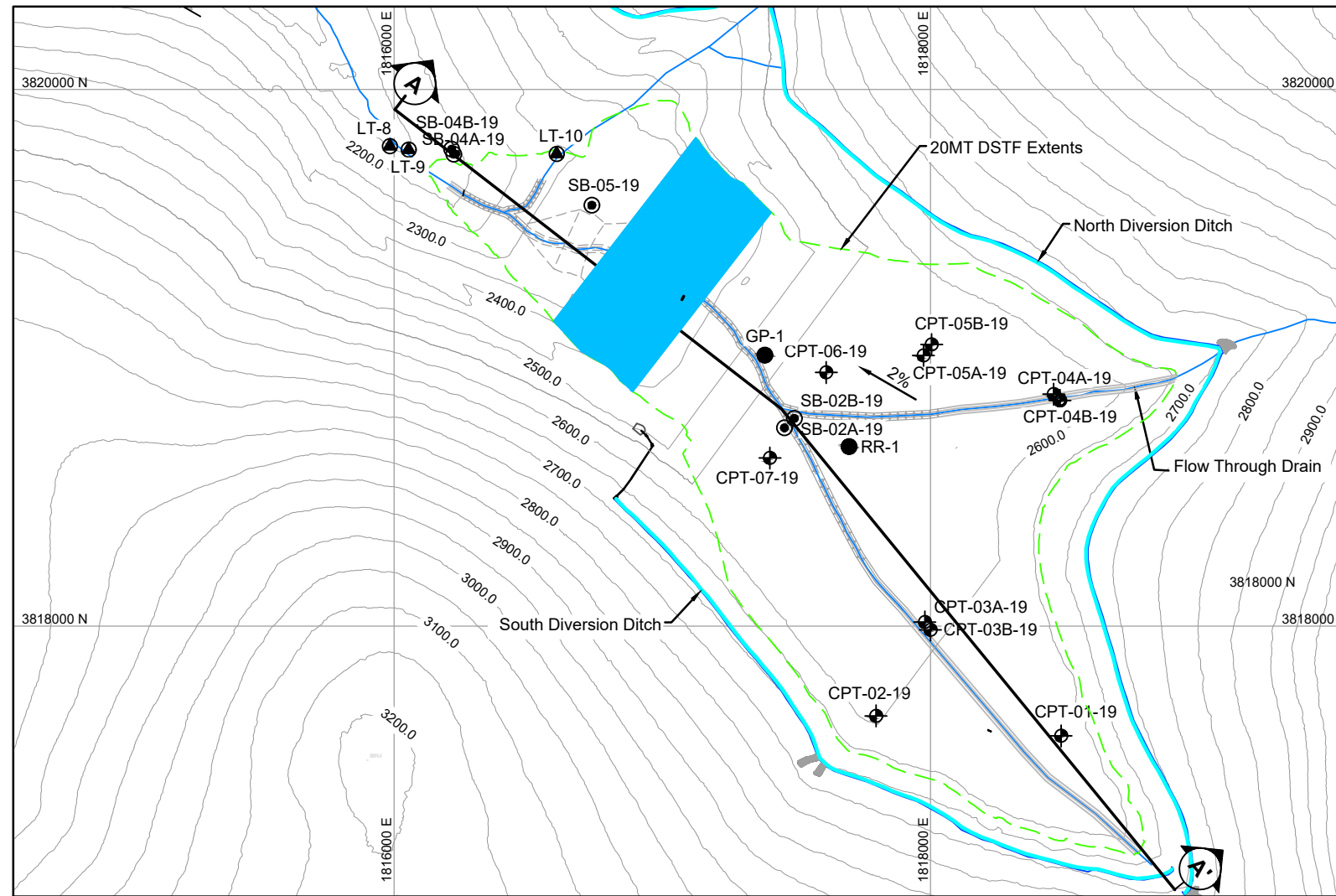

**PLAN VIEW
DRY STACK STORAGE AREA**

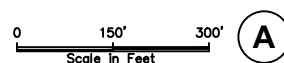
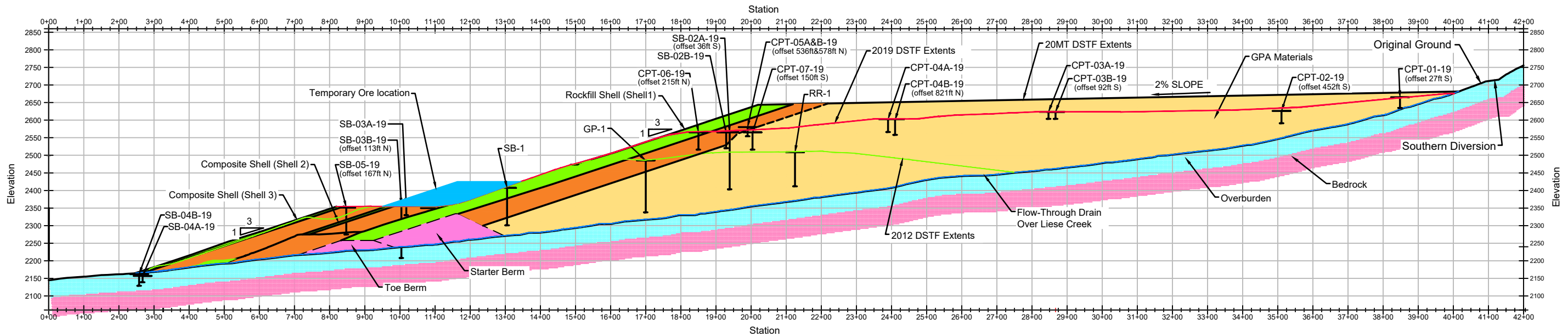
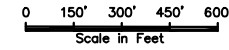

CROSS SECTION A - A'

AECOM
700 G Street, Suite 500
Anchorage, AK 99501, USA
www.aecom.com



FILE NAME: DSTF GEOTECH 20MT-1.dwg



Figure 6. Dry Stack Tailings Facility Low Grade Ore Placement

DATE: DEC 2019	APPROVED: MS	DRAWING: 04
-------------------	-----------------	----------------

D:\900_CAD_GIS\910_CAD_05-MODELS\DSTF GEOTECH 20MT-1.dwg